

FREEMAN X7

自由人



全球第一款可拆换电池的全金属防水强光运动音箱
THE WORLD'S FIRST WATERPROOF METAL SPEAKER WITH HIGHLIGHT & REPLACEABLE BATTERY

IMPORTANT NOTE

Freeman X7 is a multi-functional digital speaker powered by replaceable and removable rechargeable batteries. For use properly and safely, please kindly note those cautions. If there is any irregular operation cause any system failures or problems due to the neglect of the following cautions, the company is not responsible.

- > If MP3 functions can't work because of low power, please stop using lighting function and charge it immediately lest cause the permanent damages of Li-ion battery.
- > The surface of the product is prohibited exposure to certain chemical class of solvents, and will likely lead to the oxide layer of surface bleaching.
- > Freeman X7 falls from a height, may lead to the metal shell damage. Avoid fall on ground or hit something hard, avoid creating or injury.
- > The recommended environmental working temperature is 0°C ~ 40°C.
- > Freeman X7 is water resistance only. Please avoid immersing in water or operating in wet condition for a long time, which may cause system damage.
- > Freeman X7 design using flat head 18650 Li-ion rechargeable battery, suggest do not using pointed battery, please install the battery in the correct orientation.
- > Take off the battery if you do not use for a long time.
- > To obtain best performance, read this instruction manual carefully before using.
- > Speakers should keep away from the magnetic field.
- > Protect your eyes from glare light.
- > Children must use under the guidance of parents.
- > Do not take apart the speaker by yourself. It will damage the inner parts.
- > Do not disassemble, faulty operation is not covered by the warranty.
- Audio play function will be shutdown if the battery critical level
- If crash, lock up, or freeze, replace the battery again and recharge it with USB cable, the machine will be reset.
- If no sound, check if the volume is 0 or whether MP3 files are stored.
- If not working, check whether or not the battery was on backward, or low power, or lamp cap is tight or not.
- If sound distortion, check whether battery power is low and need charge.

KEY EXPLAIN

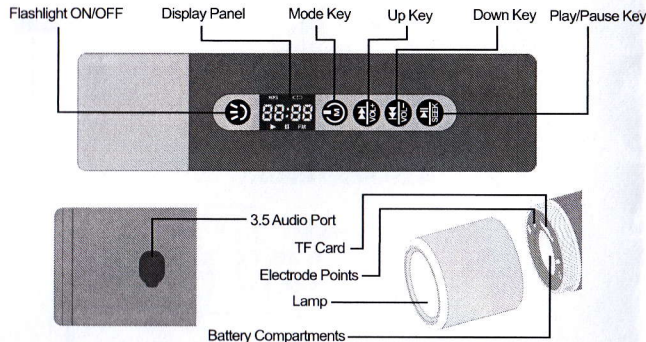

STATUS	MODE Key		UP Key		DOWN Key		PLAY/PAUSE Key	
	Single Press	Long Press	Single Press	Long Press	Single Press	Long Press	Single Press	Long Press
MP3 Music Play	Change Mode	On/Off	Previous Song	Volume Up	Next Song	Volume Down	Play/Pause	Void
FM Radio Play	Change Mode	On/Off	Previous Channel	Volume Up	Next Channel	Volume Down	Mute	Auto Search
Aux Connection	Change Mode	On/Off	Void	Volume Up	Volume Up	Volume Down	Mute	Void
Data Transfer	Quit	On/Off	Void	Void	Void	Void	Void	Void

Remark: Flashlight is separate operating system. Each push, High > Middle > Low > Slow Strobe > Fast Strobe > SOS > Off, switching cycle, long-press can turn off the flashlight at any status.

INPUT BATTERY

- Turn the lamp cap in an anticlockwise direction
- Insert 18650 battery correctly according to the picture. Input TF memory card. (Wrong battery direction cause you to be unable to turn on)
- Clockwise close the lamp cap tightly. (Not tight cause you to be unable to boot into the system)

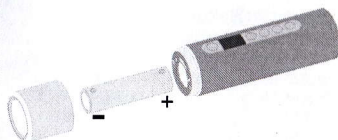

MP3 PLAY

- Long-press MODE key for 3 seconds, turn on X7. X7 will automatic recognize TF card and begin to play.
- Single-Press UP or down, select the song.
- Long-Press UP or down, setting the volume.

RADIO PLAY

- Long-press MODE key for 3 seconds, turn on X7.
- Insert audio cable into 3.5 audio port as radio antenna.
- Single-Press MODE key, change to FM mode.
- Long-Press PLAY key, radio channel automatically scan and store.
- When finished, Single-Press UP key or down key, choose the channel. Long-Press UP or down, setting the volume.

AUDIO CONNECTION

- Long-press MODE key for 3 seconds, turn on X7.
- Insert audio cable into 3.5 audio port, connect X7 with PC or Mobile.
- Single-Press MODE key, change to LINE mode.
- Display panel will show LINE words.



DATA TRANSFER

- Long-press MODE key for 3 seconds, turn on X7.
- Insert USB cable into audio port, connect X7 with PC or Mobile.
- Single-Press MODE key, change to PC mode.
- Display panel will show PC words.

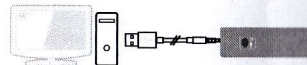

BATTERY CHARGING

- The button on the display panel will twinkle when low power, the battery should be replaced or need charging.
- Insert USB cable into 3.5 audio port, connect X7 with PC or USB mobile charger.
- Flashlight key will constant light while charging.
- When full charged, the light of flashlight key will go out.

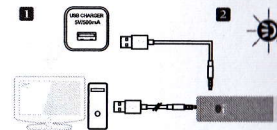

HARDWARE

Audio	Channel	Mono speaker
	Adjustable frequency	20 Hz ~ 20KHz
	Sound output	4 Ω/3W
	SNR	95 dB
Power	Battery	18650 rechargeable Li-ion battery
	Input	about 6 hours (2200mA / less than 5V/500mA)
	Memory	256MB-32GB TF card FAT32 files
USB Port	USB Device	USB High Speed
	Size	146mm * 37mm * 37mm
	Weight	340 g (no battery)
	Working Temp	0°C ~ 40°C
Information	CPU	Pentium III 500 MHz or higher
	OS	Windows Vista / XP / 2000 / ME
	USB port	Suggest 2.0 High Speed
	Files format	MP3 8-320kps
Music	Radio frequency	87.5 MHz ~ 108.0 MHz
	Play time	12-15 Hours (with 2200mA Battery)

ACCESSORIES

Machine ----- 1 SET
Bicycle Bracket ----- 1 PCS
Silicone Protective Casing ----- 1 PCS

Audio Cable ----- 1 SET
USB cable ----- 1 PCS
18650 Battery (Option) ----- 1 PCS