

# Contents

---

1.Function .....	1
2.Product Feature .....	1
3.Technical parameters .....	1
4.Product introduction .....	2
5.Device connection .....	3-6
6.PC OS setting .....	6-8
7.For example on Karaoke Software usage .....	9
8.Microphone usage .....	10
9.FAQ .....	10

## Function

1. Professional echo process, with professional-grade YAMAHA reverb chipset making a perfect blend between microphone voice and accompanying sound so that don't have voice and accompaniment separation any more
2. Professional echo effect can be adjusted depending on the occasion preference, making your voice with the magnetic, catch up with the KTV effect
3. Ordinary microphone or headset inserts to the computer directly, the singing voice is dry and with a large current noise, but K9W have the function of Noise reduction process, filtering the current sound, so can make the voice pure
4. Dual microphone interface, support the chorus, can adjust the microphone volume individually
5. Supported Iphone series phones, IPod, MID, DVD, HD player, Blue-ray DVD PC and other audio input.
6. Powerful software compatibility. full supported Skype, MSN, QQ, cool songs IK, YY, Bi-chat ,Karafun, Sunfly, Mike crazy, MVbox, K show, quack Ksong, and soon
7. Built-in wireless receiving module, can work with two wireless microphones at the same time

## Product Feature

- Stylish appearance, solid and reliable
- Imported top chipset, good sound quality, pure tone
- With PC/DVD/MID/Mobile phone and other audio input port, having a wide use.
- Match power settings, easy to use
- Stable performance , Working long time sustainably
- Dimensions: 175 \* 110 \* 40 (mm)

## Technical parameters

- Distortion: 1.8%MAX
- Frequency response: 40Hz---16KHz
- Working temperature: -30℃~65℃
- Working voltage: DC12V
- working hours: Unlimited (turn off the power when rest)

## Product introduction

### Description and connection guidance

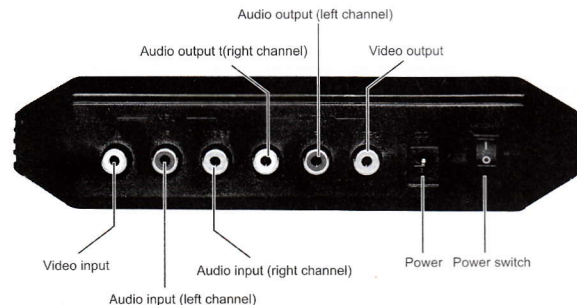
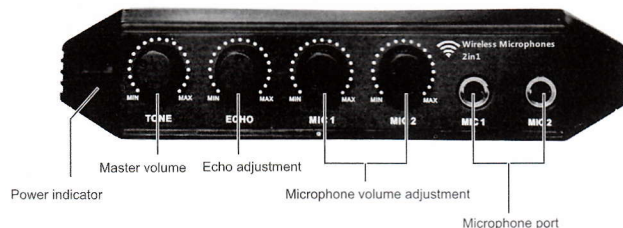

# Device connection

## 1.Connection with Computer (record status and sing on line)

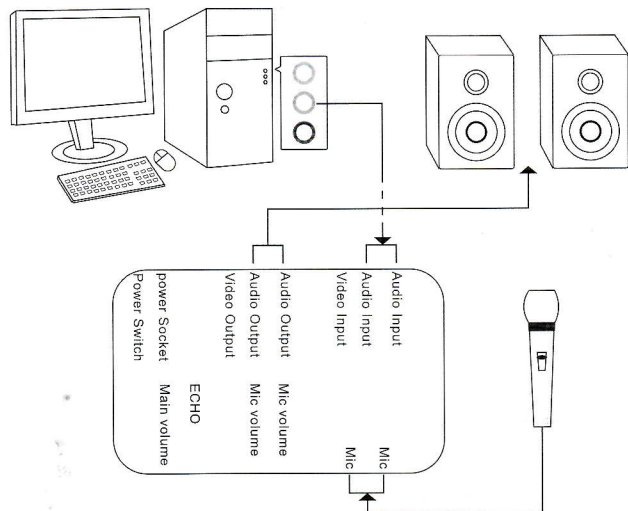

## 2.The other connection mode

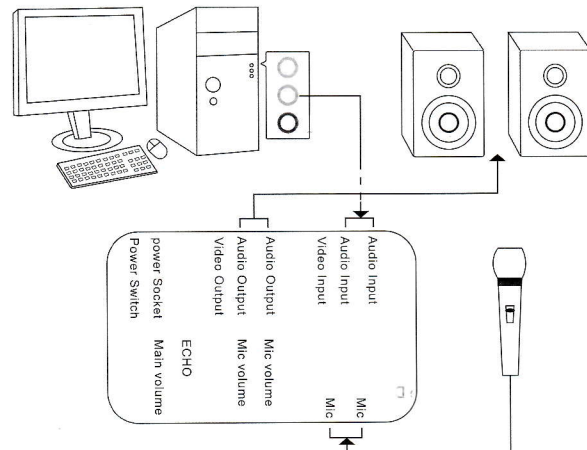

### 1 Recording mode(Desktop computer external headset, notebook is not required)

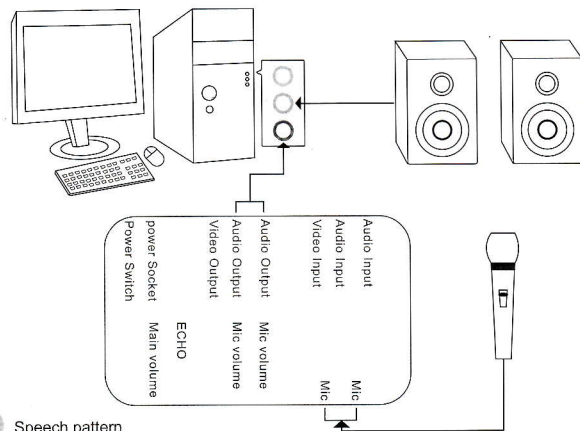

### 2 Speech pattern

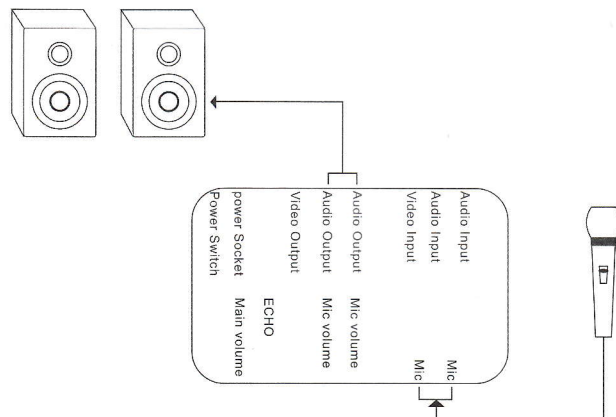
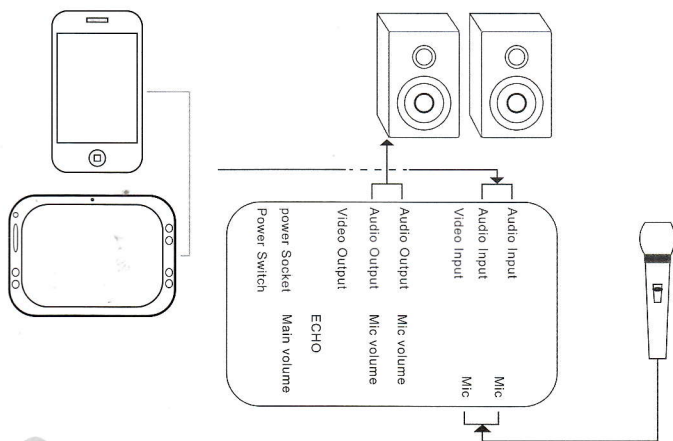
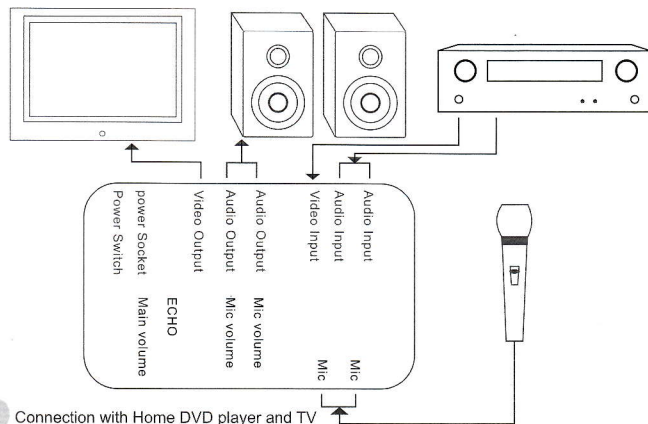

## PC OS setting

1> open the system volume control property.

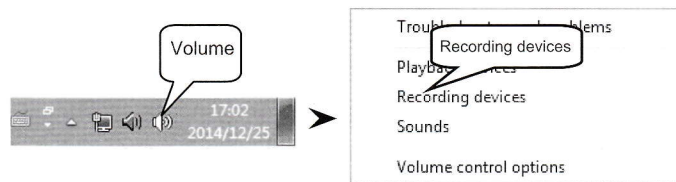

2> in the property ,bring up the microphone property.

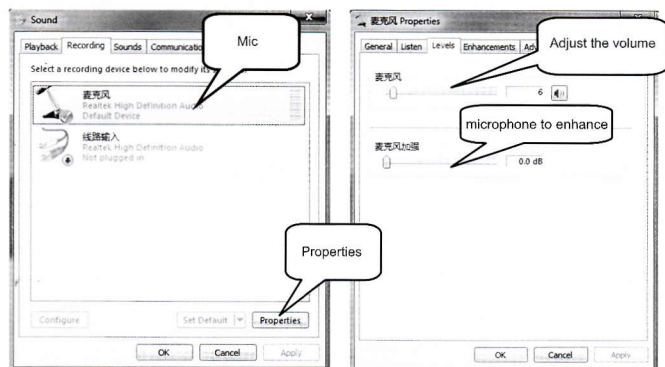

3> Disable microphone mute/ECHO

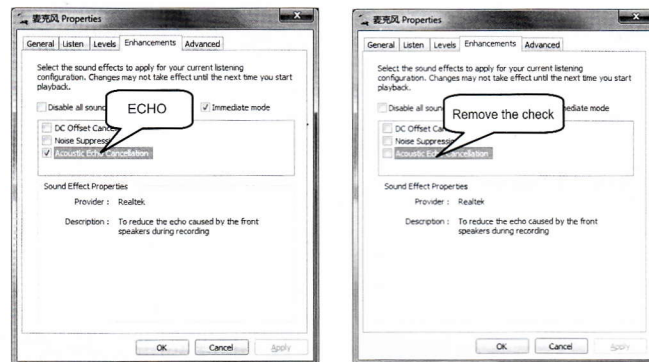
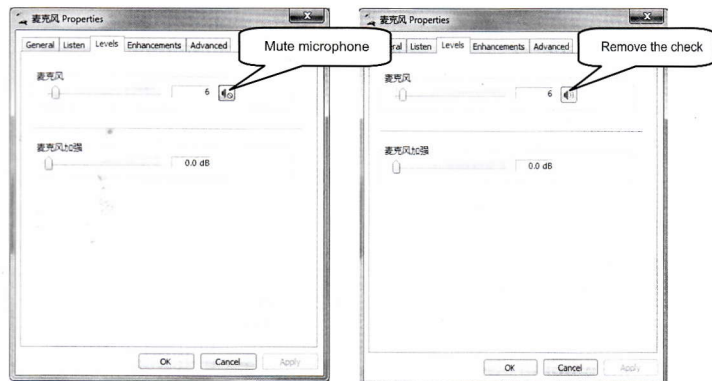

4> Adjust the microphone volume to the suitable level: (Note: Do not adjust the microphone volume too high, if the volume's too high, it will cause interference and current sound. If you think the sound is not big enough, you can lower the echo volume a little.)

5> The system audio setting When K9W is used for "voice chat" or "sing on line " or Record

K9W is a perfect voice input device, it can realize your voice chat easily. By K9W voice chat, the voice through network transmission, the sound is still clear. However, if you want to sing for your net friend by chat tools such as Skype or Karaoke software, you have to strive to set up your computer. Otherwise, the easy case is that friends just can hear your voice, but can't hear the musical accompaniment. You need turn on the record function in the volume property

#### NOTES:

1. when sing online or Record, "waveform" of audio properties is someone to hear your voice when sing online, the Wave" Does not adjust too high, often is in the last but one
2. Stereo Mix don't t adjust too high either, usually is in the last but one or two

## For example on Karaoke Software usage

karaoke software setting

Firstly, make debugging on the software , ensure it connects



setting the software ,enhance microphone and software microphone



## Microphone usage

Sing to yourself: microphone keeps 5 cm away from yourself

Recording songs: the microphone keeps 10-15 cm away from yourself

NOTES:

1. Using transformer, be aware of voltage connection
2. If long time doesn't use equipment, please turn off the power, remove the transformer.

## FAQ:

1. Turn on the power indicator does not light?  
Check the transformer if is OK
2. Power indicator light, but no sound?  
Set the computer volume control, cancel microphone mute
3. There is evident current?  
Check the circuit, remove the host-static, and release it
4. Evident harsh sound?  
Put the input device source volume down, change the placement angle between MIC and speaker, change distance between MIC and speaker.