

# **Power Case For SAMSUNG GALAXY S6**

## **User Manual**



**\* Please read this manual carefully before use**

## Specifications

Item	Spec
Input	DC5V-0.8A
Output	DC5V-0.8A
Charging time	3.5/5hours
Operation	0℃-45℃
Cell type	Polymer Lithium Battery

## Product Details:

- ▶ Designed for SAMSUNG, Make your phone special style.
- ▶ Cell Capacity: Original Polymer Lithium battery, Power your phone standby extend.
- ▶ Creative Design, Enjoy your phone without removing the power case.
- ▶ High class material to protect your phone, Charging and protecting 2in1.
- ▶ Integrated circuit design, effectively avoid shorting circuit or overcharge even under extreme conditions of wrong operating.
- ▶ With smart switching and precise power display, to extend the life of the built-in battery

## Instructions

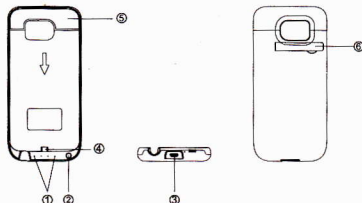

① 4 LED indicators

③ Micro USB input port

⑤ Top cover

② On/OFF key

④ Output

⑥ Slide stander

## How to use

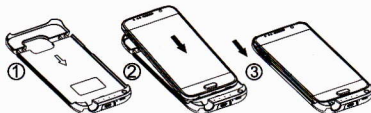

① Pull the top cover up

② Slide the phone tightly into the case

③ Pull down the top cover

## Accessories

- |                |    |
|----------------|----|
| 1. Power Case  | X1 |
| 2. User manual | X1 |

## Operating Guide

### ► Charging the power case

Connect the Micro USB cable with the power case, Then plug the USB to power adapter to charging, LED indicators are flashing

### ► Charging the phone

Put the mobile phone into the power case, press the switch key on bottom-left to charge the phone, When charging, the LED indicators are flashing, press again the switch key to stop charging.

### ► Charging both the power pack and phone

1. When charging the power case, put your phone into the case, press the switch key on the bottom-left, the phone will be charged firstly, Press the switch again to stop the phone charging priority.

## LED Indicators

Capacity	Charging the power case			
	LED1	LED2	LED3	LED4
< 25%	Flashing	OFF	OFF	OFF
25% -50%	ON	Flashing	OFF	OFF
50% -75%	ON	ON	Flashing	OFF
75%-100%	ON	ON	ON	Flashing
Charging the SAMSUNG				
Capacity	LED1	LED2	LED3	LED4
< 25%	Flashing	OFF	OFF	OFF
25% -50%	ON	Flashing	OFF	OFF
50% -75%	ON	ON	Flashing	OFF
75% -100%	ON	ON	ON	Flashing
Not Charging				
Capacity	LED1	LED2	LED3	LED4
< 25%	ON	OFF	OFF	OFF
25% -50%	ON	ON	OFF	OFF
50% -75%	ON	ON	ON	OFF
75% -100%	ON	ON	ON	ON
Charging both				
Capacity	LED1	LED2	LED3	LED4
SAMSUNG priority	ON	OFF	OFF	OFF

### ⚠ [ Caution ]



- Do not drop or bump, do not put it into the fire, hot temperature and water.
- Please use the proper charger or adapter for it, if have any deformities or corrosion, please stop using!

**Warning:** improper use may cause product damage and may harm yourself! keep it away from the child!