

# POVOS® 奔腾

PS3206/PS3208

电动剃须刀 Rechargeable Shaver

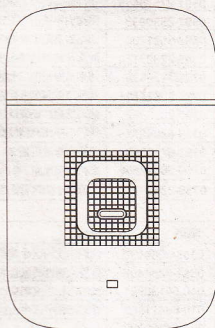

## Operating instructions 使用说明书

Before operating this unit, please read the instructions completely and save them.  
在使用前, 请仔细阅读此说明书并妥善保管。

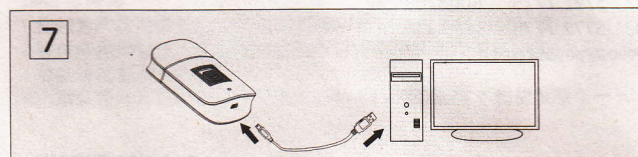
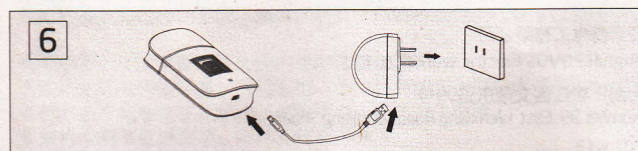
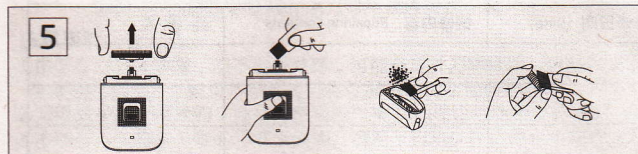
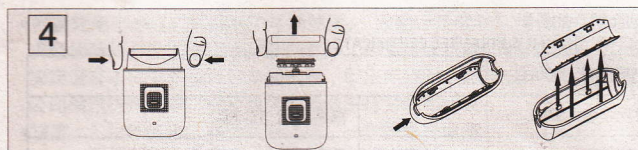

2

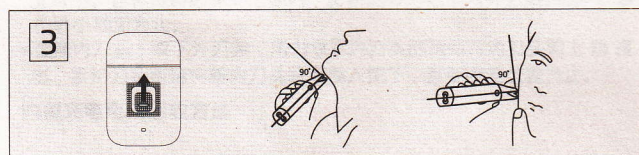
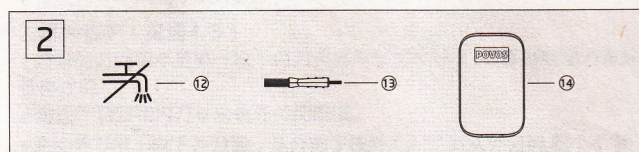
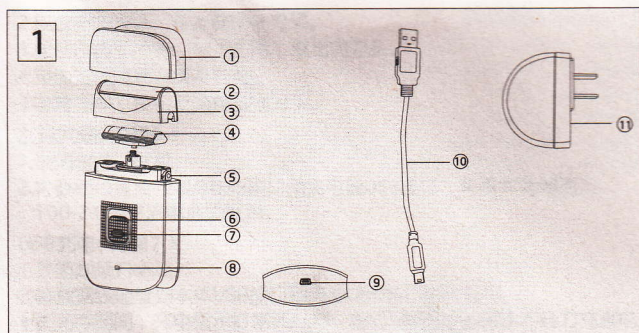

1

Thank you for purchasing POVOS electric shaver. Our products are designed to meet the highest standards of quality, functionality and design. We hope you enjoy your new POVOS shaver. Before operating this unit, please read these instruction completely, please keep the manual for handy reference.

### Before use

Your POVOS electric shaver requires a little time to get used to, because your skin and beard need about a month to adjust to any new shaving method.

### Parts identification(see fig.1/2)

- |                  |                             |                     |
|------------------|-----------------------------|---------------------|
| ① Protective cap | ⑤ Foil frame release button | ⑨ USB interface     |
| ② Outer foil     | ⑥ Switch                    | ⑩ Data line         |
| ③ Foil frame     | ⑦ Switch lock button        | ⑪ Adaptor           |
| ④ Inner cutter   | ⑧ Charging Indicator        | ⑫ Non-washable sign |
| ⑬ Cleaning brush | ⑭ Travel case               |                     |

### Using your shaver(see fig.3)

1. Remove the protective cap.
2. Switch the shaver on by pushing the switch upwards.
3. Hold the shaver at right angle(90°) to your skin. Start out shaving by applying gentle pressure to your face. Stretch your skin with your free hand, move the shaver back and forth in the direction of your beard. You may gently increase the amount of pressure as your skin becomes accustomed to this shaver. Applying excessive pressure does not provide a closer shave.
4. Switch the shaver off by pushing the switch downwards.
5. To prevent damage to the foil and inner cutter, replace the protective cap every time you are finished using the shaver.

### Cleaning and maintenance(see fig.4/5)

1. Switch off the shaver.

3



2. Push the foil frame release button and detach the foil frame as shown.
3. Grasp inner cutter firmly at each side, and pull straight up.
4. Clean away the clippings with the cleaning brush provided.
5. Reassemble the shaver parts in the reverse order.

#### **Charging (see fig.6)**

1. Please make sure that the power is off before charging.
2. Connect the USB interfaces of shaver and charger by data line, then plug into mains to recharge.

#### **USB charge (see fig.7)**

1. Please make sure that the power is off before charging.

- When charging, always a red light, you will be available eight hours with this shaver.
- If the shaver is charged more than 10 hours frequently, the battery capacity will be reduce.
- Do not operate this shaver when charging.

#### **The cutting system maintenance (see fig.4/5)**

1. It is recommended that you replace the outer foil at least every year and the Inner cutter at least every two years to maintain your shaver's cutting performance.
  2. Turn the shaver off before replacing the outer foil and the inner cutter.
- Replacing the outer foil : Squeeze the foil frame release buttons and lift the outer foil block upward to remove it. Remove the outer foil from the frame by slipping it off the hooks. Slip the foil into the frame with the plastic edge facing inward. Guide the plastic edges onto the hooks in the frame.
  - Replacing the inner cutter : Remove the outer foil block. Remove the inner cutter by grasping it firmly at both ends and pulling straight away from the

4

6

shaver. To insert the new inner cutter, hold the cutter at both ends and press downward until it snaps into the shaver.

#### **Recycling the battery (see fig.5)**

Batteries contain substances that may pollute the environment. The batteries in this shaver is not intended to be replaced by consumers. However, the batteries may be replaced at an authorized service center.

1. The procedure described below is intended only for removal of the rechargeable battery for the purpose of proper disposal.
2. Only in the battery completely exhausted before the battery removed.
3. Do not remove the battery after the shaver and power will be connected together.

#### **Caution**

1. The outer foil is very thin. If handled improperly, it can be easily damaged. To avoid personal injury, do not use the shaver if it has a damaged foil or inner cutter.
2. Both the foil and the blade have a limited service life. To keep a better result, we suggest you to replace the outer foil and the inner cutter at regular intervals.
3. This shaver is used only in dry condition. Clean the shaver's body by using a cloth dampened with soapy water.
4. Do not forget to close the shaver power to prevent shorten the batteries life.
5. If the shaver is not working properly, have it inspected by the dealer or an authorized service center.
6. Always use your shaver for its intended use, as described in this manual.
7. Please make sure that the old batteries are disposed of at an officially assigned location.
8. Do not leave this shaver within the reach of children.
9. Please keep the manual handy for reference.

5

#### **Guarantee & service**

1. We grant 30 months guarantee on the product commencing on the date of purchase.
  2. Within the guarantee period we will correct, free of charge, any defects in materials or workmanship, either by repairing or replacing the complete appliance as we may choose.
  3. To obtain service within the guarantee period, hand in or send the complete appliance with your sales receipt to an authorized POVOS Customer Service Centre.
- This guarantee does not cover:
- 1) damage due to improper use.
  - 2) normal wear or use as well as defects that have a negligible effect on the value or operation of the appliance.
  - 3) The guarantee becomes void if repairs are undertaken by unauthorized persons and if original povos parts are not used.

#### **Technical specifications**

Model No. : PS3206/PS3208

Power source : 100-240V~ 50/60Hz

Motor voltage : 1.2V==

Charging time : 8 hours

This product is intended for household use only, the unit is applied to the Chinese standard GB4706.1 appendix B, GB4706.9.

7