

Thank you for your choice SKG appliance. Please read the user manual before use.

# Multifunctional Steam Cleaner user manual

KB-2012



# SKG

## Important Safeguards

PLEASE READ CAREFULLY FAILURE TO FOLLOW INSTRUCTION WILL VOID YOUR WARRANTY.

READ ALL INSTRUCTIONS BEFORE USING CLEANER.

When using an electric appliance, basic precautions should always be followed, including the following:

### WARNING!

1. Verify that the main voltage indicated on the product corresponds with the voltage of your electrical outlet.

Rated voltage: 220V-240V~, 50/60Hz, 1500W

2. To provide continued protection against risk of electric shock, connect to properly grounded outlets only.

3. This product is designed for domestic use only.

4. Do not use outdoors.

5. Do not leave the unit unattended while plugged in. Unplug the electrical cord when not in use and before servicing.

6. Do not allow to be used as a toy. Close attention is necessary when used near children, pets or plants.

7. This appliance is not intended for use by persons (including children) with reduced physical, sensory or mental capabilities, or lack of experience and knowledge, unless they are under supervision or had instruction concerning use of the appliance by a person responsible for their safety.

8. Young children should be supervised to ensure that they do not play with the appliance.

9. Never direct steam towards people, animals or plants.

10. Do not immerse the unit into water or other liquids.

11. Do not use with damaged cord or plug. If the unit is not working as it should, has been dropped, damaged, left outdoors, or immersed in water, return it to the distributor. If the supply cord is damaged, it must be replaced by the manufacturer or a similarly qualified person to avoid hazard.

12. Do not pull or carry by the cord, use the cord as a handle, close a door on the cord, or pull the cord around sharp edges or corners. Keep the cord away from heated surfaces.

13. Never force the plug into an outlet.

14. Do not use extension cords or outlets with inadequate current carrying capacity.

15. Unplug after each use. To safely unplug, grasp the plug and gently pull, do not unplug by pulling on the cord.

16. Do not handle plug or unit with wet hands or operate without shoes.

17. Do not insert any objects into openings. Do not use with any opening blocked.

18. Do not use without floor cloth in place.

19. Do not use without water in the water tank.

20. When using on stairs use extra caution.

21. Store your unit indoors in a cool, dry area.

22. Keep your work area well lit.

23. Never put hot water or any other liquids such as aromatic, alcoholic, or detergent products into the unit water tank. This will make the operation unsafe and damage the unit.

24. Always keep the output for the steam clear. Avoid placing the steam opening on soft surfaces which may block the flow of steam.

Keep the openings free from lint, hair and other potential obstructions to ensure proper flow.

25. Use only as directed in this manual. Use only manufacturer's recommended accessories.

Use of attachments not provided or sold by the manufacturer or authorized resellers may cause fire, electric shock or injury.

26. The liquid or steam should not be directed towards equipment containing electrical components, such as the interior of ovens.

27. Do not expose to rain.

28. Stop using the Mop if there is leakage of water and contact a qualified technician.

29. Do not use the unit in enclosed spaces that are filled with flammable, explosive or toxic vapor such as paint thinner, oil-based paint or certain moth proofing substances.

30. Do not use on leather, wax polished furniture or floors, unsealed hardwood or unsealed parquet floors, synthetic fabrics, velvet or other delicate steam-sensitive materials.

31. Do not use for space heating purposes.

32. Unplug appliance from outlet before servicing.

33. Do not touch hot surface.

34. Do not let cord hang over edge of table or counter, or touch hot surfaces.

35. Do not place on or near a hot gas of electric burner, or in a heated oven.

36. To disconnect the unit, turn the power switch to "off" position, then remove plug from wall outlet.

37. Do not use appliance for other than intended use.

38. Care should be taken when using appliance due to emission of steam.

WARNING DANGER OF SCALDING!

HOUSEHOLD USE ONLY

Commercial use of this unit voids the manufacturer's warranty.

## Key Features

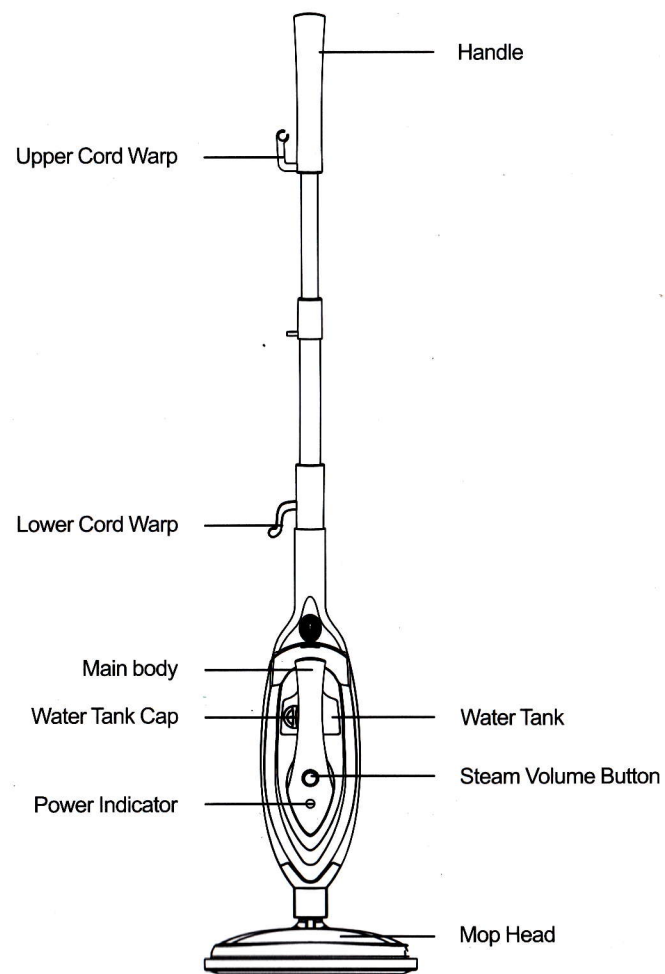

## Accessories

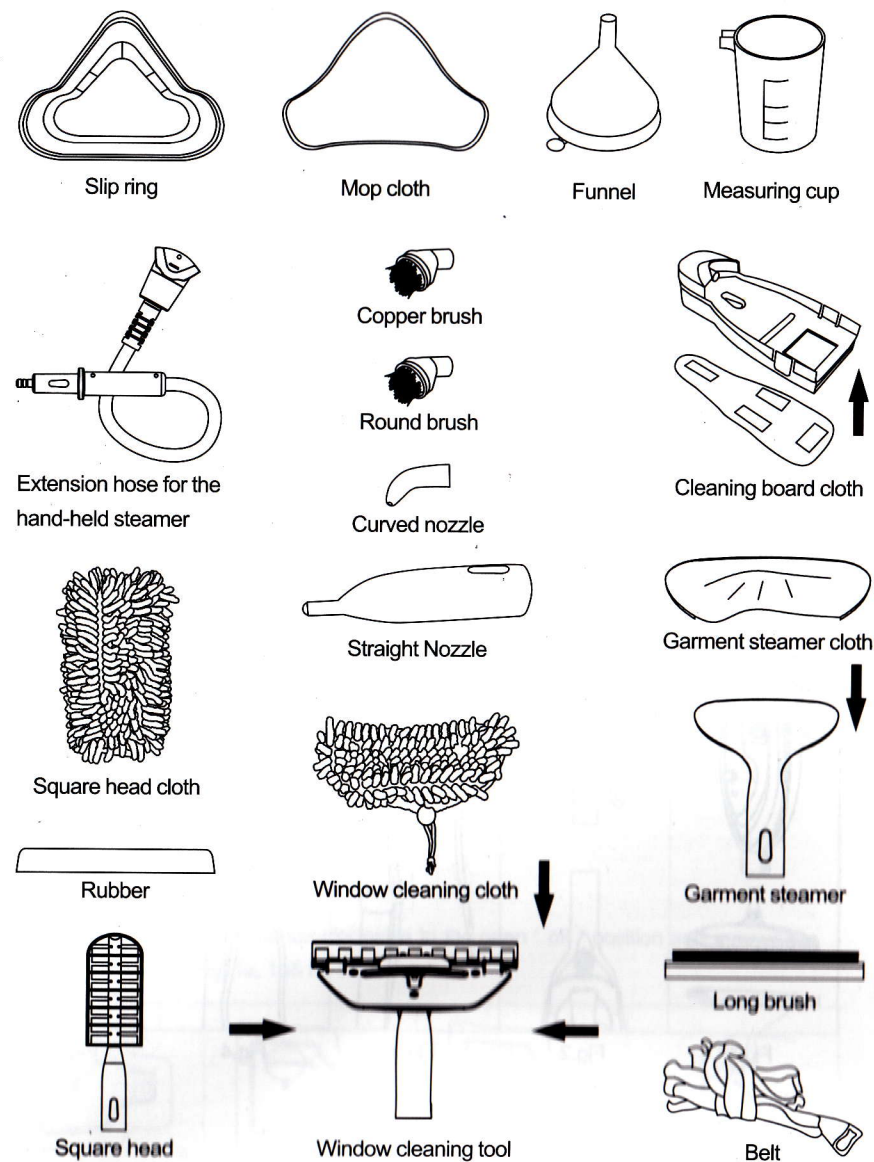



## How To Assemble The Steam Mop

### WARNING!

Please make sure that the unit is unplugged from an electrical outlet

1. Attach the mop head to the main body as follows: insert the swivel joint into designated hole in the main body, and then use the screw to fix well. Make sure that the mop head is securely locked in place before usage. (Fig. 1)
2. Insert the extension handle into the designated opening in the main body until it gets locked in place by the extension handle lock button. (Fig.2)
3. Insert the power supply cord into the cord holder located at the top of the extension handle as illustrated in Fig. 3 and then insert to power supply cord into the upper cord wrap as illustrated in Fig. 4.
4. Place the microfiber cloth on the bottom of the mop head and make sure all the loops on the cloth are aligned with the gripping hooks on the bottom of the mop head (Refer to Fig. 5), then press the cloth against the mop head so the loops on the cloth catch the gripping strips on the mop head and hold the pieces together.
5. When clean carpet, cover cloth on mop head, then put on slip ring.

### NOTICE:

Never use the carpet glider on surfaces that are prone to scratching.

### Caution:

Never assemble or remove the accessories while the unit is in operation.

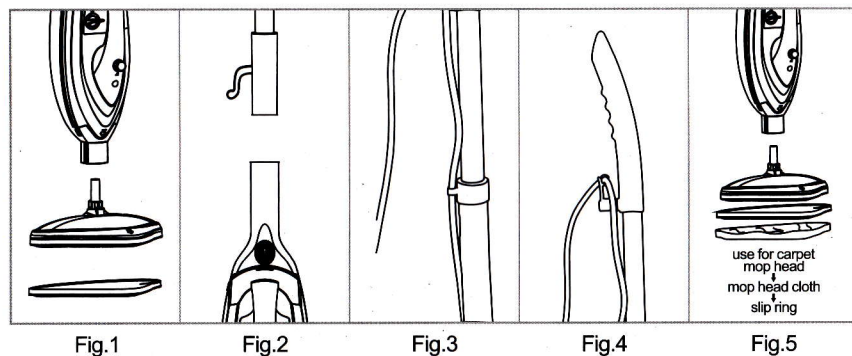

Fig.1

Fig.2

Fig.3

Fig.4

Fig.5

## How To Use The Steam Mop Please Read Before Use

The unit is designed to thoroughly clean floor surfaces, such as marble, ceramic, carpet, stone, linoleum, sealed hardwood floor and parquet. Not all floors types are suitable for steam cleaning.

On surfaces that have been treated with wax, the wax may be removed by the heat and steam action. Do not use on unsealed flooring or let unit stand on any wood or heat sensitive floor for an extended period of time. This could cause the wood grain to rise.

When using on vinyl, linoleum or any other heat sensitive floors, use extra caution. Too much heat can melt down glue in the flooring. When using the appliance on laminated floor, the laminated floor should have been laid professionally and not have any gaps or cracks in which humidity could enter.

Test the unit on a small isolated area of your flooring prior to over- all use on any floor surface.

Always check the use and care instructions of your flooring manufacturer before using the unit.

If any doubt, please consult a specialist. Only use the carpet glider on carpeting & rugs. Use of the carpet glider on other floor surfaces will cause streaking and can possibly scratch the surface.

Fill the water tank with water.

Make sure that the unit is unplugged.

Turn the water tank cap counter-clockwise to the open " off " position and remove the cap as illustrated in Fig. 1a, 1b&1c, 1d.

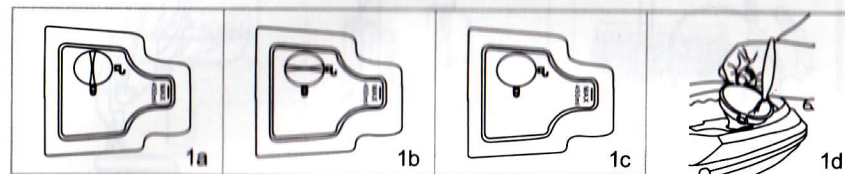

1a

1b

1c

1d

Hold the mop at a 45 angle as illustrated in fig.1d, and add water in the tank up to the MAX level by using the measuring cup. Do not overfill. The maximum tank capacity is 450ml.

#### Replace Water

Turn water tank cap clockwise approximately 90 to the "CLOSE" position until the cap is tightened securely.

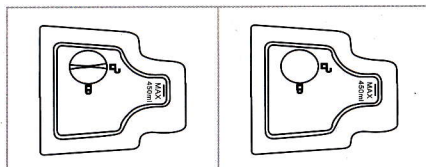

### Hand-held Steamer

The Hand-Held Steamer is an ideal portable cleaner. It is there for you to detach and use on work surfaces kitchen, countertops, sinks, bathrooms, windows, mirrors, tiles and spot cleaning on floor carpets and rugs. Use it with an attachment - Jet Nozzle or Nylon brush to spray away dirt, grease, mold and more.

### How To Take Off The Hand-held Steamer

Make sure that the unit is unplugged

1. Remove the power supply cord from the upper cord wrap and cord holder, turn the lower cord wrap to release the cord and remove the power supply cord from its channel. As illustrated in Fig. 1a & 1b.
2. Unlock the button on the extension hose, And take out the hand-held steamer. As illustrated in Fig. 2.

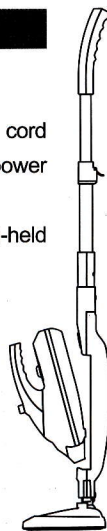
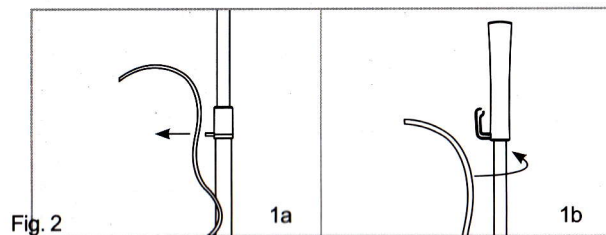

### How To Assemble The Accessories

1. Insert the designated end of the extension hose into designated hole in the main unit (as illustrated in Fig. 1a, 1 b & 1c). As illustrated in fig. 1a, 1b, 1c. make sure that extension hose is securely locked into place before usage.

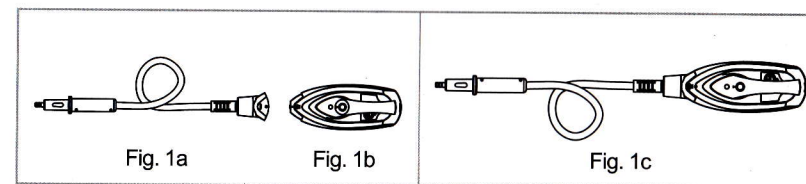

The installation of strap:

The installation of strap: Cover belt on the position of 2a and extend to the position of 2b, then attached the velcro on the position of 2c.

Finally adjust the long of belt.

Open the velcro and pull off the belt.

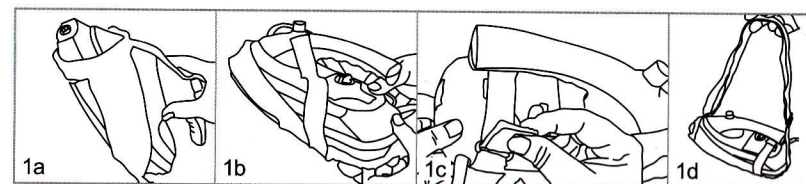

Window Cleaning Tool

2. Loosen up the drawstring on the coral cloth and install the coral cloth onto the designated hooks on the window cleaning tool frame and pull up the drawstring to secure the coral cloth in place.

NOTE: Do not cover the squeegee blade. Make sure to hook up the coral cloth to all hooks on the cleaning tool frame so it doesn't slip or fall from the frame during use (as illustrated in Fig. 2a, 2b & 2c).

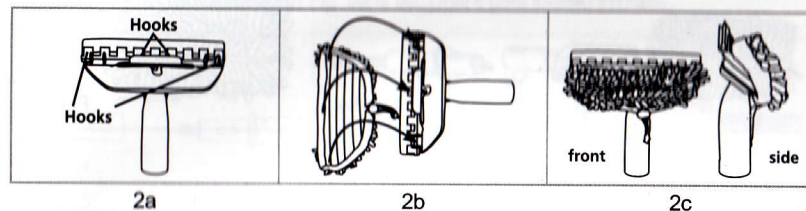



3. Attach the window cleaning tool to the extension hose as follows: aligning the lock button on the extension hose with the designated hole on the window cleaning tool frame and the push in the extension hose until its locks in place (as illustrated in Fig.3a & 3b)

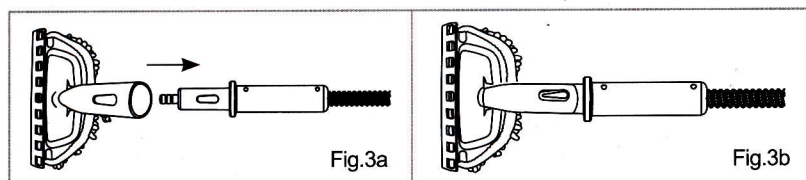

#### GARMENT STEAMER

4. Garment steamer. Install the microfiber cloth or the lint cloth over the garment steamer tool (as illustrated in Fig. 4a, 4b & 4c).

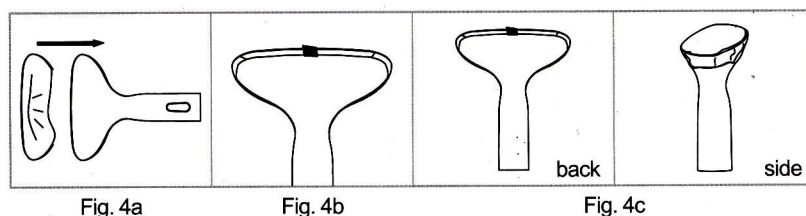

5. Attach garment steamer to the extension pipe as follows: Aligning the lock button on the extension hose with the designated hole on the garment steaming tool frame and then push the extension hose until it locks in place (as illustrated in Fig. 5a)

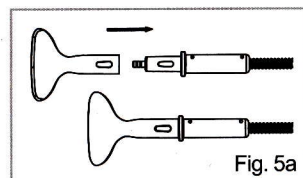

#### Square head cleaning

6. Install the square head cloth onto the square head frame (as illustrated in Fig. 6a & 6b)

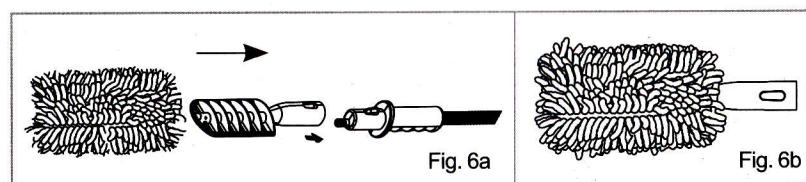

7. Attach the square head frame to the extension hose as follows: Aligning the lock button on the extension hose with the designated hole on the square head frame and then push in the extension hose until it locks in place (as illustrated in Fig. 7a & 7b).

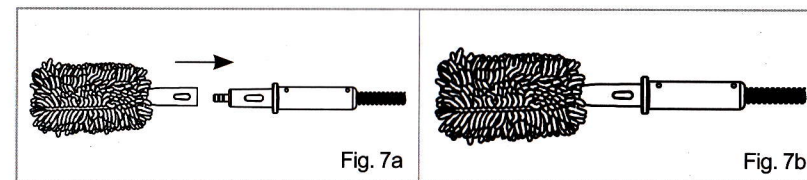

#### Cleaning board

8. Attached the main steamer to the square brush, until it locks in place (as illustrated in Fig. 8a & 8b), then place the square cloth on the bottom of square head and make sure all the loops on the cloth are aligned with the gripping hooks on the bottom of square head (Refer to Fig. 8c).

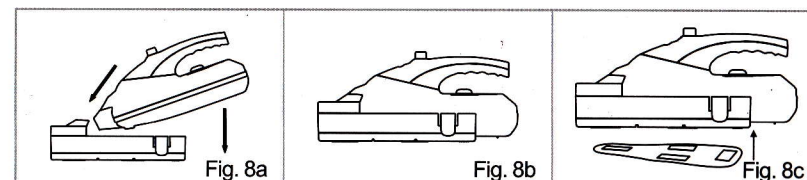

#### Cleaning board

8. Attached the main steamer to the square brush, until it locks in place (as illustrated in Fig. 8a & 8b), then place the square cloth on the bottom of square head and make sure all the loops on the cloth are aligned with the gripping hooks on the bottom of square head (Refer to Fig. 8c).

Note: Press the two buttons on cleaning board to attached the main steamer

#### Straight Nozzle

9. To attach the straight nozzle: Insert the straight nozzle into designated hole in the extension hose, as illustrated in Fig. 9a & 9b. Until it gets locked in place.

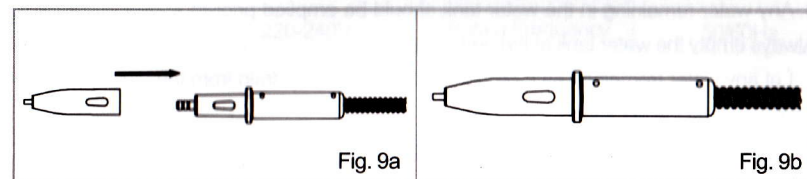

### Round Brush

10. Attach the round brush by screwing it onto the straight nozzle that connected to the extension hose, as illustrated in Fig. 10a & 10b.

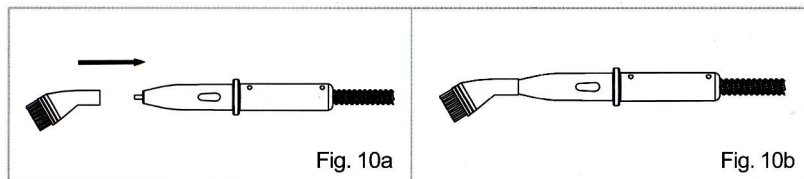

### Bend Nozzle

11. Attach the bend nozzle by screwing it onto the straight nozzle that connected to the extension hose, as illustrated in Fig. 11a & 11b.

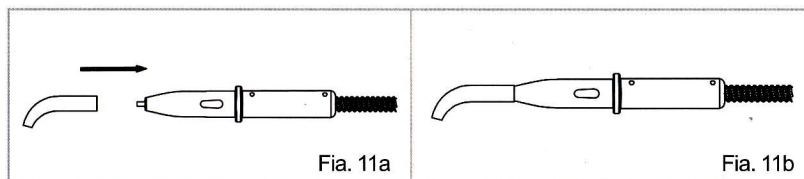

### Note:

1. After assembly each accessories, add water in the tank up to the MAX level by using the measuring cup.
2. Turn the knob of the water tank in " LOCK " diagram position, then you can open the power switch (Min to Max), choose steam flow from " MIN " to " MAX ".

## After Use

1. Unplug power cord from outlet
2. Allow mop pad to cool down and carefully remove cleaning cloth from mop head, as cleaning cloth could still be hot.
3. Any water remaining in the water tank should be emptied prior to appliance storage. Always empty the water tank at the end of each use.
4. Let any water (remained as a product of condensation) drain from the steam opening prior to storing the appliance.
5. Wrap power cord around upper and lower cord wrap.

6. Wipe all surfaces of the unit with a soft cloth. Store in a protected dry area.

7. Please store the unit in a cool and dry place when not in use. Do not leave it exposed to sunlight or rain.

8. Upright storage of the unit with a wet mop pad may result in the formation of white marks on your floor. To remove the white marks, clean area with vinegar. Make sure to remove the mop pad before storage.

## Cleaning And Maintenance

BE SURE THAT THE UNIT IS DISCONNECTED FROM THE POWER OUTLET WHEN PERFORMING CLEANING.

Drain the remaining water in the tank and clean it after every use. Please use detergent to clean the accessories (Jet Nozzle and Round Brush) when they are dirty, then wash them with clean water and dry them in air.

### How to decalcify the water tank interior:

To clean calcium deposits that build up inside the water tank, add one or two tablespoons of white vinegar to a full water tank, close the water tank cap and shake the contents. DO NOT TURN THE STEAMER ON. Let it sit for a few hours. Then, empty the water tank and refill with clean water and empty until it rinses clear.

### WARNING!

DO NOT IMMERSE UNIT IN WATER.

## Technical Parameters

Model	KB-2012	Rating Power	1500W
Rating Voltage	220-240Vac	Rating Frequency	50/60Hz



## Cleaning Procedure To Remove Limescale

If your unit begins to produce steam more slowly than usual or stops producing steam you may need to remove lime scale. Lime scale can develop over time on the metal parts and greatly affect the mop performance. We recommend removing lime scale on a regular basis, at least once a month, especially in areas with hard water. The frequency of lime scale removal depends upon the hardness of your tap water and how often you use the steam mop. The unit uses tap water. however, in areas with hard.

To remove lime scale from the unit please follow these procedures

By using cleaning solution

1. Prepare a solution of 1/3 white vinegar and 2/3 tap water and add to the water tank.
2. Secure and position the unit to ensure steam released is aimed away from the floor or surrounding objects and surfaces. Plug the unit in, turn the unit ON by pressing the power switch and allow the unit to produce steam until the vinegar/water solution is used up.
3. Repeat the above procedure as many times as necessary until a normal steam flow rate is achieved.
4. Fill the water tank with fresh water and rinse out
5. Fill the water tank with fresh water, attach to the unit and release steam through the system until the water tanks is empty.

## Troubleshooting Guide

### WARNING!

TO REDUCE THE RISK OF FIRE, ELECTRIC SHOCK OR INJURY, UNPLUG APPLIANCE FROM OUTLET BEFORE SERVICING.

Problem	Possible cause	Solution
THE UNIT DOES NOT POWER ON	The unit is not plugged in Or turned ON.	Make sure the unit is plugged into a proper outlet and the switch is ON.
REDUCED STEAM OR NO STEAM	Water tank empty.	Fill water tank.
	Blocked steam nozzle.	Remove mop head and Clean the nozzle.
	Limescale deposit.	Follow cleaning procedure to remove lime scale in this user's guide to remove lime scale.
STEAM ESCAPES FROM CONNECTIONS	Attachment is not connected properly.	Turn the unit OFF, allow it to cool down, disconnect the accessories and reattach them properly.
	Debris or obstructions at the connection points.	Remove the accessory and check and clean connection points.
THE CLEANING CLOTH THE CLOTH GETS SATURATED BECOMES WET	The cloth gets saturated with water.	Remove wet cloth and replace with a new cleaning cloth or allow cloth to cool, then wring out and reattach.