



FULL HD

12 MEGA PIXELS PHOTOGRAPH

360° ROTATION CAR USE MINI CAMCORDER

USER MANUAL

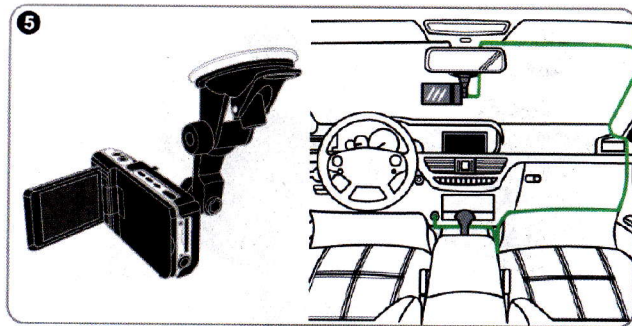
**Preface:**

Thank you for purchasing this high-definition digital video camcorder, with mini refined appearance and a unique flip-screen feature that can match up the multi-function to achieve a wide-angle photography.

The user manual introduces the method of usage in detail, at the same time it also provides detailed information to you, including the usage, operation, installation considerations and technical specifications. Please carefully read and fully understand this user manual before your use the camcorder and keep it handy for future reference. We hope this camcorder can satisfy your need and make a service for you in a long term.

Product Overview:

This subminiature high-definition digital video camcorder is aimed at the market demand, with many leading functions as high-definition digital video recorder, photograph, high-speed USB data transmission and, USB charging.

Having a wide range of use and being convenient to video anytime, anywhere.

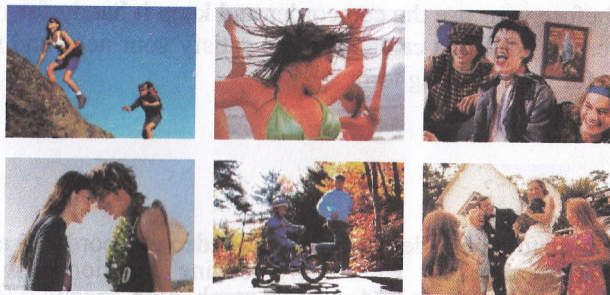

Protect Feature

- ◆ Minute Size, a perfect modular design of bug-eye lens with 180-degree rotary tape and A+ high-resolution of 130-degree, and the display screen of 270-degree rotary tape is more convenient to capture and record the high-resolution videos from a wide angle in various occasions.
- ◆ Built-in 1/3.2 inch sensitivity mode with low noise and high definition that can shoot in dimly lit places.
- ◆ Switching from Day to night mode function
- ◆ Automatic exposure control function
- ◆ Built-in lithium battery, support the function charging and recording at the same time.
- ◆ Built-in microphone
- ◆ support for the SD (SDHC) card with high power capability
- ◆ Self-timer can preview by the screen to capture the ideal image
- ◆ Anti-shake function
- ◆ motion detection recording
- ◆ 4X digital zoom
- ◆ a TV / HDMI interface can be directly connected with the high-definition television

Protect Mix:

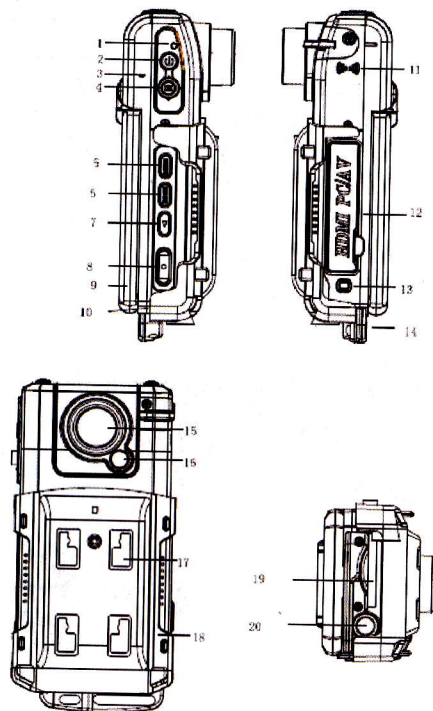

1. LED monitor,
2. Power button,
3. Microphone port,
4. Five direction button: up button (Macro), down button (zoom), left button (EV button), right button (flash compensation),
5. Menu button,
6. Mode button,
7. Playback button,
8. Video and camera button,
9. Display,
10. Grip belt hook,
11. Speaker,
12. HDMI interface, USB interface, TV interface,
13. Reset button
14. Bracket 1,
15. Lens,
16. Flash compensation,
17. The battery cover (blow the bracket 2),
18. Bracket 2,
19. SD card slot,
20. Tripod fixed end.

Installation

Loading and downloading the battery.

1. Turn the battery cover knob toward the mark to open the cover.
2. Insert the battery, and make sure that the plus-minus markings on the battery match those on the camcorder.
3. The battery level display shows the amount of battery power remaining in the battery, and the reference is as follows.



Fully charged



not fully charged



low power

4. Shove the battery cover to remove the battery.

Charging the Battery

1. To charge by directly linking the socket to the camcorder USB interface or turn the power off.
2. USB charger, putting one of USB data cable connected to the computer and the other end with camcorder or you can turn the power off.

The installation and removing of the SD memory card

1. Insert the SD memory card in the SD slot according to the

indicative direction, until it softly clicks.

2. When removing the SD memory card, push in the SD memory card and gently release to eject it.

Notes:



1. Make sure the switch of SD memory card is open.
2. Make sure the SD memory card are facing the right way, if it is in the wrong direction, it may damage the camera and SD memory card.
3. When you insert the SD memory card into the camcorder, which will set the SD memory card as the storage devices, the original data in the SD memory card may not be read.
4. If the SD memory card is incompatible with the camcorder, please try again or change other SD memory.
5. Please use the high-speed SD memory card, as the SDHC cards.

User Guide

Turning the power on/off

1. Press the power button about one second to turn the power on or off.
2. Open the screen to turn the power on while closing it to turn off the power.

Switching the operation mode

1. Press the mode button to switch the video and photography mode,  is the recording mode, and  is photography mode,

they are marked on the top left corner of the screen

2. Press playback button to enter into the playback.

How to enter into the systematic setting options

Press the MENU button twice to enter into the "System Settings" option, then it becomes the blue background.

Date / Time: set the date and time;

Auto Shutdown: set automatic shutdown time ;

Beep Sound: turn on and off the sound of the buttons;

Language: set the used language menu;

Frequency: set 50Hz/60Hz current frequency



TV mode: Set the NTSC / PAL;

Default: recover the factory settings;

Version: Software version number

How to shoot and the setting of shooting options

1. Shooting

When the camcorder enters into the recording vided mode and a mark like  appears on the left of the screen, press the camera button to start recording video, the  recording indicator will flash. When you press the camera button, the recording will stop and the  recording indicator will disappear.

2. Selection of the white led

Under the recording mode, press the left button, you can use the switching function between day and night mode. The night mode is turning on white led with the indicator on the left bottom of the screen.

3. Setting of the recording options

Press the MENU button to enter into the recording option setting

Resolution: 1080p/720p/480p

Loop recording: 5 minutes/10 minutes/ 15 minutes

Motion detection: on/off

Date stamp: on/off

How to take photos and photos option settings

1. Turn the power on, press the mode button to select the photo mode, then the mark "" will appear at the top left, at the time, the camcorder enter into the photo mode.

2. Aim and focus as shown in the illustration and adjust the camcorder to the ideal aperture, at the time, you need to grip the camcorder tightly to prevent from shacking.

3. Press the photo button, and then the camera will make a "crack" sound, which means a photo is completed.

4. Self-timer function

In photo mode, press the Menu button to select the self-timer

mode as single shot, two seconds timing, five seconds timing, ten seconds timing and continuous shooting.

5. Press the MENU button to enter into the photo selection setting. Capture mode: single shot, timing with (two sec./five sec./, ten sec.) and continuous capture.

Resolution: 12M/8M/5M/3M

Quality: super fine, fine and normal

Sharpness: strong, normal and soft

White balance: auto/daylight/cloudy/tungsten/fluorescent

Color: normal/black-white/sepia

ISO: auto/100/200/400;

EV:-2.0 - +2.0

Face detection: face detection / smile detection

Anti-shaking: off/ on

Quick review: shut/ 2s/5s

Date stamp: date/time

Notes:

1. In any mode of recording and photo, you can press the mode button to select the mode of cycling switching the recording and photography.
2. In the photo mode, press the right button enter into the white led function and the left button can quick change the set EV number.

Playing Back Mode

1. After the camcorder open the procedure and enter into the recording mode, press the playback button to the single playback mode, you can press the left or right button to review the audio and video data.

2. Press the bottom button to the index mode and press the four-direction button, you can preview pictures and video data. Then press the OK button to the single mode to operate with the picture video data. "📺"mark appears on the up left of the screen means the video data, if you want to play audio and video data, you can press OK button to play or pause. During the playing process, press left button to rewind, right button to fast forward, up button to increase the volume and bottom button to decrease the volume. "🖼️"mark means the picture file, pressing the up button can enlarge the picture, then press the OK button to the mobile mode, using the four-direction button to move around the picture. And then press the OK button to exit the mobile mode, press the zoom button to shrink the picture.

3. Delete the files

In playback mode, press the Menu button, you can see the delete and formatting options, press the bottom button to display the file you want to delete, and then press the right button to choose the options of delete the current file of delete all. At last, press OK

button to confirm.

Recording while Charging Mode

Connecting one end of the USB interface to the socket, the camcorder will enter into the recording while charging mode when it is open.

Screen Rolling

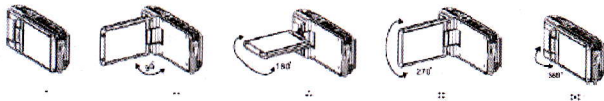

Information Backup

USB Backup Mode

Firstly, connect the camcorder with the computer by USB cable, and then press the power button, it will appear a picture as followings, select the storage and press OK button. Lastly, open the icon of My Document on the desktop, a movable disk will appear, and find the needed picture from the DCIM document in the movable disk



Memory
PictBridge
Camera



Remarks:

1. Computer operating system: above the Windows 2000/XP/Vista/Windows 7, MAC OS x 10.3.6 above
2. Select the camera to use it.
3. Select PictBridge to connect with the printer to print pictures.
4. Removing the USB to power the camcorder off

Connect to the TV to display videos

1. Use the HDMI cable to connect with the high quality TV to play back.
2. Use the TV cable to connect the TV to recording, taking a picture and browse the picture and video data.

Note: The removable disk can be used without the installer driver, when the camcorder is open.

Remarks: Suppose the camcorder is in dead halt due to the improper operation, you can press the reset button to boot the machine, which will return to normal!

Technical Specifications

LCD screen	2.5LTPS(4:3)
Camera lens	130 degrees A + level degrees high resolution lens
Language	English ,Germany, French, Spanish, Italic, Portugal, TC, SC, Japanese, Russian
video	1080p/720p/480p
Video format	AVI
Resolution r	12M/8M/5M/3M
Photos format	JPG
SD card slot	SD
Microphone	Built-in
Capture mode	Single/self-timer (two seconds timer, five seconds timer, ten seconds timer,) and sequence
Frequency	50Hz/60Hz
Television	NTSC/PAL
USB interface	USB2.0

Power	5V 500MA
Battery	use the BL-5C battery
System	Windows 2000/XP/Vista/Windows 7, MAC OS x 10.3.6 above

Notes: This product retained design and specification change without notice.

Specification of Rack Mounting

Installation Steps

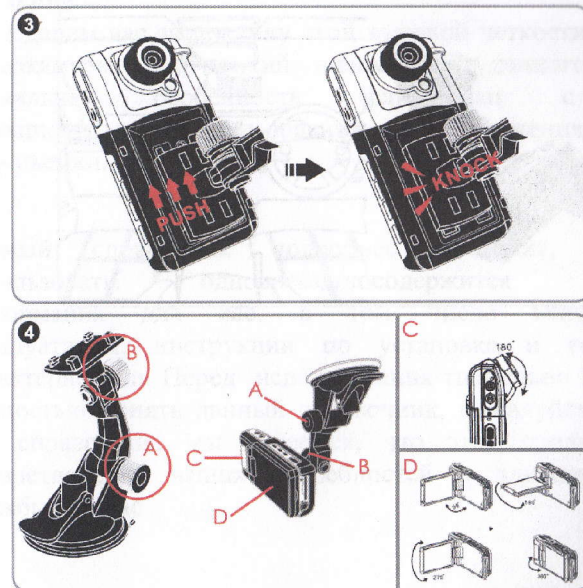
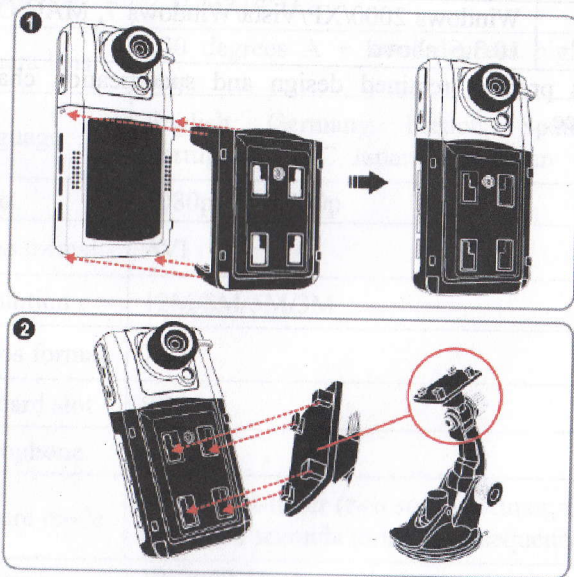

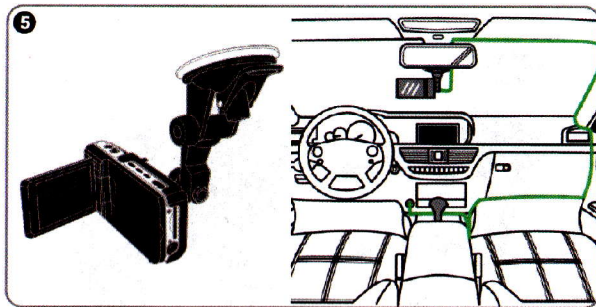

Введение

Благодарим вас за покупку этой высокой четкости цифровой видеокамеры, мини-тонкий внешний вид данного продукта, уникальная особенность флип-экран с многофункционального использования, для достижения широкого угла съемки.

Данный справочник подробнее объяснит, что как использовать. одновременно содержится подробная информация для вас, в том числе использования, эксплуатации, инструкции по установке и технические характеристики. Перед использования тщательно прочитал и полностью понять данный справочник, пожалуйста, храните это справочник, мы надеемся, что этот продукт может удовлетворения ваших потребностей и длительный срок службы для вас.