

OPERATION INSTRUCTIONS

DVD-MP4 SYSTEM

Car Multimedia System



**DVD/DIVX/VCD/CD/MP3/MP4/USB/MINI SD PLAYER
WITH AM/FM/ STERO DIGITAL
PLL TUNING RADIO**

English

Welcome!

Thank you for purchasing our company multimedia player!
To operate the unit correctly, please read the owner's manual carefully before using the unit. Keep these instructions and retain this booklet for future reference.

CONTENTS

Welcome!contents	1
Notes on installation	2
Wiring diagram/Remote Control Operation	3
Panel	4
DVD-MP4 Operation	5
DVD-MP4 Operation	6
Installation	7
Installation	8
Specification	9
Simple troubleshooting guide	10

7Color LED changing

long press Volume Knob,LCD will display the current display button color, then turn left /right to select your color.

Notes on installation

- The unit is designed for 12V DC. After the completion of the negative ground operation system only. Before installing the unit, make sure your vehicle is connected to DC 12V negative ground electrical system.
- The negative battery terminal must be disconnected before making connections, which can reduce damaging the unit due to short circuit.
- Be sure to connect the color coded leads correctly according to the diagram. wrong connections may cause the unit malfunction or damage the vehicle's electrical system.
- Be sure to connect the speaker(-) leads to the speaker (-) terminal. Never connect the left and right channel speaker cables each other or to the vehicle body.
- Do not block vents or Cooling panels. Blocking them will cause heat to build up inside and may result in fire.

Precautions

This unit can play the following discs only:

Type of disc	Label on the disc	Recorded material	Size of disc
DVD		Sound and moving Pictures	12cm
VCD		Sound and moving Pictures	12cm
MP4	MP4	Sound and moving Pictures	12cm
MP3	MP3	Sound only	12cm
CD	disc	Sound only	12cm

Note: 1. The unit is compatible with DVD, VCD, R2, R3, R4, R5, R6, R7, R8, R9, R10, R11, R12, R13, R14, R15, R16, R17, R18, R19, R20, R21, R22, R23, R24, R25, R26, R27, R28, R29, R30, R31, R32, R33, R34, R35, R36, R37, R38, R39, R40, R41, R42, R43, R44, R45, R46, R47, R48, R49, R50, R51, R52, R53, R54, R55, R56, R57, R58, R59, R60, R61, R62, R63, R64, R65, R66, R67, R68, R69, R70, R71, R72, R73, R74, R75, R76, R77, R78, R79, R80, R81, R82, R83, R84, R85, R86, R87, R88, R89, R90, R91, R92, R93, R94, R95, R96, R97, R98, R99, R100, R101, R102, R103, R104, R105, R106, R107, R108, R109, R110, R111, R112, R113, R114, R115, R116, R117, R118, R119, R120, R121, R122, R123, R124, R125, R126, R127, R128, R129, R130, R131, R132, R133, R134, R135, R136, R137, R138, R139, R140, R141, R142, R143, R144, R145, R146, R147, R148, R149, R150, R151, R152, R153, R154, R155, R156, R157, R158, R159, R160, R161, R162, R163, R164, R165, R166, R167, R168, R169, R170, R171, R172, R173, R174, R175, R176, R177, R178, R179, R180, R181, R182, R183, R184, R185, R186, R187, R188, R189, R190, R191, R192, R193, R194, R195, R196, R197, R198, R199, R200, R201, R202, R203, R204, R205, R206, R207, R208, R209, R210, R211, R212, R213, R214, R215, R216, R217, R218, R219, R220, R221, R222, R223, R224, R225, R226, R227, R228, R229, R230, R231, R232, R233, R234, R235, R236, R237, R238, R239, R240, R241, R242, R243, R244, R245, R246, R247, R248, R249, R250, R251, R252, R253, R254, R255, R256, R257, R258, R259, R260, R261, R262, R263, R264, R265, R266, R267, R268, R269, R270, R271, R272, R273, R274, R275, R276, R277, R278, R279, R280, R281, R282, R283, R284, R285, R286, R287, R288, R289, R290, R291, R292, R293, R294, R295, R296, R297, R298, R299, R300, R301, R302, R303, R304, R305, R306, R307, R308, R309, R310, R311, R312, R313, R314, R315, R316, R317, R318, R319, R320, R321, R322, R323, R324, R325, R326, R327, R328, R329, R330, R331, R332, R333, R334, R335, R336, R337, R338, R339, R340, R341, R342, R343, R344, R345, R346, R347, R348, R349, R350, R351, R352, R353, R354, R355, R356, R357, R358, R359, R360, R361, R362, R363, R364, R365, R366, R367, R368, R369, R370, R371, R372, R373, R374, R375, R376, R377, R378, R379, R380, R381, R382, R383, R384, R385, R386, R387, R388, R389, R390, R391, R392, R393, R394, R395, R396, R397, R398, R399, R400, R401, R402, R403, R404, R405, R406, R407, R408, R409, R410, R411, R412, R413, R414, R415, R416, R417, R418, R419, R420, R421, R422, R423, R424, R425, R426, R427, R428, R429, R430, R431, R432, R433, R434, R435, R436, R437, R438, R439, R440, R441, R442, R443, R444, R445, R446, R447, R448, R449, R450, R451, R452, R453, R454, R455, R456, R457, R458, R459, R460, R461, R462, R463, R464, R465, R466, R467, R468, R469, R470, R471, R472, R473, R474, R475, R476, R477, R478, R479, R480, R481, R482, R483, R484, R485, R486, R487, R488, R489, R490, R491, R492, R493, R494, R495, R496, R497, R498, R499, R500, R501, R502, R503, R504, R505, R506, R507, R508, R509, R510, R511, R512, R513, R514, R515, R516, R517, R518, R519, R520, R521, R522, R523, R524, R525, R526, R527, R528, R529, R530, R531, R532, R533, R534, R535, R536, R537, R538, R539, R540, R541, R542, R543, R544, R545, R546, R547, R548, R549, R550, R551, R552, R553, R554, R555, R556, R557, R558, R559, R560, R561, R562, R563, R564, R565, R566, R567, R568, R569, R570, R571, R572, R573, R574, R575, R576, R577, R578, R579, R580, R581, R582, R583, R584, R585, R586, R587, R588, R589, R590, R591, R592, R593, R594, R595, R596, R597, R598, R599, R600, R601, R602, R603, R604, R605, R606, R607, R608, R609, R610, R611, R612, R613, R614, R615, R616, R617, R618, R619, R620, R621, R622, R623, R624, R625, R626, R627, R628, R629, R630, R631, R632, R633, R634, R635, R636, R637, R638, R639, R640, R641, R642, R643, R644, R645, R646, R647, R648, R649, R650, R651, R652, R653, R654, R655, R656, R657, R658, R659, R660, R661, R662, R663, R664, R665, R666, R667, R668, R669, R670, R671, R672, R673, R674, R675, R676, R677, R678, R679, R680, R681, R682, R683, R684, R685, R686, R687, R688, R689, R690, R691, R692, R693, R694, R695, R696, R697, R698, R699, R700, R701, R702, R703, R704, R705, R706, R707, R708, R709, R710, R711, R712, R713, R714, R715, R716, R717, R718, R719, R720, R721, R722, R723, R724, R725, R726, R727, R728, R729, R730, R731, R732, R733, R734, R735, R736, R737, R738, R739, R740, R741, R742, R743, R744, R745, R746, R747, R748, R749, R750, R751, R752, R753, R754, R755, R756, R757, R758, R759, R760, R761, R762, R763, R764, R765, R766, R767, R768, R769, R770, R771, R772, R773, R774, R775, R776, R777, R778, R779, R780, R781, R782, R783, R784, R785, R786, R787, R788, R789, R790, R791, R792, R793, R794, R795, R796, R797, R798, R799, R800, R801, R802, R803, R804, R805, R806, R807, R808, R809, R810, R811, R812, R813, R814, R815, R816, R817, R818, R819, R820, R821, R822, R823, R824, R825, R826, R827, R828, R829, R830, R831, R832, R833, R834, R835, R836, R837, R838, R839, R840, R841, R842, R843, R844, R845, R846, R847, R848, R849, R850, R851, R852, R853, R854, R855, R856, R857, R858, R859, R860, R861, R862, R863, R864, R865, R866, R867, R868, R869, R870, R871, R872, R873, R874, R875, R876, R877, R878, R879, R880, R881, R882, R883, R884, R885, R886, R887, R888, R889, R890, R891, R892, R893, R894, R895, R896, R897, R898, R899, R900, R901, R902, R903, R904, R905, R906, R907, R908, R909, R910, R911, R912, R913, R914, R915, R916, R917, R918, R919, R920, R921, R922, R923, R924, R925, R926, R927, R928, R929, R930, R931, R932, R933, R934, R935, R936, R937, R938, R939, R940, R941, R942, R943, R944, R945, R946, R947, R948, R949, R950, R951, R952, R953, R954, R955, R956, R957, R958, R959, R960, R961, R962, R963, R964, R965, R966, R967, R968, R969, R970, R971, R972, R973, R974, R975, R976, R977, R978, R979, R980, R981, R982, R983, R984, R985, R986, R987, R988, R989, R990, R991, R992, R993, R994, R995, R996, R997, R998, R999, R1000, R1001, R1002, R1003, R1004, R1005, R1006, R1007, R1008, R1009, R1010, R1011, R1012, R1013, R1014, R1015, R1016, R1017, R1018, R1019, R1020, R1021, R1022, R1023, R1024, R1025, R1026, R1027, R1028, R1029, R1030, R1031, R1032, R1033, R1034, R1035, R1036, R1037, R1038, R1039, R1040, R1041, R1042, R1043, R1044, R1045, R1046, R1047, R1048, R1049, R1050, R1051, R1052, R1053, R1054, R1055, R1056, R1057, R1058, R1059, R1060, R1061, R1062, R1063, R1064, R1065, R1066, R1067, R1068, R1069, R1070, R1071, R1072, R1073, R1074, R1075, R1076, R1077, R1078, R1079, R1080, R1081, R1082, R1083, R1084, R1085, R1086, R1087, R1088, R1089, R1090, R1091, R1092, R1093, R1094, R1095, R1096, R1097, R1098, R1099, R1100, R1101, R1102, R1103, R1104, R1105, R1106, R1107, R1108, R1109, R1110, R1111, R1112, R1113, R1114, R1115, R1116, R1117, R1118, R1119, R1120, R1121, R1122, R1123, R1124, R1125, R1126, R1127, R1128, R1129, R1130, R1131, R1132, R1133, R1134, R1135, R1136, R1137, R1138, R1139, R1140, R1141, R1142, R1143, R1144, R1145, R1146, R1147, R1148, R1149, R1150, R1151, R1152, R1153, R1154, R1155, R1156, R1157, R1158, R1159, R1160, R1161, R1162, R1163, R1164, R1165, R1166, R1167, R1168, R1169, R1170, R1171, R1172, R1173, R1174, R1175, R1176, R1177, R1178, R1179, R1180, R1181, R1182, R1183, R1184, R1185, R1186, R1187, R1188, R1189, R1190, R1191, R1192, R1193, R1194, R1195, R1196, R1197, R1198, R1199, R1200, R1201, R1202, R1203, R1204, R1205, R1206, R1207, R1208, R1209, R1210, R1211, R1212, R1213, R1214, R1215, R1216, R1217, R1218, R1219, R1220, R1221, R1222, R1223, R1224, R1225, R1226, R1227, R1228, R1229, R1230, R1231, R1232, R1233, R1234, R1235, R1236, R1237, R1238, R1239, R1240, R1241, R1242, R1243, R1244, R1245, R1246, R1247, R1248, R1249, R1250, R1251, R1252, R1253, R1254, R1255, R1256, R1257, R1258, R1259, R1260, R1261, R1262, R1263, R1264, R1265, R1266, R1267, R1268, R1269, R1270, R1271, R1272, R1273, R1274, R1275, R1276, R1277, R1278, R1279, R1280, R1281, R1282, R1283, R1284, R1285, R1286, R1287, R1288, R1289, R1290, R1291, R1292, R1293, R1294, R1295, R1296, R1297, R1298, R1299, R1300, R1301, R1302, R1303, R1304, R1305, R1306, R1307, R1308, R1309, R1310, R1311, R1312, R1313, R1314, R1315, R1316, R1317, R1318, R1319, R1320, R1321, R1322, R1323, R1324, R1325, R1326, R1327, R1328, R1329, R1330, R1331, R1332, R1333, R1334, R1335, R1336, R1337, R1338, R1339, R1340, R1341, R1342, R1343, R1344, R1345, R1346, R1347, R1348, R1349, R1350, R1351, R1352, R1353, R1354, R1355, R1356, R1357, R1358, R1359, R1360, R1361, R1362, R1363, R1364, R1365, R1366, R1367, R1368, R1369, R1370, R1371, R1372, R1373, R1374, R1375, R1376, R1377, R1378, R1379, R1380, R1381, R1382, R1383, R1384, R1385, R1386, R1387, R1388, R1389, R1390, R1391, R1392, R1393, R1394, R1395, R1396, R1397, R1398, R1399, R1400, R1401, R1402, R1403, R1404, R1405, R1406, R1407, R1408, R1409, R1410, R1411, R1412, R1413, R1414, R1415, R1416, R1417, R1418, R1419, R1420, R1421, R1422, R1423, R1424, R1425, R1426, R1427, R1428, R1429, R1430, R1431, R1432, R1433, R1434, R1435, R1436, R1437, R1438, R1439, R1440, R1441, R1442, R1443, R1444, R1445, R1446, R1447, R1448, R1449, R1450, R1451, R1452, R1453, R1454, R1455, R1456, R1457, R1458, R1459, R1460, R1461, R1462, R1463, R1464, R1465, R1466, R1467, R1468, R1469, R1470, R1471, R1472, R1473, R1474, R1475, R1476, R1477, R1478, R1479, R1480, R1481, R1482, R1483, R1484, R1485, R1486, R1487, R1488, R1489, R1490, R1491, R1492, R1493, R1494, R1495, R1496, R1497, R1498, R1499, R1500, R1501, R1502, R1503, R1504, R1505, R1506, R1507, R1508, R1509, R1510, R1511, R1512, R1513, R1514, R1515, R1516, R1517, R1518, R1519, R1520, R1521, R1522, R1523, R1524, R1525, R1526, R1527, R1528, R1529, R1530, R1531, R1532, R1533, R1534, R1535, R1536, R1537, R1538, R1539, R1540, R1541, R1542, R1543, R1544, R1545, R1546, R1547, R1548, R1549, R1550, R1551, R1552, R1553, R1554, R1555, R1556, R1557, R1558, R1559, R1560, R1561, R1562, R1563, R1564, R1565, R1566, R1567, R1568, R1569, R1570, R1571, R1572, R1573, R1574, R1575, R1576, R1577, R1578, R1579, R1580, R1581, R1582, R1583, R1584, R1585, R1586, R1587, R1588, R1589, R1590, R1591, R1592, R1593, R1594, R1595, R1596, R1597, R1598, R1599, R1600, R1601, R1602, R1603, R1604, R1605, R1606, R1607, R1608, R1609, R1610, R1611, R1612, R1613, R1614, R1615, R1616, R1617, R1618, R1619, R1620, R1621, R1622, R1623, R1624, R1625, R1626, R1627, R1628, R1629, R1630, R1631, R1632, R1633, R1634, R1635, R1636, R1637, R1638, R1639, R1640, R1641, R1642, R1643, R1644, R1645, R1646, R1647, R1648, R1649, R1650, R1651, R1652, R1653, R1654, R1655, R1656, R1657, R1658, R1659, R1660, R1661, R1662, R1663, R1664, R1665, R1666, R1667, R1668, R1669, R1670, R1671, R1672, R1673, R1674, R1675, R1676, R1677, R1678, R1679, R1680, R1681, R1682, R1683, R1684, R1685, R1686, R1687, R1688, R1689, R1690, R1691, R1692, R1693, R1694, R1695, R1696, R1697, R1698, R1699, R1700, R1701, R1702, R1703, R1704, R1705, R1706, R1707, R1708, R1709, R1710, R1711, R1712, R1713, R1714, R1715, R1716, R1717, R1718, R1719, R1720, R1721, R1722, R1723, R1724, R1725, R1726, R1727, R1728, R1729, R1730, R1731, R1732, R1733, R1734, R1735, R1736, R1737, R1738, R1739, R1740, R1741, R1742, R1743, R1744, R1745, R1746, R1747, R1748, R1749, R1750, R1751, R1752, R1753, R1754, R1755, R1756, R1757, R1758, R1759, R1760, R1761, R1762, R1763, R1764, R1765, R1766, R1767, R1768, R1769, R1770, R1771, R1772, R1773, R1774, R1775, R1776, R1777, R1778, R1779, R1780, R1781, R1782, R1783, R1784, R1785, R1786, R1787, R1788, R1789, R1790, R1791, R1792, R1793, R1794, R1795, R1796, R1797, R1798, R1799, R1800, R1801, R1802, R1803, R1804, R1805, R1806, R1807, R1808, R1809, R1810, R1811, R1812, R1813, R1814, R1815, R1816, R1817, R1818, R1819, R1820, R1821, R1822, R1823, R1824, R1825, R1826, R1827, R1828, R1829, R1830, R1831, R1832, R1833, R1834, R1835, R1836, R1837, R1838, R1839, R1840, R1841, R1842, R1843, R1844, R1845, R1846, R1847, R1848, R1849, R1850, R1851, R1852, R1853, R1854, R1855, R1856, R1857, R1858, R1859, R1860, R1861, R1862, R1863, R1864, R1865, R1866, R1867, R1868, R1869, R1870, R1871, R1872, R1873, R1874, R1875, R1876, R1877, R1878, R1879, R1880, R1881, R1882, R1883, R1884, R1885, R1886, R1887, R1888, R1889, R1890, R1891, R1892, R1893, R1894, R1895, R1896, R1897, R1898, R1899, R1900, R1901, R1902, R1903, R1904, R1905, R1906, R1907, R1908, R1909, R1910, R1911, R1912, R1913, R1914, R1915, R1916, R1917, R1918, R1919, R1920, R1921, R1922, R1923, R1924, R1925, R1926, R1927, R1928, R1929, R1930, R1931, R1932, R1933, R1934, R1935, R1936, R1937, R1938, R1939, R1940, R1941, R1942, R1943, R1944, R1945, R1946, R1947, R1948, R1949, R1950, R1951, R1952, R1953, R1954, R1955, R1956, R1957, R1958, R1959, R1960, R1961, R1962, R1963, R1964, R1965, R1966, R1967, R1968, R1969, R1970, R1971, R1972, R1973, R1974, R1975, R1976, R1977, R1978, R1979, R1980, R1981, R1982, R1983, R1984, R1985, R1986, R1987, R1988, R1989, R1990, R1991, R1992, R1993, R1994, R1995, R1996, R1997, R1998, R1999, R2000, R2001, R2002, R2003, R2004, R2005, R2006, R2007, R2008, R2009, R2010, R2011, R2012, R2013, R2014, R2015, R2016, R2017, R2018, R2019, R2020, R2021, R2022, R2023, R2024, R2025, R2026, R2027, R2028, R2029, R2030, R2031, R2032, R2033, R2034, R2035, R2036, R2037, R2038, R2039, R2040, R2041, R2042, R2043, R2044, R2045, R2046, R2047, R2048, R2049, R2050, R2051, R2052, R2053, R2054, R2055, R2056, R2057, R2058, R2059, R2060, R2061, R2062, R2063, R2064, R2065, R2066, R2067, R2068, R2069, R2070, R2071, R2072, R2073, R2074, R2075, R2076, R2077, R

Wiring diagram/ Remote Control Operation

STANDARD CONNECT

① Antenna Receptacle

② Power and speaker connector

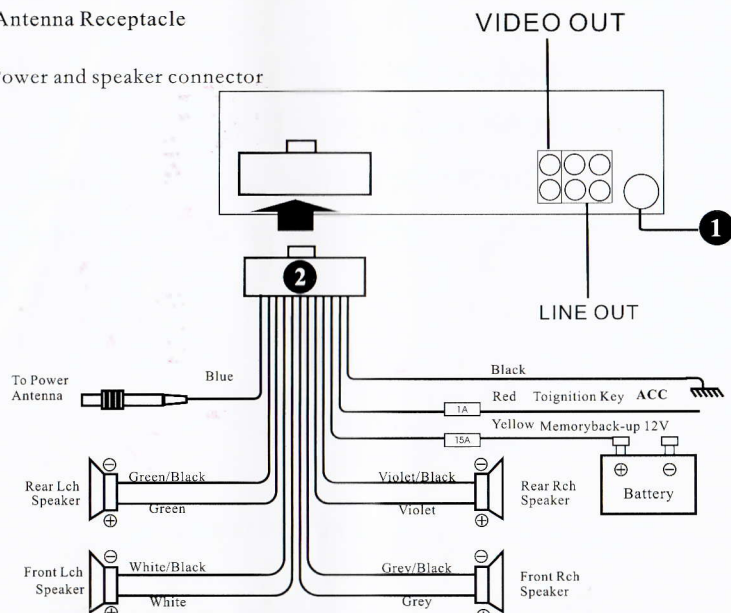

Remote Control Operation

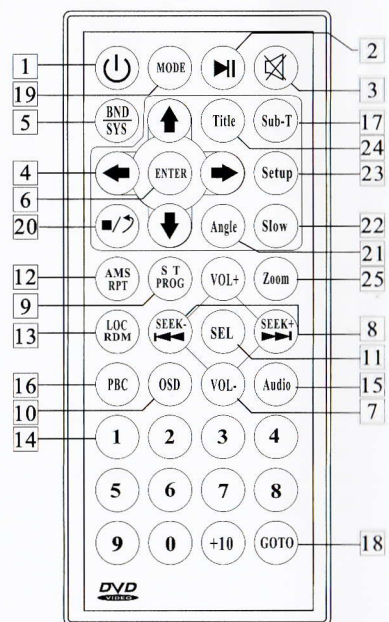

- ① Power Switch
- ② Play and Pause Switch
- ③ Mute Button
- ④ Selecting Menu Button
- ⑤ Band/System Switch
- ⑥ Enter Button
- ⑦ Volume Control
- ⑧ Tuning/Selecting/Tracks/F.F/REW
- ⑨ Program Playing/ST
- ⑩ On-Screen Display
- ⑪ Selector Button
- ⑫ Repeat Playing/AMS
- ⑬ Random Playing
- ⑭ Number Button
- ⑮ Audio-Setting
- ⑯ PBC Menu
- ⑰ Subtitle Time-Setting
- ⑱ Playing Time-Setting
- ⑲ Mode Switch
- ⑳ Stop/Reverse Button
- ㉑ Angle-Setting
- ㉒ Slow-motion Play
- ㉓ Setup Menu
- ㉔ Title Button
- ㉕ Zoom Button

PANEL

Note: every operation, less one second is short holding, more than 1 second is long holding

(Turn Panel Machine)

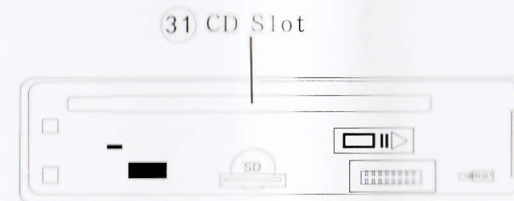

- | | | | |
|---------------------------|------|----------------|------|
| ① AUX in | AUX | ⑮ Repeat | RPT |
| ② Power Button | ⏻ | ⑯ INT button | INT |
| ③ Release Button | ⏻ | ⑰ AMS Button | AMS |
| ④ Remote Control Receptor | IR | ⑱ Forward | ▶▶ |
| ⑤ Mute Button | MUT | ⑲ Retreat | ◀◀ |
| ⑥ SEL / VOL button | SEL | ㉑ MODE Button | MODE |
| ⑦ St Button | ST | ㉒ DISC Slot | |
| ⑧ Band Button | BND | ㉔ Loud Button | LOUD |
| ⑨ CLK | CLK | ㉕ Reset Button | RES |
| ⑩ Lcd Display | LCD | ㉖ Eject Button | ▲ |
| ⑪ Logo Mark | | ㉗ CD Slot | |
| ⑫ USB Card port | USB | | |
| ⑬ SD Card port | SD | | |
| ⑭ Number button | | | |
| ⑮ Play/pause | | | |
| ⑯ program | PROG | | |
| ⑰ random | RDM | | |

- ① AUX in AUX IN function.
- ② Power Button press the POWER button to turn the unit, press it again to turn off the unit, all the memorized setting will retain after the unit turned off.
- ③ Release Button press the ③ button, you can detach the front panel
- ④ Remote Control Receptor The function will incept info from remote control.
- ⑤ Mute Button press mute button to cut down the sound output, press it again to release the mode and recover the previous volume level.

DVD-MP4 Operation

- ③ SEL / VOL button For Volume Control (6), Press Vol knob clock wise to increase the sound level, and rotate it anticlock wise to decrease the sound level. Repeatedly press (6) (SEL) button to select the desired mode in the following order:

LOUD → VOL → BAS → TRE
EQ → FAD → BAL

Note: After selecting the desired mode, you can adjust the current level by rpressing the (6) (VOL) knob.

Note: If you don't adjust (6) (VOL) knob within 5 seconds after selecting the desired mode the unit will automatically return to the current mode being displayer.

VOL → BAL → FAD
FLAT → KOCK
CLASS ← POP

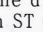
- ⑦ St Button Press this button to select MONO mode or Stereo mode, ST appears in the LTD, and  appears in the display. it is switch to mono mode when ST disappears. During the player mode, press the button to switch left speaker/right speaker/stereo.

- ⑧ Band Button During the radio mode, press this button, you can select the BAND function:

FM1 → FM2 → FM3
AM2 ← AM1

- ⑨ Display or clock press display button (9) and current time is displayed, and it returns to original status after 5 seconds or press the button again. times adjusting: press and hold display button until the two points in the middle of the clock stop blinking, you can press VOL button to adjust hourst and minutes. ⑩

- ⑩ LCD DISPLAY The LCD DISPLAY (10) shows the status of the unit.

- ⑪ Logo Mark Logo mark

- ⑫ USB Card port insert the USB card, tje system will auto play, press the MODE when you want receiving a station or playing DVD. Press the (UP DN ◀ ▶) to choose your favorite track upward or downward respectively.

- ⑬ SD Card port insert the SD card, tje system will auto play, press the MODE when you want receiving a station or playing DVD. Press the (UP DN ◀ ▶) to choose your favorite track upward or downward respectively.

- ⑭ ⑮ Number button PRESET STATION BUTTON (1-6)
Press any one of the 1-6 (14-15) button to select a staion which had been stored in the memory. Press the button for several seconds, the current station broadcasting will be stoed into the number button.

- ⑯ Program Playing

During playback, press (16) PROG Button to program playing, and "PROG" appears on the display.

- ⑰ RDM During playback, press RDM button, and "RDM" appears on the display (See the picture), which indicates RDM function is carried out. The unit plays any track at random. Press RDM once more to return to normal playback mode.

DVD-MP4 Operation

- ⑱ RPT

Playing Tracks Repeatedly
Press (18) "RPT" button to perform repeat playing function when you need to repeat playing the track you like.

During the CD / VCD model, press the REPT button is open the menu. Press it again close the REPT function. During the DVD model, press it once, repeat main menu; press second, it will dispaly the title; press it third, turn off. During the MP3 / MP4 model, press it once, display the singal song; press it again, display the whole menu; press it third, turn off.

- ⑲ INT

During play back, press "INT" button, one of the number button (19) to play the first 10 seconds of each reack on the disc, the display will show "INT, track number and elapsed time" (See the picture), which indicates INT function is already activated.

- ⑳ AMS function Press this button to search each stored station 10 second in 16-21 (1-6) number buttons, when AMS mode is carried out, INT appears on display. you can also press the corresponding number or AMS button when you desired station is changed. it start playing that button. press and hold the AMS button for 3 seconds to activate automatically memory storing function a station and has it stored in any one of the number buttons 1-6.

- ㉑ ㉒ SEEK- SEEK+ Press ㉑ ㉒ (SEEK- or SEEK+) to choose your favorite track upward or downward respectively. Press and hold ㉑ ㉒ (SEEK- or SEEK+) button to fast forward or rewind the track upward or downward respectively.

- ㉓ Mode Selector Press ㉓ (MOD) button to select radio mode or playback mode under AUX function, the mode switch by the order:

→ RADIO → PLAY → AUX →

- ㉔ CD SLOT

While listening to (or watching) DVD, VCD, MP4, MP3, CD, justing insert a CDs (with labeled side up) into the CD SLOT, the mechanism will automatically switch on. If a CDs is loaded, press ㉔ (MOD) button to start the playing. While listening to (or watching) MP3, just insert a CDs into the CD SLOT (㉔), the mechanism will automatically switch on. And the menu on the disc will display to select playing pictures or music.

- ⑮ play/pause

During playback, press (16) (PAUSE) button to suspend the playback, "PAUSE" is showed and twinkling in the display. To return to normal play mode, press it again, the display shows the music running time

- ㉕ Rest Button

Operating the unit for the first time Or after replacing the car battery you must reset the unit. Press (RES) Button with a pointed object (such as ball point pen) to set the unit to initial procedure.

Note: When some errors occur in the LCD display, you can also press RESET button to resume to normal, and it will erase the clock setting and some memorized functions.

- ㉖ Eject button

Press ㉓ (Eject button (▲)) to eject the Disc.

Note: please use original disc for this product poor quality disc might damage the lens. If the product automatically loaded. Press ㉓ (MOD) to change to radio mode and press the EJECT (▲) button for 3 seconds to eject the disc.

Installation

Parts List (The numbers in the list are keyed to those in the instructions.)

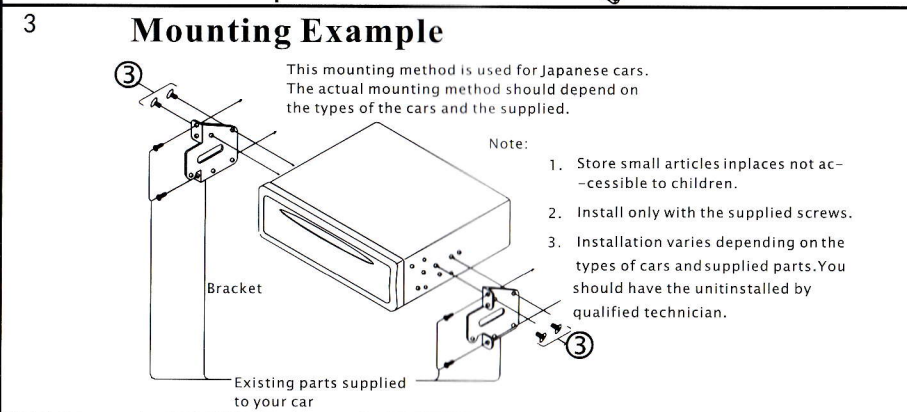
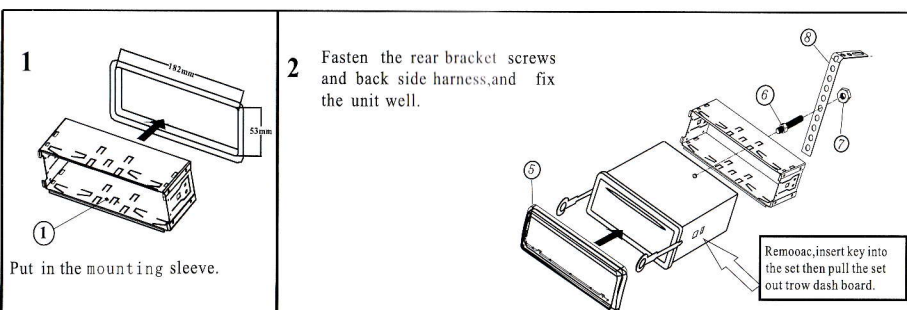
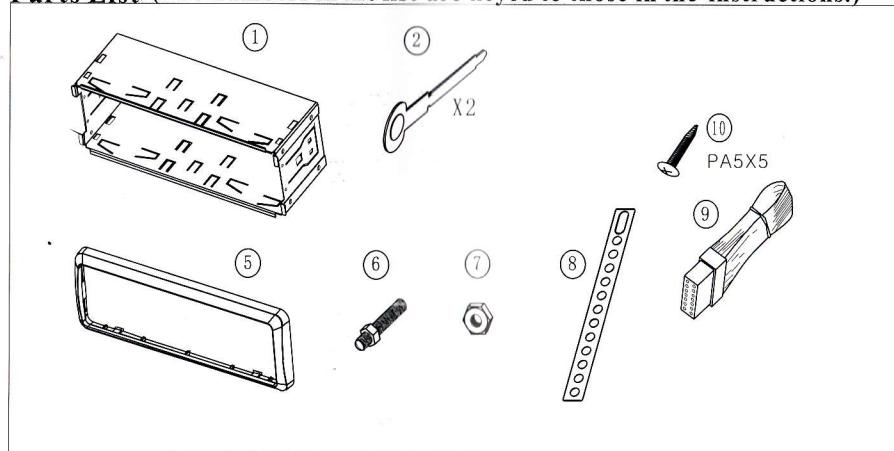

Specification

General

Power Requirements	DC10V-14.4V
Load Impedance	4Ω x4
Max. Power Output	45W x4
Tone Controls	+/-8dB (Bass 100Hz, Treble 10KHz)
Dimensions	Approx: 192x178x50mm (DxWxH)
Mounting Dimensions	Approx: 169x182x53mm (DxWxH)
Weight	Approx: 1.75kg

DVD Deck Section

Discs Played	DVD/VCD/MP4/MP3/CD/Picture-CD
Video System	AUTO/PAL/NTSC/PAL60
Mounting Angle	0 to +/-30°

Video Section

Video System	4:3 Letter Box and 16:9 Pan Scan
Video Output level	1.0Vp-p 75 Ohms
Horizontal Resolution	500

Audio Section

Maximum Output level	2Vrms (+/-3dB)
Frequency Response	20Hz to 20KHz
Signal-to-noise Ratio	60dB
Separation	50dB

AM Tuner Section

Frequency Range	522-1620 KHz (Europe/China); 530-1710 KHz (U.S.A)
IF Range	450KHz
Usable Sensitivity (-20dB)	25dB

FM Tuner Section

Tuning Range	87.5-108.0MHz (Europe/China); 87.5-107.9MHz (U.S.A) 65.0-108.0MHz (Russia); 76.0-90.0MHz (Japan)
IF Range	10.7MHz
Usable sensitivity	15dB
Signal-to-noise Ratio	50dB
Stereo Separation	30dB (1KHz)
Frequency Response	30-15KHz

Simple troubleshooting guide

★ *Note: If any of the problem persists after check list had been made, consult your nearest service dealer. Never attempt to disassemble your unit by yourself.*

Problem	Cause/Solution
No power	★ <i>Check and make sure whether the fuse is blown. Replace with the proper value if necessary</i>
Some errors occur in the LCD or no function When pressing the button.	★ <i>Press the RESET button.</i>
Unable to receive stations a station.	★ <i>Check and make sure whether the antenna is Inserted or the antenna is properly connected. If so. Insert the antenna or connect it properly.</i>
Poor effect on receiving.	<ul style="list-style-type: none"> ★ <i>Antenna may not be the proper length. Make sure the antenna is fully extended or broken. If broken. replace the antenna with a new one.</i> ★ <i>The broadcasting signal is too weak.</i> ★ <i>The antenna is poorly grounded check and make sure the antenna is properly grounded at its mounting location.</i>
ACDs cannot be loaded.	★ <i>ACDs is loaded in the mechanism.</i>
The stereo indicator "  " is flashing	<ul style="list-style-type: none"> ★ <i>Tune in the frequency accurately</i> ★ <i>The broadcasting signal is too weak. (Set to the MONO mode)</i>
No picture	★ <i>The Video line from main unit to the TV is Not connected properly.</i>
The picture noise appears	<ul style="list-style-type: none"> ★ <i>Improper setting of the color system. Set the color system to PAL or NTSC. according to the connected television.</i> ★ <i>The CDs is dirty or damaged.</i>