



Sports/Swimming Bluetooth Headset
INSTRUCTION MANUAL



 **Bluetooth®**

Model: WBH9

READ THIS MANUAL CAREFULLY BEFORE USING THE BLUETOOTH HEADSET.

Congratulations on purchasing your new waterproof bluetooth headset. We are convinced you will be satisfied with it. To always guarantee the great performance of this item, we would like to ask the following:

Before using our product for the first time, carefully read the Safety guide, warranty and operating instructions and adhere to the safety precautions. All activities done with this item may only be carried out as described in these operating instructions. Improper use of this device may cause the user to make mistakes or decisions that could lead to serious injury or death.

IMPORTANT:**SAFETY GUIDE:**

1. Do not use the bluetooth headset for purposes other than described in this manual. It can be potentially dangerous to use your bluetooth headset while engaging in other activities that require your full attention. You should exercise extreme caution or discontinue use in potentially hazardous situations.
2. Do not **DISASSEMBLE** or **MODIFY** the bluetooth headset in any way. Disassembly or modification will void the warranty.
3. Do not drop the bluetooth headset or apply excessive shock to the unit. Fire or electric shock may result due to using a damaged unit.
4. Do not place the bluetooth headset close to any heating device.
5. Do not use or store the bluetooth headset in places with high temperatures, fast temperature changes or strong magnetic fields.
6. To avoid accidents, **DO NOT** use the headset while driving or operating other vehicles, this includes cars, motorcycles and bicycles. This is the law in some places. To avoid accidents, please do not listen to music at a high volume while walking, especially when crossing the street as well as in other potentially dangerous situations. Do not use the bluetooth headset in traffic areas during activities such as driving, jogging, riding a bicycle or any area where an accident could occur. If the user utilizes this unit at or near the watersurface, the user must maintain safety awareness of moving water crafts. Always follow the law of the country where you reside. Many countries have laws prohibiting such actions. Obey local laws, be alert and listen carefully.
7. Do not listen to music too loud as it will damage your hearing and can cause permanent hearing loss, do not turn up the volume to block out noisy sounds around you. If you



cannot hear the sound of another person speaking when sitting opposite you 1 meter away then you are listening to the music too loud. Continuous use of earphone for many hours at high volumes may cause permanent hearing loss. In general the user must not listen to music too loud as this will also cause hearing loss. Listen to earphones at a comfortable level for reasonable periods of time. Hearing experts advise against listening continuously loud and extended play. Always make sure that the bluetooth headset volume is turned down low before putting the earphones in your ears. If you put the earphones in your ears and then turn on the device, it may cause hearing loss due to a sudden burst of volume. Always set the volume level to a comfortable level for listening. Caution : the earbuds insert directly into the ear and are not to be used during scuba diving. Prolonged exposure to pressures at depths below 1 meter may result in permanent hearing loss. Discontinue use at first sign of pain or hearing loss.

8. Please plug or unplug the bluetooth headset and earphone frame carefully as instructed. Failure to do so will result in damage to bluetooth headset.
9. When you plug the USB jack into a computer or USB charger, make sure you are plugging in the correct end. If the USB jack is plugged in the wrong way, the computer or the device might be damaged.
10. **DO NOT CONNECT THE BLUETOOTH HEADSET TO THE COMPUTER OR CHARGER IF THE BLUETOOTH HEADSET IS WET.** Doing so could result in permanent damage to the Computer and the Bluetooth headset, this could also result in the user receiving electric shocks or even dying. Do not leave the USB jack plugged into the computer while unattended.
11. Maintain and keep the USB connection of the bluetooth headset free of dirt.
12. When the bluetooth headset becomes dusty or dirty, wipe off with a soft cloth or clean towel.
13. Keep out of reach of children, the parts included with this product can represent a choking hazard. This product is not for children under 6 years of age.
14. Do not use chemicals or solvents to clean the device.

SPECIFICATIONS:

Waterproof to a depth of up to 3 metres, while bluetooth can apply only on the surface of water.

Bluetooth Version: 2.1+EDR

Distance: 10 meters for open distance

PC Interface: USB 2.0, only for charging



Power: Built in 3.7V Li-Polymer Rechargeable Battery

Playback Time: Up to 6 hours

Standby Time: 20 hours

Dimensions (WxDxH): 2.4x1.8x0.8 inches

Weight: 32g (0.07 lbs) including rechargeable battery and head phones Operating Temperature Range: 0°C – 80°C

Storage Temperature Range: 0°C – 80°C

Accessories:

Extra Earbuds, Instruction Manual, USB extension Cable

USE THE CORRECT EAR BUDS

The earphones use exceptionally high quality Japanese driver component in order to deliver such excellent sound. The earphones are delivered with five sets of earbuds for perfectly fitting all ear sizes. There are three sizes for land sports and two sizes for water sports. Make sure you use the correct type for watersport activities and fit them correctly to ensure that water does not enter the earphone channel.

Ear buds for normal usage



Ear buds for water sport activities



IMPORTANT READ THIS:

To ensure a watertight fit, make sure the watersport earbuds are fitted correctly onto the earphones. Be sure to push the bud all the way back over the TWO ridges (A) AND (B) until reaching position C. If water does enter the channel and covers the waterproof membranes the sound quality can be temporarily effected. Don't worry, allow the earphones to air dry and the sound quality will return to normal. For best results always insert the earphones snugly in your ears before entering the water and use the correct size ear bud. To ensure a very snug water tight fit, to get a snug fit in your ear gently pull your ear backwards with one hand, while inserting the earphone with the other.

3







OPERATING INSTRUCTIONS:

The controls on the Bluetooth headset are very easy to use. First of all familiarise yourself with the controls by looking at the buttons. Then place the Bluetooth headset on your head, locate the central button (play/pause) and it is easy to adjust all the controls with one finger, volume up, volume down, jump forward, play/pause, on/off.

1. Press and hold  for 5 seconds

to power on, and press  for 3 seconds, the red LED will blink to pair. After first paired, the Bluetooth headset will automatically re-connect.



2. Go to your mobile phone and turn on the Bluetooth and search the new Bluetooth device. On the pairing mode, led will blink red and blue. If no pairing for 3 ~ minutes, the Bluetooth headset will power off automatically.
3. "Tayogo BT headset" will appear on the bluetooth list and press to connect.
4. The LED will flash blue slowly and you can use the Bluetooth headset to call or to listen music.
5. After the Bluetooth headset is connected, you can listen to the music through the headset, control volume by the button + or -, or go back/forward songs through the button  and .
6. Press the button  to pick up the phone call or press and hold 2 seconds to reject the coming call. In the phone call, press and hold 2 seconds to finish the call.
7. Press  twice continuously, it can re-dial your last phone number.
8.  Button is to reset or restart the Bluetooth headset.
9. You can charge the device with computer usb port or any usb charger with 5V 1A output. Led will flash red during charging and come to blue after fully charged.

4

STEP 1:

The Bluetooth headset is in the closed position when you buy it.

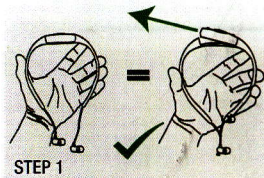

STEP 2:

To remove the Bluetooth headset from frame gently squeeze frame gently to release Bluetooth headset and remove with the other hand. **VERY VERY IMPORTANT : BEND THE EARFRAME SO THAT THE BLUETOOTH HEADSET CAN EASILY SLIDE OUT PAST THE HEAD FRAME IN THE DIRECTION OF THE GREEN ARROW .**

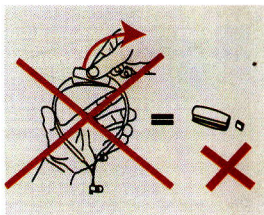
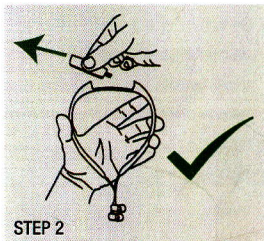

STEP 3:

Please plug into the bluetooth headset into the computer usb port. Pls make sure it is the correct position as the picture shows. If the wrong position, the bluetooth headset can not be found in your computer.

1. Connect the USB plug the correct way up to the computer USB socket or other usb charger.
2. or if using the USB cable, connect USB connector into the USB port of your computer or usb power adapter..
3. Charging will automatically begin. It will take up to 120-160 minutes to completely recharge a fully discharged battery, depending on your computer. The LED Status will flash red while charging. The LED will become blue after fully charged.

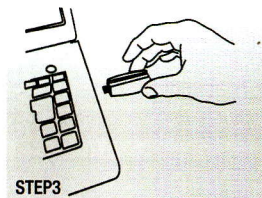

STEP 4:

After recharging the Bluetooth headset hold the frame with one hand and place the Bluetooth headset into the frame with the other hand.

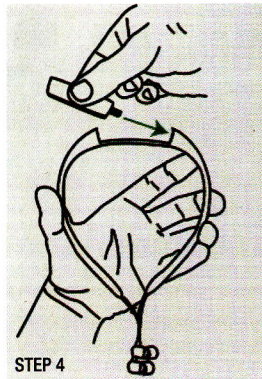

STEP 5:

Click to lock the Bluetooth headset into the frame and create waterproof seal (WARNING: be sure the contact points between the Bluetooth headset and the USB socket are free of dirt, sand or any other debris otherwise it wont seal properly)

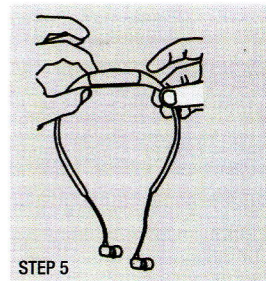

STEP 6:

The bluetooth headset has been designed to be fully adjustable to fit all heads comfortably. You may notice a "snug" fit the first time you use the Bluetooth headset. This snug fit is important so that the Bluetooth headset stays in place while performing active sports. However it may be necessary to bend open the earphone frame so that they are more comfortable. However do not over bend the frame as this could permanently damage it. Take your time to get the perfect fit. Use it , then adjust it. The frame material is designed to mould to the shape of your head after use. This is the normal procedure.

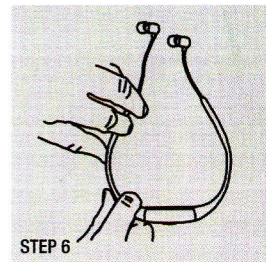

STEP 7:

The frame will fit close to your head and the earphones fit snugly in the ears and lie flat against the ear. They should not stick out.

