



SoundPad

User Manual

To Our Dearest Valuable Customers

Thank you for choosing our products, truly honored to enrich your life by providing series of amazing products. Before using any of our products, please read the user manual coming with the package to avoid any incorrect operation or damage.



Important Safety Instructions



WARNING

**RISK OF ELECTRIC SHOCK
DO NOT OPEN**



WARNING: TO REDUCE THE RISK OF ELECTRIC SHOCK, DO NOT REMOVE COVER OR BACK. NO USER-SERVICEABLE PARTS INSIDE. REFER SERVICING TO QUALIFIED SERVICE PERSONNEL.



The lightning flash with arrow head symbol, within an equilateral triangle is intended to alert the user that parts inside the product constitute a risk of electric shock to persons.



The exclamation point within an equilateral triangle is intended to alert the user that important operating and servicing instructions are in the papers with the appliance.

- 1 Read these instructions.
- 2 Keep these instructions.
- 3 Heed all warnings.
- 4 Follow all instructions.
- 5 Do not defeat the safety purpose of the polarized or grounding-type plug. A polarized plug has two blades with one wider than the other. A grounding type plug has two blades and a third grounding prong. The wide blade or the third prong are provided for your safety. If the provided plug does not fit into your outlet, consult an electrician for replacement of the obsolete outlet.
- 6 Protect the power cord from being walked on or pinched particularly at plugs, convenience receptacles, and the point where they exit from the unit.
- 7 Only use attachments/accessories specified by the manufacturer.

- 8 Refer all servicing to qualified service personnel. Servicing is required when the unit has been damaged in any way, such as power-supply cord or plug is damaged, liquid has been spilled or objects have fallen into the unit, the unit has been exposed to rain or moisture, does not operate normally, or has been dropped.
 - 9 Do not install near any heat sources such as radiators, heat registers, stoves, or other units (including amplifiers) that produce heat.
 - 10 Unplug this unit during lightning storms or when unused for long periods of time.
- Warning
 - All packing materials such as internal bags, plastic collars, plastic films, and carton inserts are not part of this product and should be discarded.
 - Do not try to disassemble the unit.
 - Only use a wall outlet to charge your SoundPad and the power adapter that came with the device.
 - Do not expose the unit to moisture or water.
 - Keep the unit clean by wiping it with a slightly damp cloth.
 - Never use SoundPad while operating a motor vehicle or bicycle.
 - If you feel discomfort in your hands or any pain using SoundPad, please stop immediately.
 - In case of long periods of use, take frequent breaks.
 - Never force a connector into a port of SoundPad. If a connector and a port do not join with reasonable force, make sure that the connector matches the port and that you have positioned the connector correctly in relation to the port.
 - To clean the screen, simply use a soft damp cloth. Do not use alcohol, solvent, aerosol spray or abrasive cleaners to clean your SoundPad.
 - The product and the adapter should be periodically examined for conditions that may result in the risk of fire, electric shock, or injury to persons and that, in an event such conditions, the adapter should not be used until properly repaired.
 - Operate SoundPad in a place where the temperature is between 0° and 35°C (32° to 95°F). Low or high temperature conditions might temporarily shorten battery life or cause SoundPad to temporarily stop working properly. Avoid dramatic changes in temperature or humidity when using SoundPad, as condensation may form on or within SoundPad.
 - Store SoundPad in a place where the temperature is between -20° and 45°C (-4° to 113°F). Don't leave SoundPad in your car because temperatures in parked cars can exceed this range.
 - When you're using SoundPad or charging the battery, it is normal for SoundPad to get warm. The exterior of SoundPad functions as a cooling surface that transfers heat from inside the unit to the cooler air outside.
 - The rechargeable battery in SoundPad should be replaced only by Manufacturer's Service.
 - Do not expose a battery pack or installed batteries to excessive heat such as sunshine, fire or the like.

- If you will not use SoundPad frequently, then we recommend that you fully charge and discharge the battery every three months in order to maximize the battery lifespan.
- If you will not use SoundPad frequently, then we recommend that you keep the battery level at around 50 percent in order to maximize the battery life span.
- If SoundPad has not been used for a long period of time, then the battery might be in an over-discharge protection mode and take longer to charge.
- This device is restricted to indoor use when operating in the 2.4 to 2.483 GHz frequency band.
- The Wi-Fi function and the Bluetooth function can simultaneously operate, but can not simultaneously transmit.
- Never remove or insert microSD card while the SoundPad is powered on.
- The manufacturer is not responsible for any radio or TV interference caused by unauthorized modifications to this equipment. Such modifications could void the user's authority to operate the equipment.



Content

Package Contents	2
Product specification Tech Specs	3
Remote Control.....	4
Viewing the Remote Control.....	4
Installing Batteries in the Remote Control.....	4
Understanding Your SoundPad.....	5
Making Connections.....	7
Power input.....	7
Connecting HDMI	8
MicroSD/TF card.....	8
Connecting USB	8
LINE IN.....	8
RESET	8
Basic.....	9
Using Touch Navigation	9
Turning Your SoundPad On for the First Time	9
Unlock the screen.....	10
Home Screen.....	10
Troubleshooting.....	13
SoundPad displays network or service error message	13
Touch screen response is slow or incorrect	13
SoundPad is frozen or a serious error appears	13
SoundPad gets warm	13
Appendix.....	14
Certification and Compliance.....	14
Copyright and Trademark Notices	15

1 Package Contents

The following items are included with the SoundPad:

NOTE

- Images throughout this Quick Start Guide are for illustrative purposes only and may differ from the actual product.

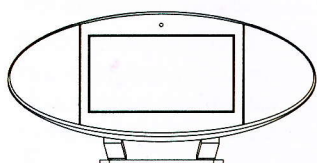

SoundPad

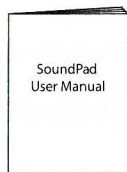

User Manual



IR remote controller
(optional)

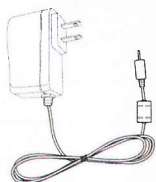

Adapter DC 12V 1.5A

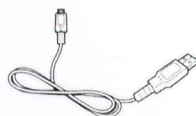

Micro-USB Cable

NOTES

- This power adapter is only for reference, it may vary in different countries.

2 Product specification Tech Specs

Model		SoundPad	
Dimensions (mm)		326 × 110 × 160	
Weight (KG)		1.5 (with package)	
Storage		RAM 1G, ROM 8G	
Screen diagonal size (inch)		7	
Screen resolution		1024 × 600 (multi-touch)	
Power supply	Battery	3.7V 3000 mAh Li-Battery	
	Adapter	DC 12V-1.5A adapter	
	Charging time	2 hours	
	Standby time	72 hours (Wi-Fi and Bluetooth Off)	
	Working time	video streaming (default volume)	3 hours
		Music streaming (screen off)	7 hours
		Bluetooth streaming (screen off)	6 hours
Web viewing using Wi-Fi		3 hours	
Memory card		Micro SD/TF card 2GB ~ 32GB	
Environment Conditions		Temperature 0°C ~ 40°C Humidity 60% ~ 80% RH	

file formats supported as below:

Audio	Play format	MP3, WMA, FLAC, WAV, OGG, OGA, AAC, AMR, MIDI
Video	Play format	MPEG- 1 / 2, MPEG- 4, DIVX- 4 / 5 / 6, H. 2 6 4, H. 2 6 3, VC- 1, MJPEG, VP6 / 8
	Max resolution	1920 × 1080P
Image		JPG, JPEG, GIF, BMP, PNG

NOTE

- Features, appearance and specifications are subject to change without notice.

3 Remote Control

Viewing the Remote Control

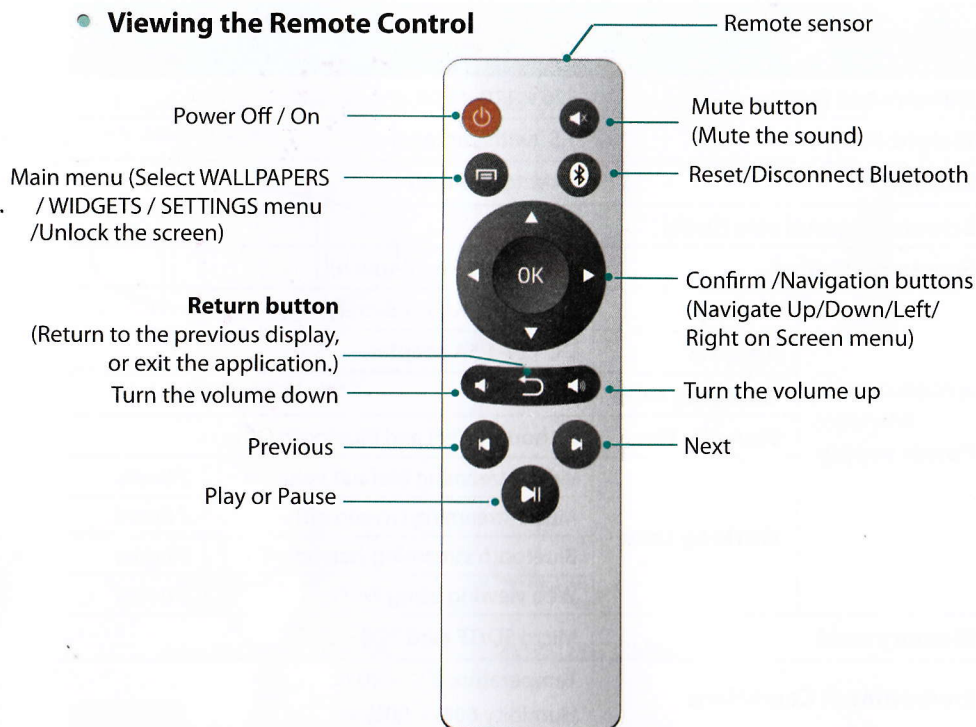

Installing Batteries in the Remote Control

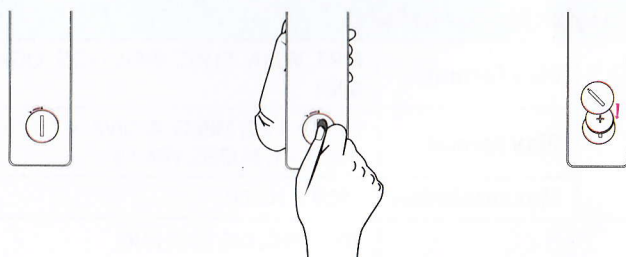

NOTES

- The batteries shall not be exposed to excessive heat such as sunshine, fire or the like.
- Remove depleted batteries immediately to prevent battery acid from leaking into the battery compartment.
- If you do not intend to use the remote control for a long time, remove the batteries.
- Battery chemicals can cause a rash. If the batteries leak, clean the battery compartment with a cloth. If chemicals touch your skin, wash immediately.
- Dispose of your batteries in a designated disposal area. Do not throw the batteries into a fire.

4 Understanding Your SoundPad

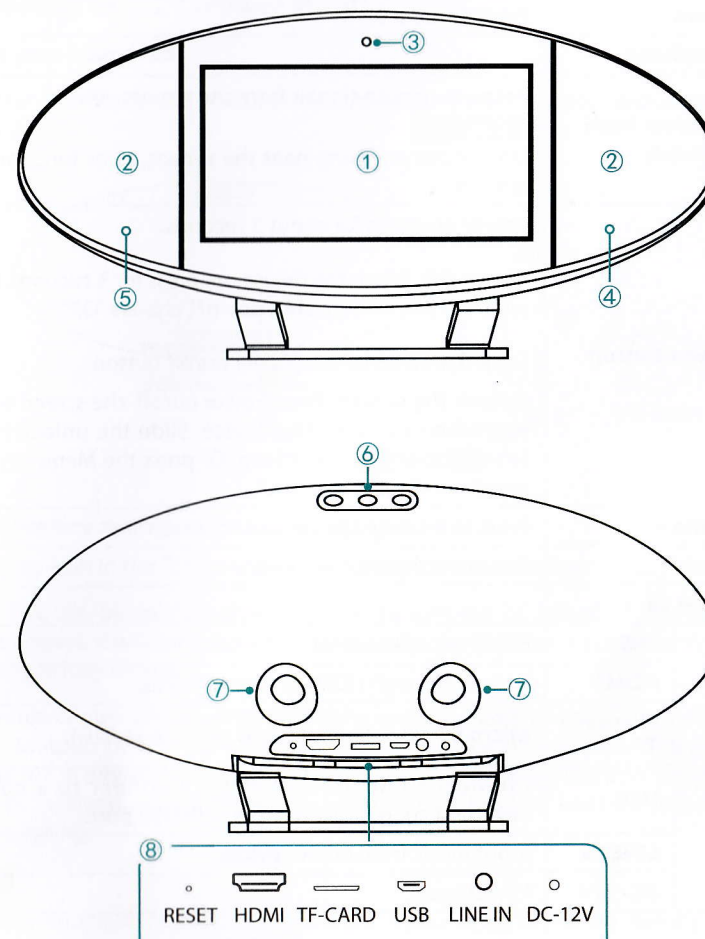

No	Item	Description
1	Screen	7 inch multi-touch screen.
2	Speakers	5W stereo speakers.
3	Camera	Front Camera 0.3 M
4	Microphone	
5	IR receiver head (Optional)	Receives remote signals from the remote control. NOTE Do not put anything near the sensor, as its function may be affected.
6	⏻ Power Button	Power on: Press for about 5 seconds. Power Off: When the device on, press for 3 seconds, it pop up with "Do you want to shut down?"; choose "OK". Lock the screen: Press Power on/off button Unlock the screen: Press Power on/off, the screen will be the way when you start the device. Slide the unlock button to left side to unlock the screen. Or press the Menu key in the IR remote controller to unlock.
	Volume +	Press to increase the volume.
	Volume -	Press to reduce the volume.
7	Airflow Vent	
8	Port	RESET RESET your SoundPad.
		HDMI Output through HDMI to other devices.
		MicroSD/TF card Micro SD port: Plug microSD card (up to 32G).
		USB Connect to Micro-USB cable. Connect to a computer, keyboard, more other devices with USB port.
		LINE IN Input music from other devices.
		DC-12V Power input

5 Making Connections

Connecting DC-12V (Power input)

Charge your SoundPad

Plug your SoundPad into a wall outlet using the power adapter included with your accessories.

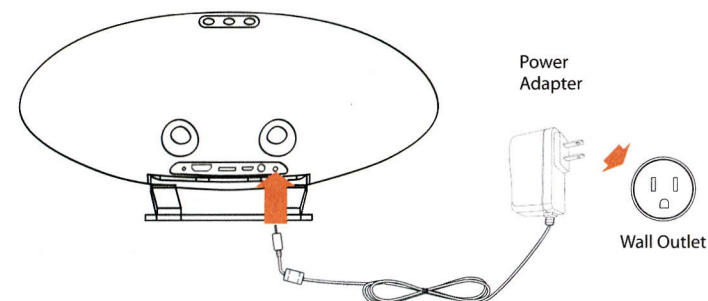

Built-in battery management and charging

- The battery icon in the Screen shows the battery level or charging status.
- For the first use, please fully charge the device with the DC adapter in the package. For the first 2 times, it will take about 6 hours for fully charge, after that it will only take you 2 to 3 hours to fully charge it.
- This device comes with Built-in Li-battery, and you have to choose our standard DC adapter (output: DC12V, 1.5A). If you charge the device when it shuted down, the battery icon will roll in white. If you charge the device when it works, the icon in right bottom will be in lightning shaped. When it is fully charged, the icon will turn to be full white, and stop rolling.

NOTES

- If long time no use, at least you need to use it to release all battery power, then full charged it before you put it away, so as to make the device much longer working life.
- If the SoundPad shutdown because of low power automatically, you need to wait for a little while to restart up the device until the device charged enough.
- If you keep the SoundPad working and charging at the same time, it will take longer time for full charging.
- If the SoundPad is out of enough power, the system will be shuted down automatically.
- This power adapter is only for reference, it may vary in different countries.

Connecting HDMI

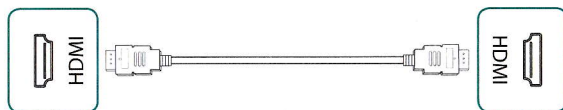

Supports digital connections between HDMI - enabled AV devices such as DVD, Blu-Ray, AV receiver and digital devices.

NOTE

Use TV\Projector\Monitor's HDMI connecting to the SoundTab, must mark **turn on HDMI** options in setting menu. The HDMI cable is not provided.

MicroSD/TF card

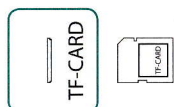

Insert the MicroSD/TF card contacts facing down into the SoundPad TF port.

To check the storage of MicroSD/TF card, go to Settings > DEVICE > Storage.

Connecting USB

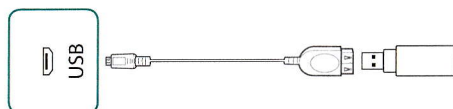

Connect the SoundPad and USB by using the USB OTG cable of your accessories.

LINE IN

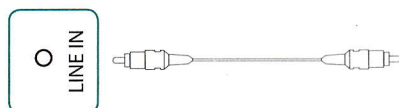

The SoundPad can be used as the external sound box of other devices; you can connect the LAN IN of SoundPad to the audio input/output jack of other devices.

(Please using the 3.5mm audio cable, not provided.)

RESET



Forced shutdown your SoundPad.

6 Basic

Using Touch Navigation

Tap or Double Tap



To select a feature or item, quickly touch the screen.

Double tap your finger quickly on an item to bring up more details.

Press and Hold



Touch the screen and hold it there for 2 seconds.

In many situations, pressing and holding will open a menu.

Slide or Drag



Touch the screen and slide your finger to another location.

Press and hold on an object and slide it to another location on the screen.

Rotate



Place two fingers about an inch apart on the screen. Rotate them in clockwise or counter-clockwise.

Zoom



Place two fingers about an inch apart on the screen. Slide them together to 'zoom out'.

Slide your fingers apart to 'zoom in'. Place two fingers about an inch apart on the screen. Slide them together to 'zoom out'.

Slide your fingers apart to 'zoom in'.

• Turning Your SoundPad On for the First Time

To start, turn on your SoundPad by pressing and holding Power button until the smart logo appears. After the animation appears, follow the on-screen instructions to set up your SoundPad.

• Unlock the screen

Press Power on/off, the screen will be the way when you start the device. Slide the unlock button to left side to unlock the screen. Or press the Menu key in the IR remote controller to unlock.

• Home Screen

Start the device and unlock the screen, you will come into the home screen.

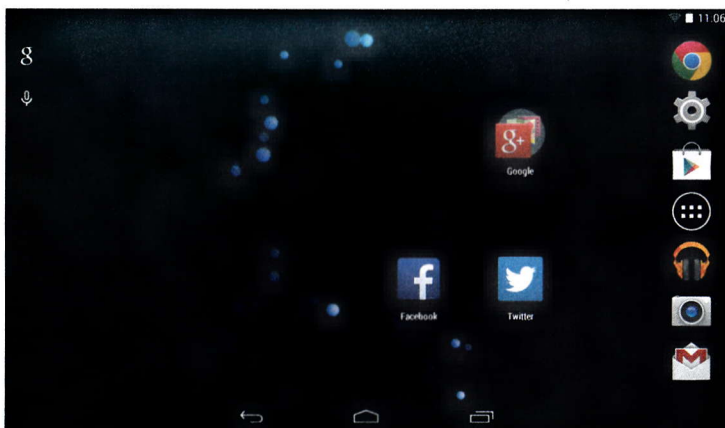

Notification and Status Bar

- At the top of the screen, you'll see indicators that inform you about the status of your SoundPad. You can open the Notification Tray or the Quick settings by pressing the Notification or Status bar and dragging it down.
- You can drag down the upper right Bar check the Notifications. The Notifications can come from the system, a game, an application such as E-mail, or the music player.
- The table below lists icons that appear the most frequently in the Notification and Status Bar.

Icon	What it means
Alarm	An alarm is set.
Alert	Install/update/enable Google Play service.
Wi-Fi	SoundPad has a Wi-Fi Internet connection. The more bars, the stronger the connection.
Downloaded	Received files
Uploaded	Sent files
Calendar	Task reminders.
Music	Play Music application is running.
Silent mode	Silent mode is on.
USB tethering	SoundPad has connected to a computer and the USB tethering is turned on.
Bluetooth	When Bluetooth connected with Phone or Tablet, the icon will turn light. You can disconnect it via turning off Bluetooth setting in your phone, or press the Bluetooth button in the remote controller, the icon will turn dark.

Expanding home screen

The home screen can be expanded to the outside of the screen to provide enough space for users for more Applications and tools etc. Press the black part of the home screen, slide fast from right to left, then you will get 5 expanding main interface.

Icons management

- In home screen, you can move the icons as you want: Tap All Apps button, open All Apps screen, press and hold an icon or widget and slowly to drag it to the location of your choice. This makes it much easier to change your Home screen layout.

- In the main menu, press one icon for a while that the icon will be created in the home screen.
- In home screen delete apps icon or widgets: Press one icon for a while, when the Remove "X" icon appears at the left of the screen, drag the icon or widget into it.

Shortcuts Menu

Press the black part for a while of the Home Screen, you can select wallpapers / widgets / settings menu.

↶ Back button

Tap this button to open the previous screen you were working in, even if it was in a different app. Once you go back to the Home screen, no further history will be available.

🏠 Home button

Tap this button from anywhere on your SoundTab to return to the Home screen. If you're viewing a left or right Home screen, this will open the central Home screen.

📱 Recent Apps

Tap this button to view recently used apps. Tap an app to use it again or close it.

⋮ Main menu

Press the Main Menu ⋮ button to enter the Main Menu screen. This is where you can see all your apps, including those downloaded from Google Play. You can tap the app to open it, drag the app or widget to the Home screen, or buy the app through Google Play Store. From All Apps screen.

7 Troubleshooting

When there appears to be an issue with your SoundPad, refer to the tips listed below for a resolution. If the problem still cannot be solved, then contact the local seller's Consumer Care Center or a professional technician.

• SoundPad displays network or service error message

- When you are located in places with poor signals, then your SoundPad may not be able to connect. Try to move to other places to get a stronger signal strength. If you do not make a reservation, some of the options can not be used. Please
- contact your service provider for more details.

• Touch screen response is slow or incorrect

If the SoundPad's touch screen response is incorrect, please try the following:

- Remove any protective film of the touch screen. The protective film may prevent the device recognition input.
- Make sure that your fingers are dry and clean before you tap the touch screen.
- Restart the SoundPad to clear any temporary software bugs.
- Make sure that the SoundPad's software has been upgraded to the latest version.

• SoundPad is frozen or a serious error appears

- If the SoundPad is frozen or suspended, you may need to close the app program or reset the tablet.
- If the SoundPad is frozen or slow to respond, press and hold the RESET for 8 seconds to reset the tablet.
- If the problem persists, restore the factory data.

• SoundPad gets warm

When you use your device for a long time, the SoundPad may be warm to the touch. This is normal and will not affect the life or performance of the unit.

• SoundPad no voice

When you play music or watch movie through the source inside SoundPad, or play music through connecting your phone or tablet via Line in, but no voice comes out, please check if the SoundPad is connected with your phone or tablet via Bluetooth. In Bluetooth mode, all voice is transferred via Bluetooth.

You can turn off the Bluetooth in your phone or tablet, or press the Bluetooth icon in the remote controller to disconnect it, then you can play music or watch music in SoundPad normally.



Appendix

Certification and Compliance

• Declaration of RoHS Compliance

ComplianceTo minimize the environmental impact and take more responsibility to the earth we live in, this document shall serve as formal declaration that the MA-327 is in compliance with the Directive 2011/65/EU of the European Parliament - RoHS (Restriction of Hazardous Substances) with respect to the following substances:

- (1) Lead (Pb)
- (2) Mercury (Hg)
- (3) Cadmium (Cd)
- (4) Hexavalent Chromium (Cr (VI))
- (5) Polybrominated biphenyls (PBB's)
- (6) Polybrominated biphenyl ethers (PBDE's)

(Compliance is evidenced by written declaration from our suppliers, assuring that any potential trace contamination levels of the substances listed above are below the maximum level set by 2011/65/EU, or are exempt due to their application.)

MA-327 meets the requirements of 2011/65/EU

• CE Certification

It is hereby declared that the following designated product:



Product Type: SoundPad

Model No.: MA-327

Complies with the essential protection requirements of the Radio and Telecommunication Terminal Equipment Directive (EC Directive 1999/5/EC).

This declaration applies to all specimens manufactured identical to the samples submitted for testing/evaluation.

Assessment of compliance of the product with the requirements relating to the Radio and Telecommunication Terminal Equipment Directive (EC Directive 1999/5/EC) was performed by Shenzhen NTEK Testing Technology, based on the following standards:

• Disposal and Recycling Information



The symbol means that according to local laws and regulations your product should be disposed of separately from household waste. When this product reaches its end of life, take it to a collection point designated by local authorities. Some collection points accept products for free. The separate collection and recycling of your product at the time of disposal will help conserve natural resources and ensure that it is recycled in a manner that protects human health and the environment.

Copyright and Trademark Notices

The Bluetooth® word mark and logos are registered trademarks owned by Bluetooth SIG, Inc..

Wi-Fi® is a registered mark of the Wi-Fi Alliance.

Android, Google Play and other marks are trademarks of Google Inc..

Screenshots and product images are simulated and for instructional purposes only. They may differ from the actual product and are subject to change without notice. Content shown may vary from actual available content, which may change without notice.