

# WiFi Music Streaming Receiver

Model: M1

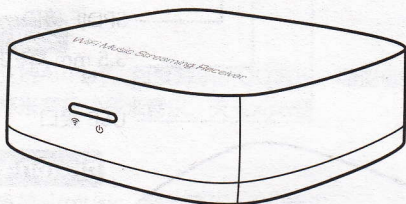

## M1快速使用指南

## Interface

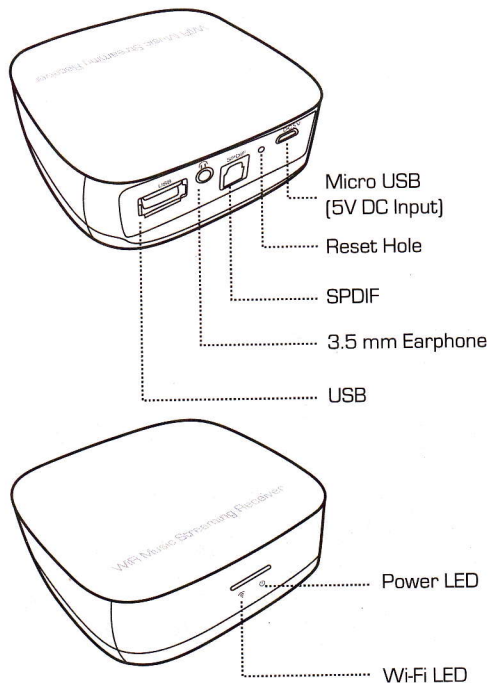

## List of items

- Wireless Music Adapter
- AUX Cable
- USB Cable
- Quick Start Guide
- RCA Audio Cable

## App Support

### iOS

No app is needed, you can stream music directly by AirPlay on the menu or some other online music app with AirPlay function.

### Android

For Android Device, you have to install App to do the work. some App with DLNA Function can do it well. such like: Air Buddy, All Cast, BubbleUPnP, ShareOn, UPnPPlay, iMediaShare, N7 Player, Air Music etc.

### PC

Support iTunes, Windows Media Player and other programs with DLNA Functions

### Apps



Airaudio



AllStream



Air Buddy



Air Music



All Cast



UPnPPlay



BubbleUPnP



Play Music



N7 Player



ShareOn



ToasterCast



Spotify

## Protocol Support

M1 supports the AirPlay, DLNA, QPlay Protocol, Streaming local or online music via M1 to a speaker.

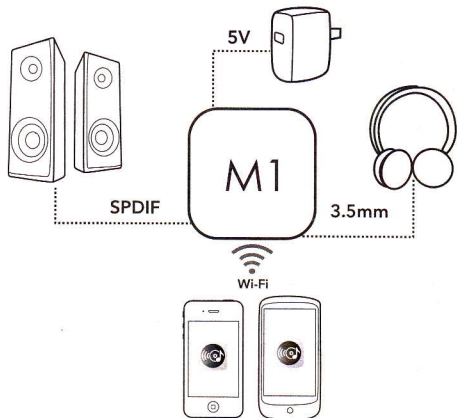

## How does M1 work?

- 1** Connect a 5V DC power supply to the M1, then M1 will automatic startup.
- 2** Connect the M1 to a speaker or any other sound squipment by an earphone cable or SPDIF cable.
- 3** Connection between device and M1 (support both iOS & Android) to the M1 by Wi-Fi
  - [1] Connect M1 by Wi-Fi
 

Enter into setting -> WLAN, search Wi-Fi signal[ soundmate\_xxx ], choose, then connect.

\* Wi-Fi signal SSID can be found on the backside of M1.please refer to the product.

## [2] Internet Connection

- 1 Type IP address "http://192.168.222.254" to the browser on your devices, enter the control platform
- 2 Enter Internet Connection option, find your router that is able to get access to Internet, choose the router and enter password, then M1 will be able to get access to Internet.

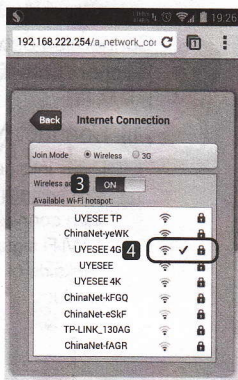

## 4 Network connection mode

### [1] Direct connect (Gateway Mode)

- 1 Smartphone scans WiFi signal, connect to M1, then streaming music.
- 2 In control platform, setting M1 connect to router, can make all the devices which connect to M1 to visit Internet. then you can streaming online music.

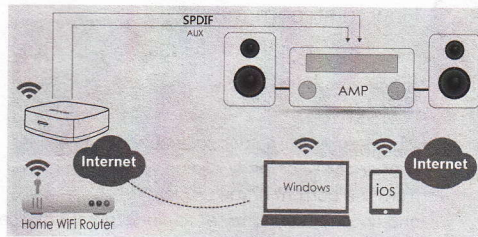

### [2] By router relay (Client Mode)

- 1 Smartphone connects to M1, setting M1 connect to router.
- 2 Disconnect the smartphone from the M1, connect smartphone to router, at this time you can also streaming online music.

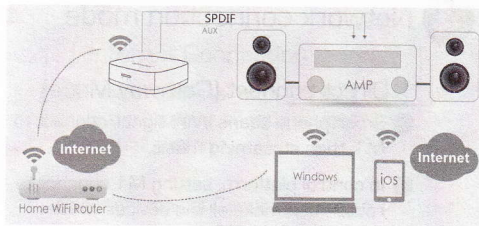

## 5 How to stream music

### [1] iOS Streaming Music

#### iOS7 Device

Please refer to the previous connection steps, connect M1 correctly, sliding your finger up from the bottom of the display. Type "AirPlay" and choose "soundmate" as audio output device, all music of the iOS device can be outputted from M1.

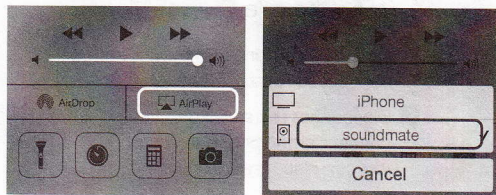

#### iOS6 Device

Please refer to the previous connection steps, connect M1 correctly, press "Home" button twice quickly to activate the taskbar, slip to the left, you can see "AirPlay", type  and choose "soundmate" as audio output device, all music of the iOS device can be outputted from M1.





## [2] Android Streaming Music

Any app support DLNA, QPlay Protocol can stream music via M1. in this case we use ShareOn Audio to explain how to use.

- 1 Please refer to the previous connection steps
- 2 Download "ShareON Audio" form Google Play store.
- 3 Play a song, then enter into the Now Playing page, press the Speaker iCon in the upper left corner, choose "soundmate", then music can be outputed from M1.

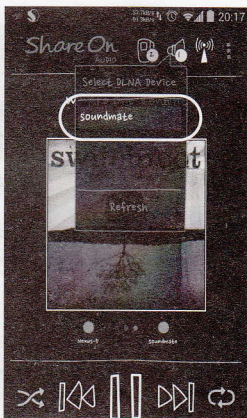
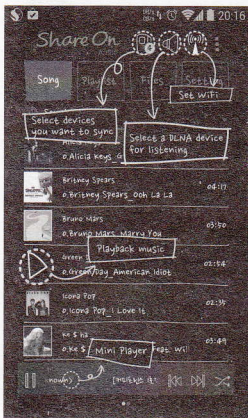

Note: To stream online audio content, it will only work on the condition that those apps support DLNA, AIRPLAY protocol.