

# User Guide

## Solar Motion light

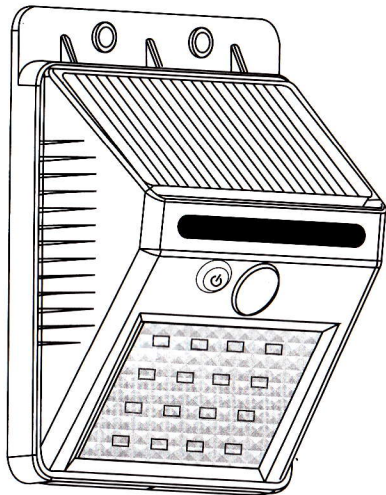

01

Please read the user guide before use and keep it properly

### Features:

- Easy to install it on walls, trees, metal and glass.
- Using grade A+ battery cells, large capacity, long standby.
- Intelligent sensing system provides overcharge, over voltage, short circuit and more security protection.
- Auto-sensing: Detecting light brightness and human motion automatically.
- Mode conversion: when it sensing all around is too dark, and human movement, it enter to bright light mode automatically, it delays 30 seconds when people walk out of its sensing range, then it turn off.
- Even sensing body motion in a brightness sufficient place, the light will not turn on.
- No wiring, solar power, Convenient and safe.
- Housing material is high quality ABS+PC, Dustproof and rated Ip65 waterproof, perfect for outdoor using.

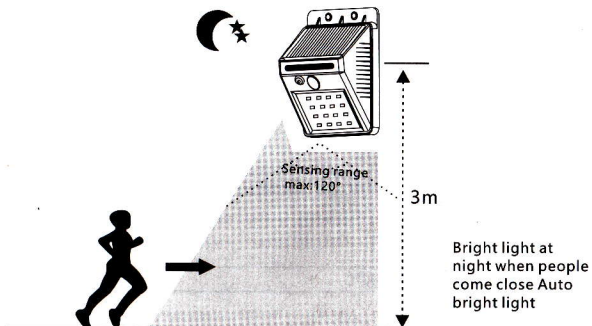

## Illustrations

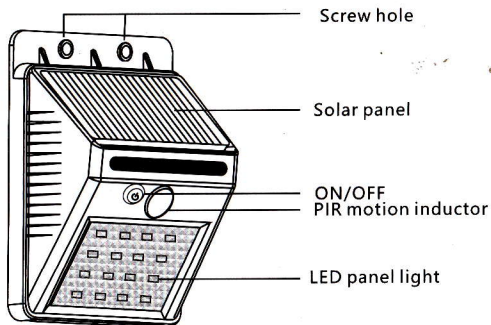

## Specification:

Solar panel	5.5V 0.75W
Power	1W
Color	Black
Weight	0.23kg
Size	L105*W53*H138mm
LED	16LED
Sensor mode	Light sensor & Motion sensor
Sensor angle	90°~120°
Sensitivity distance	3M
IP Rating	IP65
Working temperature	-5~60°C
Housing material	ABS

## Fixing instructions:

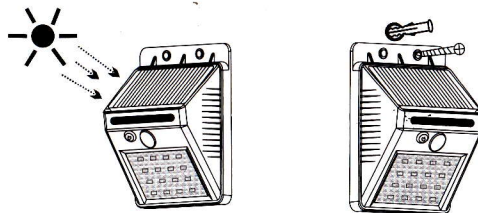

1. Choose a place that make sure the solar panel can absorb sunlight (within 3 meters height)
2. Install standard plastic screws into wall, then using metal screws fix LED solar sensor light.

## Maintenance:

- When it not lit
  1. Confirm switch is on or not.
  2. Confirm whether it is being continuously used in a long-term and no charge, recharge it timely before use again.
  3. Make sure people moving within the sensing range.
  4. Make sure the solar sensor light being installed within 3 meters height.
  5. Confirm installation direction is correct (solar panel should be facing up).
  6. Confirm no objects blocking it and solar panel can receiving sunlight.

## Cautions

- Keep away from fire.
- Please keep the solar panel facing up, Do not install it upside down.
- Do not immerse in water.