

## Dial the Number

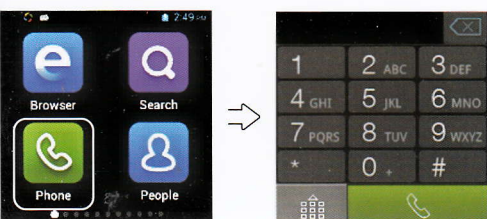

You can use the virtual keyboard to dial the number directly, also dial by searched contact list numbers. It support the search contact name by first letter of the name, part letters of the name, full spelling of the name and also by phone number; The search results will sequence by matching level.

## Sent SMS

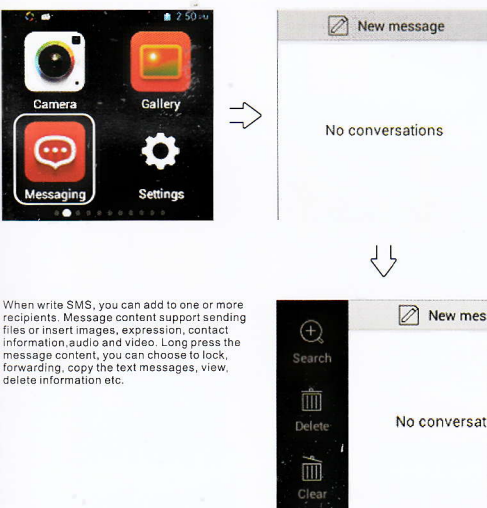

When write SMS, you can add to one or more recipients. Message content support sending files or insert images, expression, contact information, audio and video. Long press the message content, you can choose to lock, forwarding, copy the text messages, view, delete information etc.

## Write mail

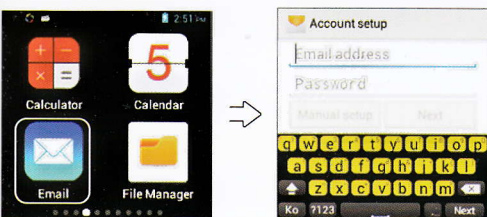

After setting up your e-mail account, you can use the watch to send mail. You will receive the first time reminder when a new mail in.

EN

中文

## WELCOME TO USE

## Key instruction

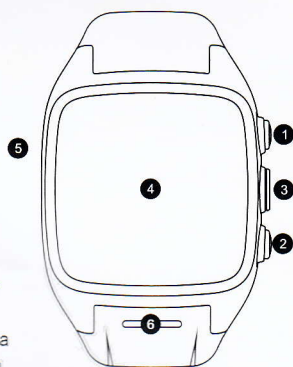

- 1 On/Off
- 2 Home
- 3 Camera
- 4 Screen
- 5 Microphone
- 6 Speaker

Remark: Keep Pressing "On/Off" button to start the watch  
Keep Pressing "On/Off" button to power Off the watch

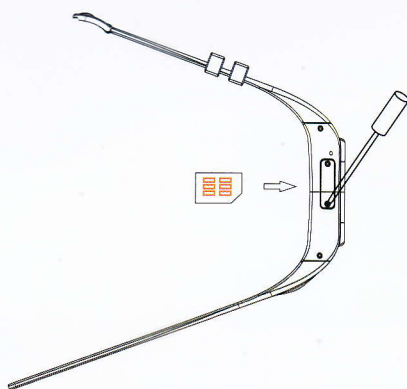

## 1 Insert the SIM card

Warm Tips: Pls ready the followed parts for the first using of our watch: 1 Mini SIM card, 1 screw-driver (included in retail package), wireless network, 1 android smartphone

## Key instruction

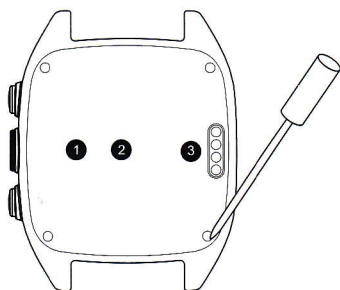

- 1 Insert the battery
- 2 Insert the T card: Fix T card after taking out the battery
- 3 USB

Warm Tips: Pls ready the followed parts for the first using of our watch: 1 Mini SIM card, 1 screw-driver (included in retail package), wireless network, 1 android smartphone

## Screen Unlock/Lock

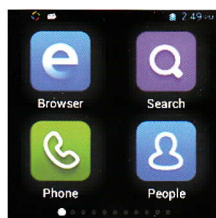

In the screen lock state, slide towards any direction with the fingers touching the watch screen that can unlock the screen. And just tap the "power on/off" button that can lock the screen.

## The Dial Settings

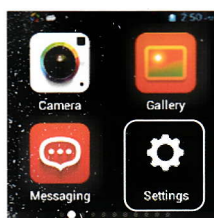

Open the dial setting application, browse the dial, choose your preferred dial display. And you can set the dial after tapping your preferred dial display. After the setting, it will pop up a message to say with success. Then you can choose to continue browsing or exiting.

### Remark:

Date and time settings: Open "Settings" -> "System" -> "Date and Time", click "Determine the date and time automatically", choose to use the network time, or GPS time, or closed with manually setting.



## Hand Gestures

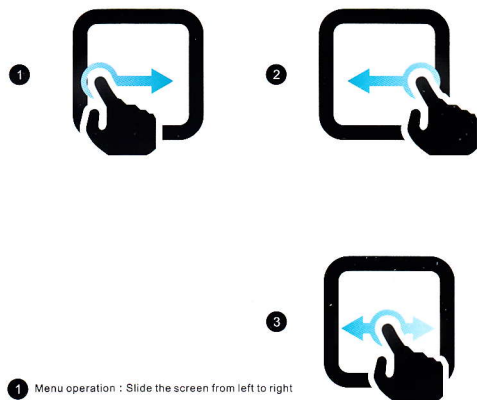

- 1 Menu operation : Slide the screen from left to right
- 2 Returns operation : Slide the screen from right to left
- 3 The sliding operation : Sliding left or right to switch pages on the screen with your fingers

## Contact list

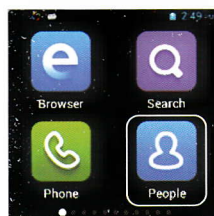

When first use, please select the way of import contacts. We support various ways to add contacts. You can import a phone card and SD card contacts, or set the synchronization account, can also direct new contacts. You can manage the contact lists in detail by pressing the menu button at the bottom.

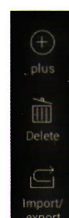

## Take photos or video

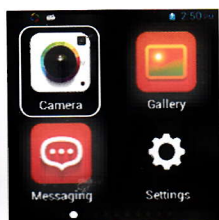

Open the camera program to take photos, which support continuous capture mode and time-lapse mode. To take video, you only need to slide virtual key to the camera icon.

## Voice assistant

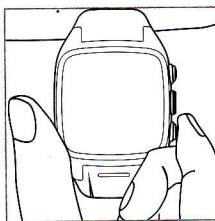

Long press "home" button to start in the voice assistant status. Use your voice to make call, to send message, to start apps. When the voice direction be confirmed, you can cancel it in 3 seconds.

## Gallery



The gallery program support reviewing picture according to the folder path, you can click the picture to zoom the selected single picture, you can also click on the left or right to switch up or next a picture; And when you click the picture you can find the showing or hidden menu control function.

## GPS Navigation

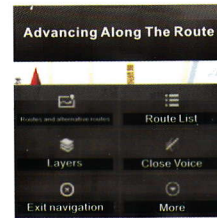
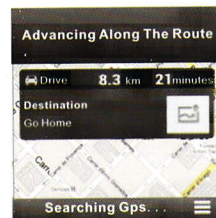
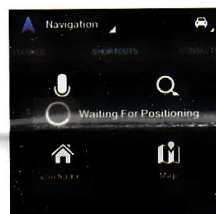
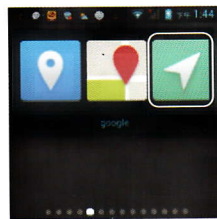

## Music

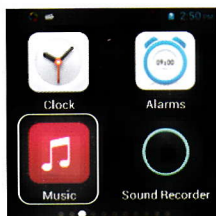

Music program support playing the local music. If you need to play online music you can download network music player, such as KuGoo, DuomiMusic etc. It can play music by the song name, artist, album, playlist of different modes, and also with variety of sound effects for your choosing.

Open the navigation software (Google map or Baidu map), click to choose navigation way, you can choose: 'tell the destination "or" input destination ". It will run navigation operation after positioning.

## Change Wallpaper

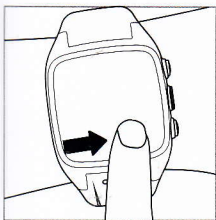

1. Long press on the blank of the main screen (desktop), there will pop up "the choice of wallpaper sources", you can replace your preferred wallpaper here.
2. To replace the wallpaper you can open "setting" -> "equipment" -> "display" -> "wallpaper", and then change the wallpaper.
3. You can also slide in the main screen from the left to right, then find the "wallpaper", click and change the wallpaper.
4. You can also find directly in the gallery on your preferred picture, and then set it as the wallpaper for watch.

## News and Weather



Open the application, you can acquire newest news information and weather conditions

## Internet

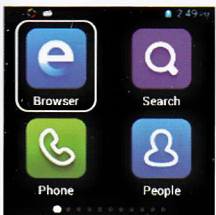

The browser supports double-click or two fingers to zoom webpage toggle. Intelligent full screen with browsing area in best fitting.

## Message Checking

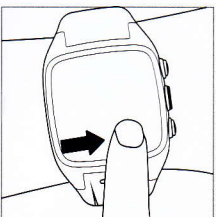

When you have new notification on call or SMS etc., you can slide down to view the details. There is quick switch button on the top notification bar, and you can slide to choose more switches.