

Instruction For Use

Heating CUP For Car

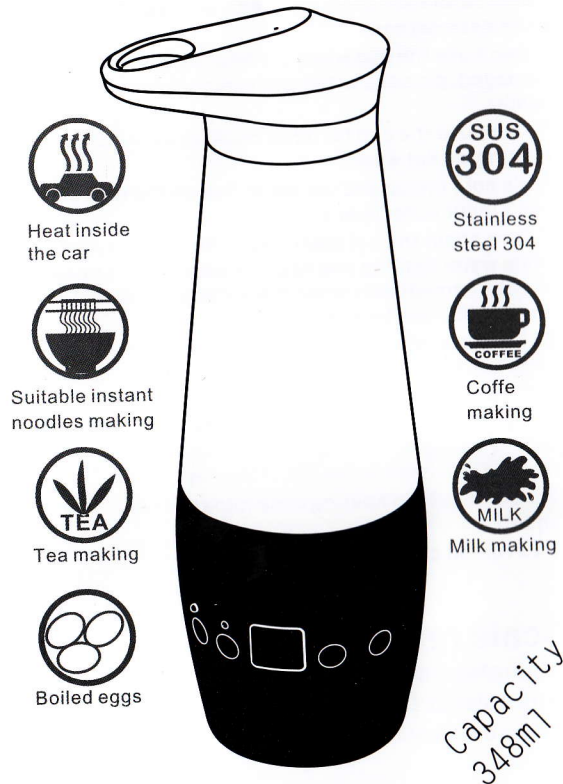

Heating Cup For Car

Product Specifications

1. Model Name: heating insulation Cup
2. Material: stainless steel 304
3. Cup capacity: 348ml
4. Rated voltage: DC 12V
5. Rated power: 80W&120W
6. Product net weight:530g
7. Product weight:618g
8. Package size:310mm*112mm*92mm
Carton Size:470mm*320mm*239mm
(10Pcs/ Carton)
(15,750 pcs/12M container)
(13,860 pcs/10.5M container)
(7,560 pcs/5.89M container)
9. The water heating time: 16 minutes
(320ml 20°C -100°C)
10. Digital temperature display.
11. Thick film heating technology fast heating cup of water, it can increase the heating performance.
12. 2-layer 304 stainless steel vacuum cup body, can greatly reduce the cooling rate and streng-then the warm keeping.
13. Food grade silicone rubber used for safety and soft-touch feeling and keep the body warm.
14. Ergonomic design, product design patent.

Heating Cup For Car

Specify product parts

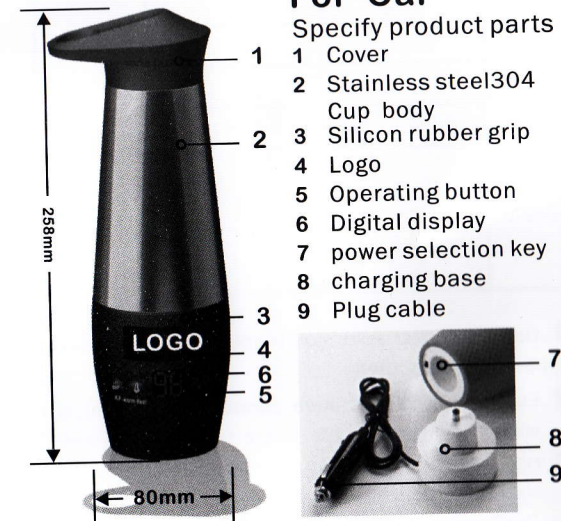

Operation Instruction

- 1 HEAT key
- 2 Heating lamp (red)
- 3 Keep warm key
- 4 Keep warm lamp (green)
- 5 Temperature display digital
- 6 Temperature controller

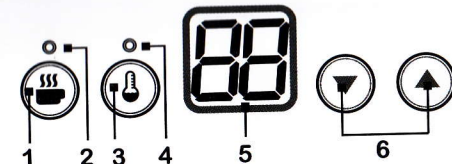

Maintenance card

The Buyer	Name			Maintenance time: one year
	Address			
	Phone			
	Purchase date			
check		Merchants		

1. One year after sold maintenance under normal operating condition;
2. Exceeding the guarantee period, reasonable payment will be charged for the spare parts replacement.
3. During the warranty period, under the following circumstances will not be free maintenance:
 - a. Can't provide Guarantee Card
 - b. The damage caused by assemble or modification
 - c. Damage caused by wrongly operation or on purpose
 - d. Damage caused by wrong using condition and environment.
 - e. Appearance damage and dirty

Operation Instruction

1. Electric cup on the right amount of water ;



2. Heating :

Press the "  " button and lamp turns on Red. Start heating and the display will show the actual temperature. When the display shows 99C, the water boiling done and the indicator goes off in seconds.

3. Keeping Warm

Press the "  " button and lamp turns on Green. Set the keeping temp. by the temp. controller. The default temp. is 60C. The display will alternately show the setted temp. and the actual temp. The setted temp. will be automatically remembered before you reset it.

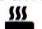
4. Heat and Warm

Press "  " and "  " button at the same time, the heating lamp turns Red and the KP Warm lamp turns Green. When the water get boiled and keeping warm function will automatically run. The display will alternately show the setted temp. and the actual temp. The setted temp.

5. The insulation(KP warm) temperature setting :

Press the up and down buttons, set the temp. you want to keep. The setted temp. Will be automatically remembered. Remark: The operation can only be done under the KP Warm situation.

Function code

- E1 Voltage is too low
- E2 Voltage is too high
- E3 The dry cup no water
- E4 Ambient temperature is too low
- E5 Water temperature thermostat failure
- E6 Hot plate temperature probe failure
- E7 Power is low

warning

1. Check the cup before plug into the power outlet. Pls don't use the cup when the car stay in power off;
2. The cup can only be used with the original heating base.
3. Keep the heating base dry and don't connect power before you dry it with cloth or tissue paper if the base get wet.
4. Don't use the cup when the heating base get damaged, pls send to the professional maintenance center.
5. Don't use the cup for other liquid or even solid heating except water.
6. Pls note the up and low water line on the cup, and don't input water over the limit.
7. Care about the hot steam from the steam outlet while water heating and keeping warm. Don't open the cap immediately when the water get boiled, and caution for the scald.
8. Hot water may cause severe burns, such as heating cup hot water, paying particular attention to the safe use;
9. Heating and insulation, the water level in the cup should be higher than 10mm or more, to avoid cup dry heating and reduce the life of the cup;
10. Don't put the heating base into water and other liquid
11. Prohibit children to use it.

Scale removing

Mixing the vinegar and citric acid and input the cup with water at 1:1 to the 1/3 position. Immersing 8-10 hours and clean it. Normally one time per month.