

*Multi-function AUTO
emergency start power*



Auto start



High security



Mobile power
supply



Emergency
lighting



Compact

Product date sheet



*Multi-function AUTO
emergency start power*



Friendly
tips:

Please carefully read the instruction manual and use the product correctly based on the instruction manual so that you can be familiar with the product more conveniently and quickly!

Answers for common problems in use of product

Question: which functions do start power supply have?

Answer: five in one. It supports power charge/supply for mobile phone, laptop, PSP, MP3/MP4 and other electronic products; possessing lighting function of different modes, it can also guarantee emergency start for auto!



Question: how can LED emergency lighting be turned on?

Answer: turn master switch of start power to "ON" and press ● for 3 seconds to start flashlight function. Afterwards, press ● LED function to turn normal on to flickering, SOS distress signal light; press ● again to directly turn it off. See the figure below:

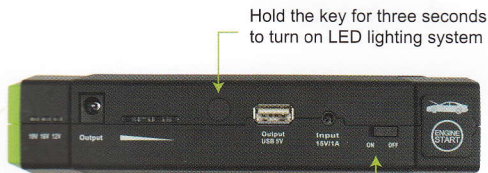

Turn start power switch to "ON"
If it is not used for long time, turn it to "OFF"
to guarantee no failure of power supply.

Question: the start power supply has 19V, 16V and 12V output functions and how can V number be switched?

Answer: yes; the start power supply can guarantee several V number selection. Before charging with start power supply, press ● for short time to switch among different V numbers and corresponding indicator lights are normally on. Different products use different voltages, e.g.: laptops generally have 19V and 16V. Before use, please confirm product V number, such as shown in the figure below:

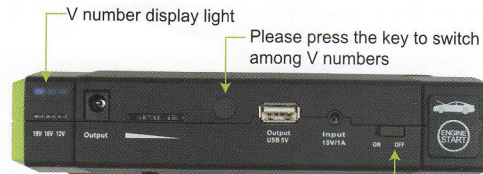

Turn start power switch to "ON"

Question: how much time is taken to charge the start power supply?

How can mobile phone and tablet PC be charged?

Answer: it shall take 2-3 hours to charge start power supply. After master switch of general start power supply is turned ON, press ● @ button lightly and USB indicator light maintains normal on. By this time, you can charge mobile phone, tablet PC and laptop!



Turn start power switch to "ON"

Question: how can an auto be started?

Answer: if an auto cannot be started by the storage battery because of various reasons, the start power supply can exert supernatural effects. At first, inspect electrical quantity of start power. Generally, the auto can be started when there is one check display of indicator light. Connect positive and negative polarities of storage battery with positive and negative polarities of storage battery. After red polarities and black polarities are clamped, insert plug of battery terminal into start outlet of start power, turn auto key to start shift to start auto. If the auto cannot be started, turn the key after several seconds until it is started successfully. Afterwards, pull storage battery plug from the start power supply and remove clip from auto battery.

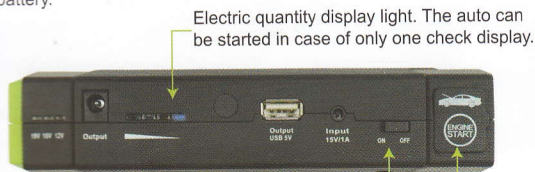

Question: in case of misoperation, what shall happen in case of contact between positive and negative polarities of storage battery wire clip?

Answer: someone may connect positive and negative polarities of storage battery and cause short circuit owing to negligence, we have designed protection circuit. In case of any short circuit, the fuse shall blow out immediately to prevent any unnecessary personal injury and property damage. Afterwards, you can send the start power supply to the purchase area for maintenance.

Question: how can start power supply be started?

Answer: insert matched adapter/charger into charge inlet of start power supply and the other end is connected to 220V commercial power or 12V car power supply, product charging is started. Circular flickering of electric quantity indicator light indicates that the device is under normal charging process. When four indicator lights are on, it indicates the power supply has been fully charged! Such as shown in the figure below:

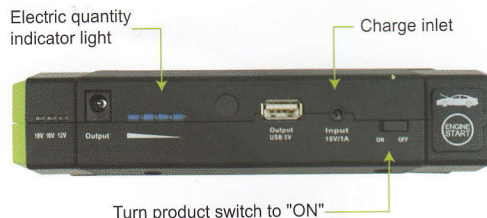

Question: how can power be supplied to laptop?

Answer: turn start power supply to "ON" and adjust power supply voltage to adapter voltage of laptop (in case of 19V voltage at adapter, lightly press key to switch to 19V). Afterwards, insert adapter power plug into output power interface of laptop (in case of wrong interface, please use interface adapter of laptop).

To supply power to laptop, it is suggested to remove laptop power supply at first to increase the service life!

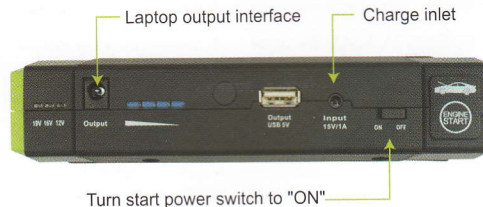

> Detailed illustrative diagram of product function

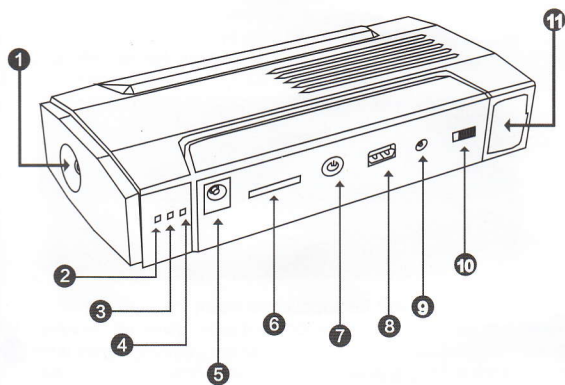

- | | |
|---------------------------------------|---------------------------------------|
| 1. LED illumination light | 2. 19V voltage output indicator light |
| 3. 16V voltage output indicator light | 4. 12V voltage output indicator light |
| 5. 12/16/19V --- 2A/3.5A/3.5A outlet | 6. Electric quantity indicator light |
| 7. Key switch | 8. USB 5V --- 2A outlet |
| 9. 15V --- 1A charge inlet | 10. Master switch |
| 11. 12V --- 200A auto start outlet | |

> Detailed fittings of product



Car charger



Laptop adapter



Carrying bag



Storage battery wire clip



Four-in-one mobile phone adapter



Power adapter

Correct operation flow for auto start



Red clamp connect " +"
Black clamp connect " -"

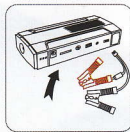

The plug connect the
jump starter



Start the vehicle

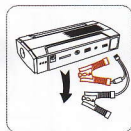

Remove the plug from
the jump starter

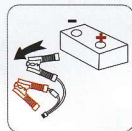

Remove the clamps
from the battery

Operating instruction:

To start auto, please confirm at first that electric quantity of start power supply is equal to or above 20%. Clamp red clip with positive "+" polarity of storage battery and black clip with "-" polarity of storage battery, afterwards connect the connecting wire of storage battery with start power supply. Turn auto start switch to START position. Afterwards, pull off plug from start power supply and then take down storage battery clip.

Product parameter

- ▶ Output voltage at auto start end 12V
- ▶ Dimension: 165*79*40mm
- ▶ USB output: 5V2A
- ▶ Charge mode: CC/CV 15V1A
- ▶ Start current: 200A
- ▶ Peak current: 400A (3S)
- ▶ Cycle life: 3,000 times
- ▶ Applicable temperature range: 0-85 C

Notice

1. In case of dormancy for long time, it is suggested to maintain certain battery capacity and the product shall be charged at least at every three months.
2. During service or charging process, mild heat of equipment is normal phenomenon but not fault.
3. It is suggested to use the product under room temperature environment away from moisture, high temperature or ignition source.
4. Please store products in dry area away from moisture and erosive materials.
5. Do not use coarse chemicals for cleaning, such as soap or detergent.
6. In case of battery inflation, leakage or peculiar smell, please stop using battery immediately.
7. Do not drop products in use.
8. Children shall use the battery under instruction of parents in strict accordance with specification contents to guarantee correct operation.
9. Please do not throw about or burn waste mobile power supply and cherish environment.