



T H R E E
PROOFINGS W5

User Manual

KENXINDA TECHNOLOGY CO.,LTD



Table of Contents

Safety Information.....	3
Appearance and Key Function.....	7
Introduction.....	9
Call Functions.....	11
Notifications Bar.....	12
Contacts.....	13
Messaging.....	14
Bluetooth and Wi-Fi.....	15
Download.....	16
Internet.....	17
Play Store.....	18
Camera.....	19
Gallery.....	20

Music.....	21
FM radio.....	22
Sound Recorder.....	23
Calendar.....	24
Alarm Clock.....	25
Settings.....	26
Maintenance and service.....	27

Safety Information

Please carefully read the terms below:

Use Safety

Do not use the phone in situations where it might cause danger.

Transportation Safety

Please observe all transportation laws or regulations.

Please drive with both hands on the wheel.

PLEASE DRIVE RESPONSIBLY-DO NOT TEXT AND DRIVE.

Hospital Safety

Please follow hospital rulers and limitations.

Please turn off your mobile phone when near medical instruments.

Airport Safety

Remember to follow all airport and flight safety regulations.

Please do not use your phone during flight.

Chemical Warning

Do not use your mobile phone around fuels and chemicals.

Temperature Warning

Do not subject your phone to extreme temperature conditions.

Water Hazard

Your phone is not waterproof. Keep it away from water and liquids.

Emergency Calls

Make sure your mobile phone is switched on and in a service area. In home screen, tap the phone key and dial the emergency number.

Accessories and Batteries

Use only KENXINDA batteries and accessories.

Information Backup

Remember to keep a written record of all-important information.

Battery Safety and Precautions

-For better performance and longer battery life, it is recommended that you charge the battery fully before using the mobile phone for the first time.

-The optimum performance of a new battery is typically achieved after two or three complete charge cycles

Note: Keep in mind that continuous overcharging will affect long term battery life.

-While charging, keep the mobile phone out the reach of children.

-Store the battery in a cool and dry place away from sunlight and water.

-Do not expose batteries to extreme temperatures(below-8°C(18°F) or above 43°C(110°F)).

-Immediately stop using the battery if it produces an odor, cracks and leaks, overheats, distorts or has any other type of physical damage.

-Avoid using the charger near or around liquids. If the charger comes in contact with the water or any liquids, immediately unplug it from the outlet to reduce the risk of overheating, charger malfunction, electric shock or fire.

Warning: Please be careful with the disposal of used batteries. Do not throw away the batteries with daily waste. Please follow local environment laws and guidelines for proper waste disposal.

Appearance and Key Function



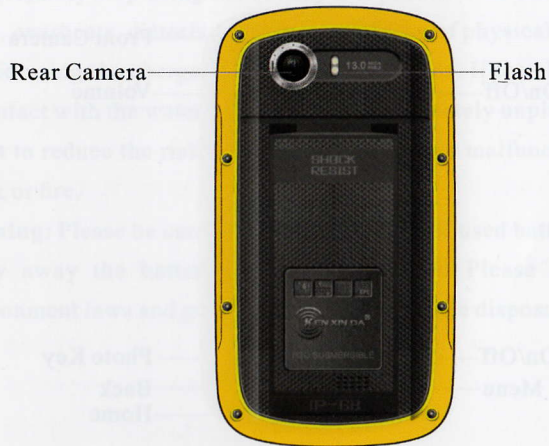

Introduction

Installation of the SIM card

Advisory: Please keep the SIM card out of the reach of children. The SIM card and its contact are easily damaged due to scratching or bending. Please use caution when carrying, installing or taking out the SIM card,

NB: Please contact your cellular phone service provider directly to obtain your SIM card.

To insert SIM card:

1. Remove the rear cover. Insert the SIM card.
2. Insert the SD card. (For additional storage capacity)

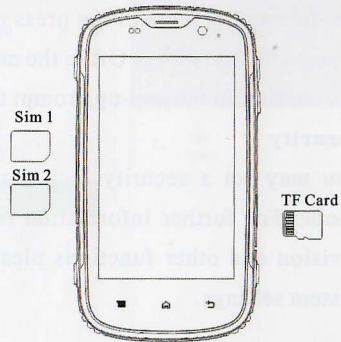

3. Insert the battery, replace the rear cover, and power on phone.

Power On and Off

On-Please ensure the SIM card has been properly inserted into the phone. Long press the Power key to switch the phone on.

Off-In standby mode, long press on Power key until an options menu appears. Select Power Off in the menu and confirm in the pop-up prompt to switch off the phone.

Security

You may set a security lock feature as a security measure for the phone. For further information regarding password locks, password revision and other functions please enter into the security option in system settings.

Call Functions

At the dial keyboard, enter the phone number and then click the dial key.

Call logs: Every telephone number called and received will be saved in the phones call log. All the numbers in the call log can be dialed directly by clicking the dial icon on the screen.

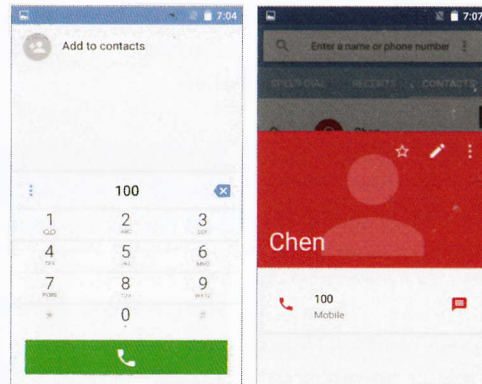

Notifications Bar

The notification bar is located on the top of the screen which Contains useful and important information regarding your phone and the applications that are installed.

For example, if the USB plug is inserted, it will show- “USB connected”.

Notification Settings:

The settings window provides shortcuts to different phone settings for quick access. Click on any of the shortcut notification icons to power on/off. card.(For additional storage capacity)

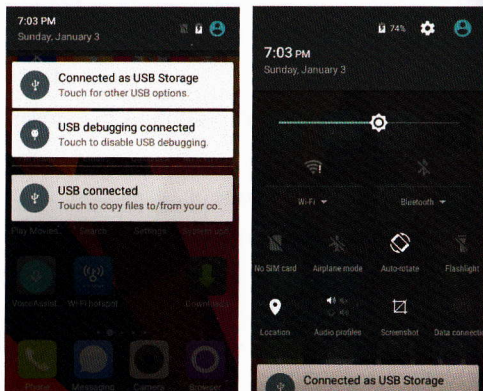

Contacts

Click on the applications menu and select people.

The default display is the phone contacts, the Contacts are listed alphabetically by default.

Select any contact, the dialing options will be shown. Click the add contact icon (+) to add contact.

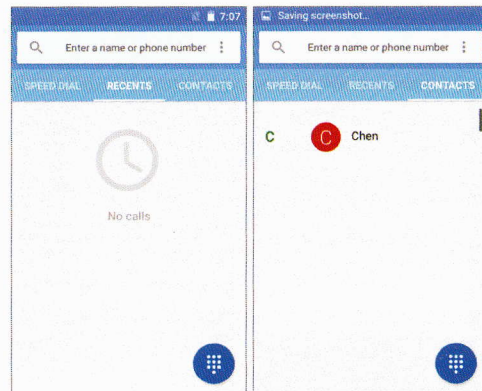

Messaging

You will find the messaging icon at the bottom of the surface, click the messaging to edit your text and send to your family or friends.

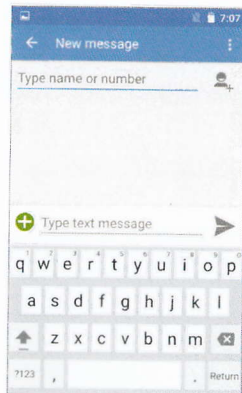

Bluetooth and Wi-Fi

Power on Bluetooth:

Settings>Bluetooth and select to power on Bluetooth.

The Bluetooth icon will appear in the notification bar, then it will start to scan for all devices within its range and will display all available devices in a list.

Power on Wi-Fi:

Settings>Wi-Fi and select ON to power on Wifi. Click on the desired Wi-Fi network to be connected.

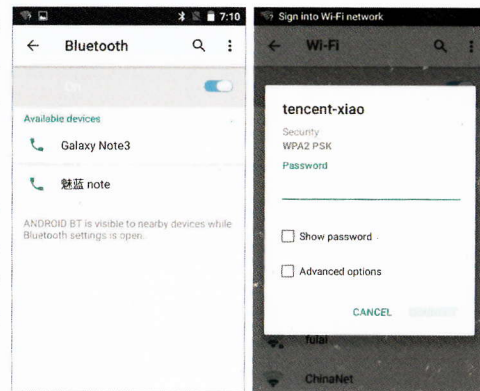

Download

Visit Google website to download application or file, and it will display what you are searching for.

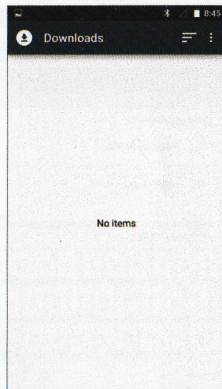

Internet

Before you browser something, ensure that you are connected with internet. Once it is ok then you can do the searching.



Play Store

Google play allows you to download music, movies, and games directly to your device. To access the Google Play Store, click on the applications menu and then the Play Store Icon.



Camera

Open Camera: you may place a camera shortcut icon on any of the screens.

Take pictures: Aim the object that the picture will be taken.

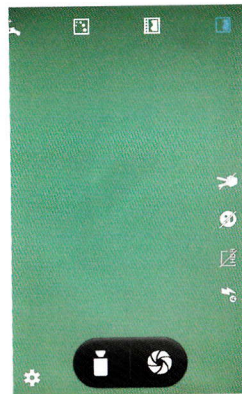

Gallery

Open images: Application Menu>Gallery.

Pictures are stored in separate albums.

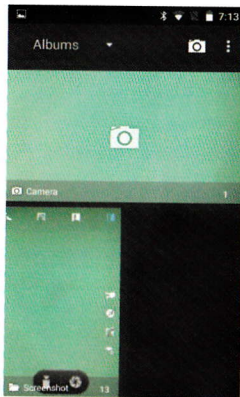

Music

Open Music: Application Menu>Music

Music is sorted by different files such as Artists, Albums, Songs, Playlists, choose one of the songs, click it, it will play.

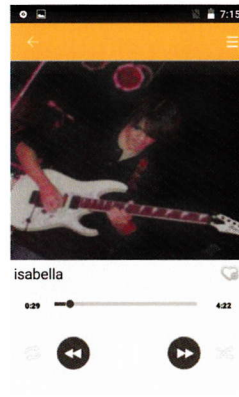

FM radio

The FM radio uses the wired headphones as an antenna in order to receive signal. Before using this function, connect the original equipment headphones that came with phone.

Open FM radio: Press the FM radio icon to open the application;

Click to scan FM Channels automatically then click to add any of your favorite radio stations.



Sound Recorder

Open Sound Recorder: Application Menu>Tools>Sound

Recorder Recording:

Keep the phone's microphone near the sound source;

Click the record button to record the audio;
Click the stop button to stop recording the audio.



Calendar

The calendar helps track of your life's most important moments in one application.



Alarm Clock

Click on the Clock icon then click the alarm tab to enter the alarm clock set surface. This option allows you to add and edit alarms.

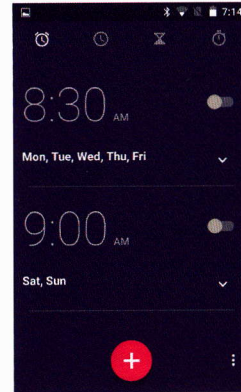

Settings

Open Settings on the Application Menu. Click any functions you want to set.

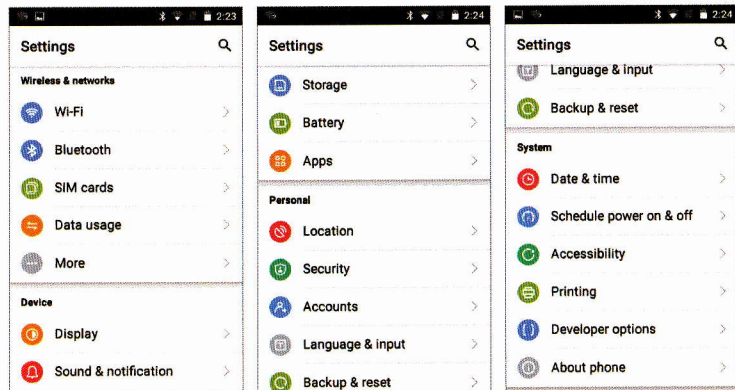

Maintenance and service

Your equipment is a product with exquisite design and process. Please use carefully. Following are some suggestions for you to effectively use the maintenance service.

1. Keep the equipment dry. Rainwater, moisture, other liquids or moisture contents may contain mineral matters, which may erode the electronic wires. If the equipment is wetted, please take out the battery till the equipment is totally dried and then put in the battery.
2. Don't use or store the equipment in dusty or filthy places; otherwise, the detachable parts and electronic elements may be damaged.
3. Don't put the equipment in overheated places.
4. Don't keep the equipment under cooled places; otherwise, when the temperature rises to normal, moisture may be generated within the equipment, resulting in damage of the circuit board.

5. Please open the equipment as per the descriptions in the manual. Don't try any other means.

6. Don't throw, knock or shake the equipment. Any rough treatment of the equipment may result in damage of the inner circuit board and its exquisite structure.

7. Don't clean the equipment with ardent chemical, detergent or strong wash.

8. Don't paint any dyestuff on the equipment. Painting may block foreign substances in detached parts and thus affect the normal operation.

9. Clean the lens with clean, dry soft cloth (such as the camera lens, distance sensor and light sensor).

10. Only use matched or approved antenna for substitution of the

damaged one. Unapproved antenna, alteration or accessories may result in damage of the equipment.

11. Please use the charger in indoor area.

12. Back up data that should be kept (such as the address directory and calendar memorandum).

13. Please turn off the equipment and then take out the battery to maintain the best performance.

The above suggestions also apply to your equipment, battery, charger and other accessories. If any device doesn't work, please take it to the nearest authorized maintenance agency for repairing.