

## Power-on Instruction

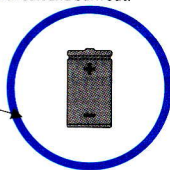

Attention: Keep the positive electrode of battery upward as above while inserting the battery. Never make the electrode inverse while inserting battery, otherwise, the wires in the production may short-circuit and burn out.

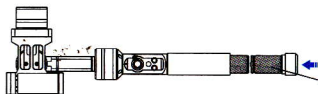

- 1 Unscrew the tail-hood and install the battery

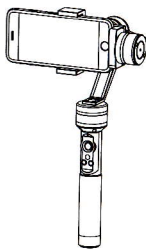
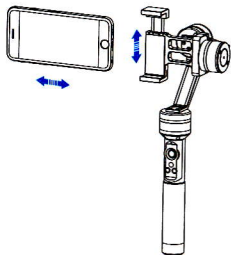

- 2 Unfasten clip and place your phone to make it fixed

Long press the ON/OFF button for 2 seconds.

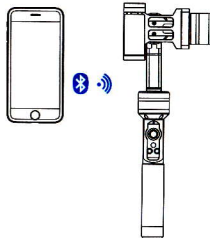
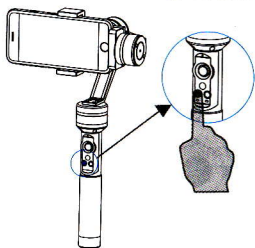

- 3 Long Press ON/OFF button for 2 seconds, the light stays red, Uoplay power on. Single Press ON/OFF button, red light flashes, Uoplay is working.

- 4 Switch on bluetooth of smartphone to connect to the Uoplay. The recognized name as "Aibird Uoplay"

## Warranty and Disclaimer

Thank you for purchasing Albird smart phone gimbal stabilizer—Uoplay.

By using this product, you signify that you have read the guidelines carefully and that you understand the terms and conditions and shall use it following the guidelines herein. You agree that when using this product, you are solely responsible for your own operation. Please do not disassemble the product. Albird accepts no liability for damages that are caused intentionally or by wrong operating. You agree to use this product in accordance with all newly applicable regulations, including, but not limited to, those set forth in the guidelines. All rights reserved.

## In the Box

- Uoplay Gimbal Stabilizer
- Battery Charger
- 18350 Rechargeable Batteries
- USB Cable
- Warranty/Certificate
- Counter Weight for iPhone6s Plus
- User Manual

## Optional Accessories

- GoPro Cradle (1\* Counter Weight, 1\*Mini Wrench, 6 \*Screws,Cable)
- 2.4G Wireless RC Controller
- Carrying Bag

## Rotation Angle

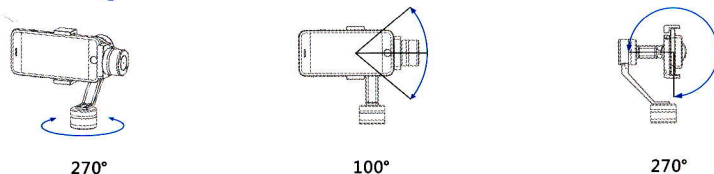

❗ Note: The rotation angle may be different for different phone size.

## Function Introduction and Guidelines

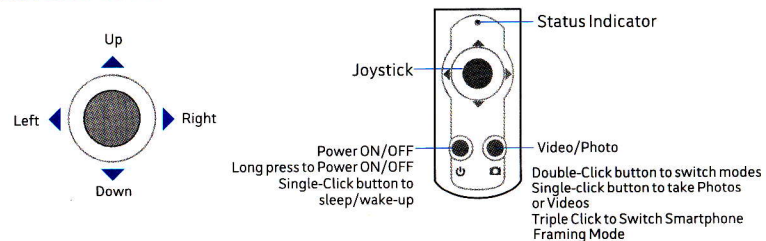

## Smartphone Framing Mode Introduction

- Horizontal Framing Mode (Default Mode)

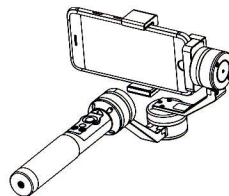

- Vertical Framing Mode

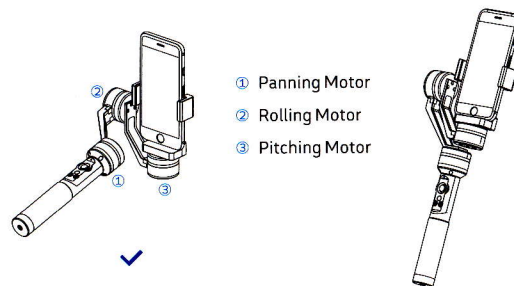

Please do not make No.1 motor and No.3 motor completely overlapping in vertical framing mode

## Indicator Light Instruction

Long press ON/OFF button for 2 seconds, the light stays red to make Uoplay power on, One-click ON/OFF button, red indicator light flashes slowly to wake up the Uoplay the Uoplay gimbal is working. One-click ON/OFF button operation again, the light stays red to make the Uoplay sleeping.

Indicator light quickly flashes that means low power, please replace the batteries

Working Mode	Indicator light status
Semi-Following Mode	Red light flashes
Fully-Following Mode	Green light flashes
Locked Mode	Blue light flashes

## Following Mode Instruction

- Semi-following Mode: Pitch and Roll locked, Pan changes smoothly with the handle movement  
UP-DOWN directional key to Control Pitching  
LEFT-RIGHT directional key to Control Rolling

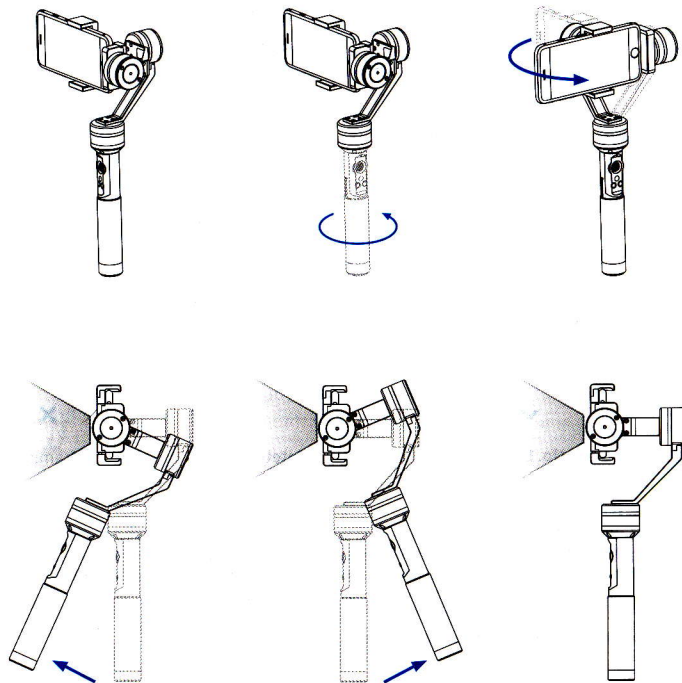

Mostly used for horizontal shooting and lower angle shooting. The camera shall rotate with the bilateral rotation of the gimbal

- Fully-following Mode: Roll locked, Pan & Pitch moved smoothly with the direction of Handle movement  
UP-DOWN directional key to Control Pitching  
LEFT-RIGHT directional key Locked

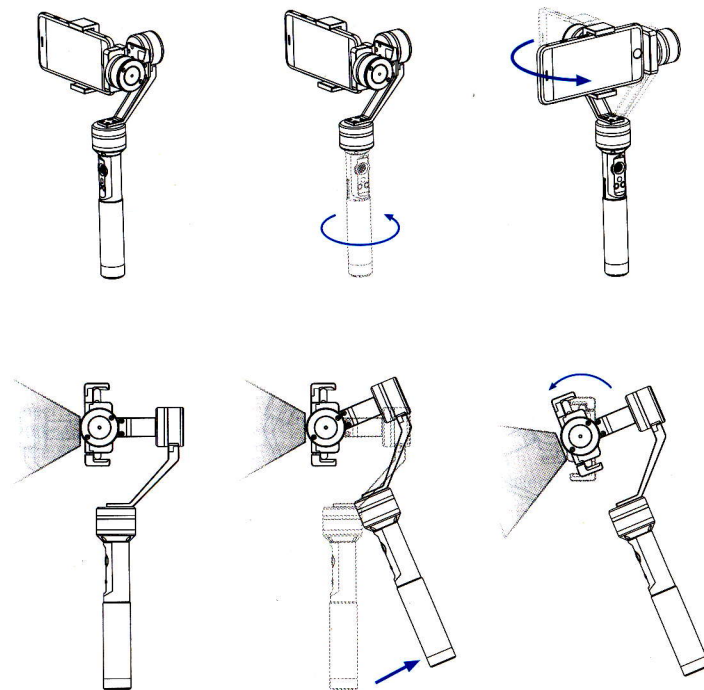

Perfect for motion shooting under the conditions of move status(up/down,left/right)or the photography is in ascend and descend (like upstairs and down stairs).Rotating gimbal left-to- right or up and down, the camera will move gradually following gimbal movement

- **Locked Mode:** Pan, Pitch and Roll locked, Smartphone or Gopro not follow the Uoplay handle to movement.  
UP-DOWN directional key to Control Pitching  
LEFT-RIGHT directional key to Control Panning

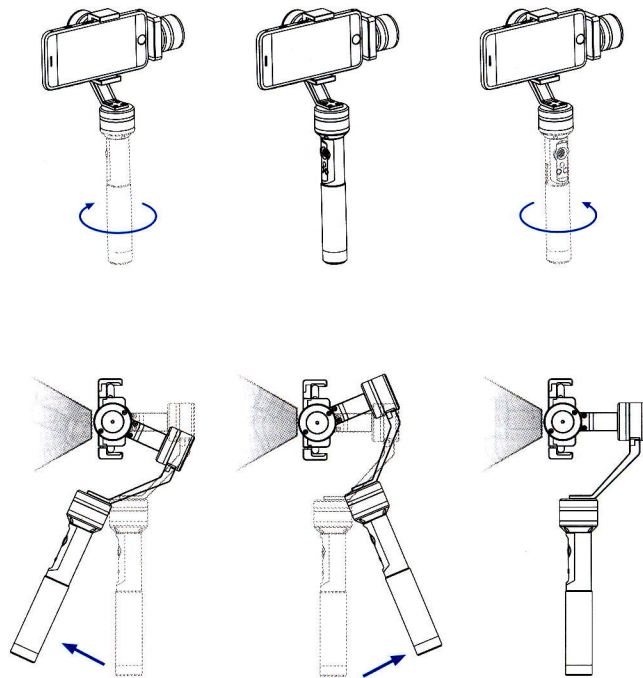

Apply to horizontal photography, The camera always toward forward while rotating gimbal in up-down and right-left.

## Update

Please download the update files on website  
Red light flashes when updating in processing. The flashing stops once the updating complete.  
([www.aibird.com](http://www.aibird.com))

## Calibration

Necessary for gyroscope initialization and accelerometer sensors calibration in six sides before use when the cases happen as follow:

- Initialization horizontal angle deviation of gimbal
- The gimbal has not been used for a long time.
- The Usage temperature has changed extremely

Ensure the Uoplay is powered on while calibrating. Press ON/OFF button for 5 times, calibration starts when the light flashes alternately in red, blue and green indicator. The indicator light turns red to complete the calibration after 5 seconds.

### Manual Calibration

If there is any deviation of horizontal angle, please switch to semi-following mode, calibrate gimbal by pressing left-right direction key.

After calibration is complete, press camera button 5 times, the light flashes in red, blue and green. Uoplay will turn off automatically and initialize horizontal angle.

## Charger instructions:

### 18350 Lithium battery

Input: DC5V/800mA  
Output: DC4.2V/400mA\*2

### Rechargeable battery:

Model Number: 1835 lithium battery  
Capacity: 900mAh  
Charging time: 3 hours

- ⓘ Note: Supply power for 18350 lithium battery by computer USB port, mobile charger or power bank

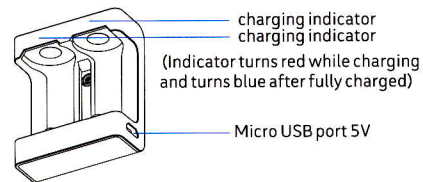

## Counter weight instruction

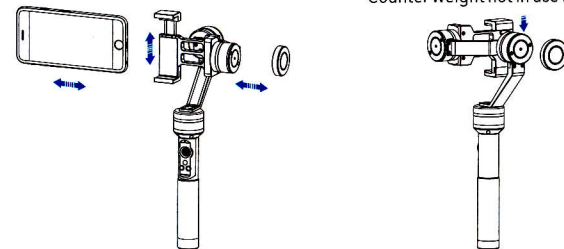

Please install counter weight when place big screen mobile similar as iPhone 6 Plus etc.



## How to Use with GoPro

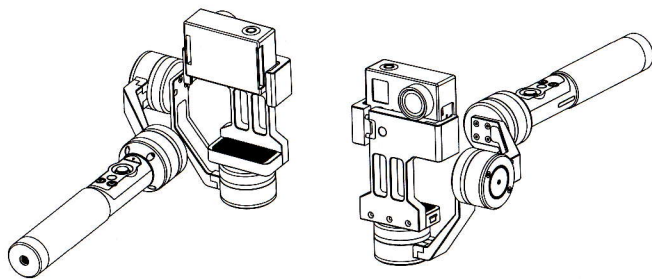

① Used with GoPro, it needs to be switched to vertical framing mode (triple-click on camera button)

## RC controller(optional)

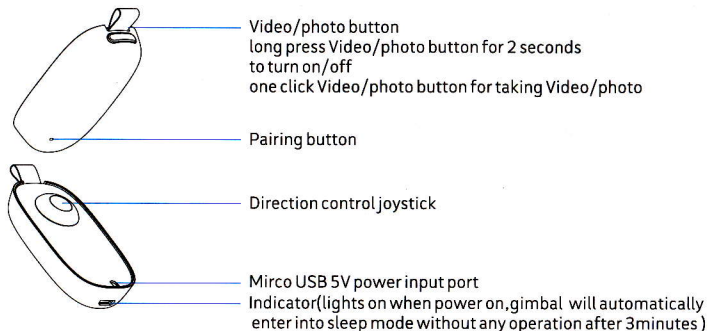

Press pairing button when pairing for RC controller, then Uoplay power on. That indicator lights up means pairing succeed, Uoplay can start to work.  
(If the remote controller lost or damage, new remote controller need to pair again in initial use)

## Specification

Parameters	Minimum	Standard	Maximum	Remark
Working Voltage	6V	8V	12.6V	
Working Current	180mA	250mA	2A	
Motion Gesture Follow Accuracy	$\pm 0.01^\circ$	$\pm 0.03^\circ$	$\pm 0.05^\circ$	
Pitching Angle	$-180^\circ$		$+90^\circ$	
Rolling Angle	$-50^\circ$		$+50^\circ$	Vertical Handheld
Panning	$-135^\circ$		$+135^\circ$	Vertical Handheld
Panning	$-60^\circ$		$+60^\circ$	Horizontal Handheld
Pitching Speed	$1^\circ/\text{s}$		$150^\circ/\text{s}$	
Panning Speed	$1^\circ/\text{s}$		$150^\circ/\text{s}$	
Battery Duration	3h	4h	5h	900mAh*2
Net Weight		384g		

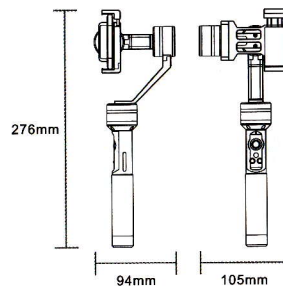

① Make sure it works within the range of the angle limitation. Otherwise, it may switch into protection mode automatically not to work as normal.

## Warranty

All customer of Uoplay are guaranteed of our warranty service.

### ● Warranty Terms:

1. In case of quality flaw, customer may request replacement within 10 days, on condition that the item has not been damaged or disassembled.
2. Guaranteed warranty of 1 year for Uoplay (6 months for the motors and batteries).
3. Maintenance fees shall be applied for the following circumstances:
  - 1) Damages caused intentionally or by wrong operating.
  - 2) Unauthorized disassembling, installing or maintenance.
  - 3) Damages caused by force majeure (eg. flood, fire, earthquake or thunder strike).
  - 4) Unable to present warranty card or valid purchasing note, thus unable to verify the customer file.

### ● Caution

Customers are required to fill out date information on the warranty card upon purchasing. It must be in accordance with date of the receipt. A warranty card without date information are regarded as invalid. The date of the receipt will be taken for reference in case it differs from the one on the warranty card.

## Instructions de démarrage



Instructions de l'installation de batterie  
En cas de l'installation, faire attention,  
déposer le pôle positif vers en haut pour  
éviter les dégâts, il ne doit pas le déposer  
envers

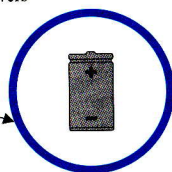
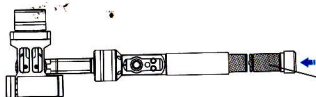

- ❶ Desserrer le couvercle à la derrière et installer la batterie

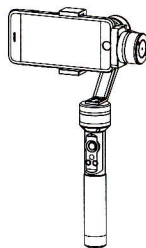
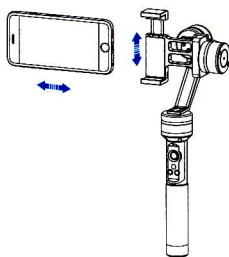

- ❷ Ouvrir Uoplay-la pince fixée du téléphone, et installer

Appuyer sur le bouton d'  
interrupteur 2 secondes,

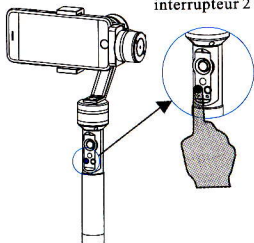

- ❸ le feu rouge de l'indicateur allume toujours. Suite,  
ouvrir Uoplay, clique sur le bouton d'interrupteur.  
Le feu rouge de l'indicateur cligne, c'est-à-dire que  
Uoplayest réveillé, après entrer dans l'état de  
l'opération.

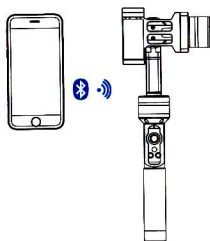

- ❹ Ouvrir le bluetooth du telephone, et connecter  
Uoplay(nom de bluetooth est «Aibird Uoplay»)