

Dear users:

Thank you for purchasing our photography, broadcast HD-SDI LCD Monitor kit. This product employs digital signal processing circuit and professional TFT LCD screen. The monitor with HDMI, 3G/HD-SDI input & output, to meet different customers' needs.

Its high brightness, low power consumption, stable performance and emits no radiation advantages, strong compatibility, adjustable color temperature control. Advanced features include Screen marker, CAMERA mode, Image magnification, Image flip and change, Monochrome mode etc. It is an ideal portable light weight frame supporting the monitor.

Product feature:

- ◆ Audio Column instructions
- ◆ HDMI, SDI output port
- ◆ Peaking focus assist (peaking filter)
- ◆ CAMERA mode: Canon 5D Mark II mode
- ◆ Image flip function
- ◆ False Colors
- ◆ Exposures
- ◆ Pattern Gen
- ◆ Brightness histogram
- ◆ Screen marker, Screen Center Marker, Nine Grid and other auxiliary line function
- ◆ Image zoom
- ◆ Aspect ratio adjustment
- ◆ Scan mode: standard, overscan
- ◆ Image Freeze
- ◆ Display pixel and the pixel point to point display
- ◆ Panel of the monitor button User-Definable function
- ◆ LED backlight, Image display brighter, screen does not flicker

To insure best use of the unit, please read the user's manual carefully.

CAUTION

1. Please use the adapter attached in the accessory.
2. Do not expose this product to direct sunlight, heat or humid conditions
3. Keep away from strong light while using this product so as to obtain the clearest and the most colorful picture.
4. Please avoid heavy impact or drop on the ground.
5. Do not use chemical solutions to clean this unit. Please simply wipe with a clean soft cloth to keep the brightness of the surface.
6. Without adjustable component in the unit, please do not take apart or repair the unit by yourself, to avoid damage the product.

CONTENTS

1. Product description	3
1.1. Front panel view	3
1.2. Rear panel view	4
1.3. Battery Plates	5
2. Power input way	6
2.1 The power supply by the adapter	6
2.2 Using batteries	6
2.3 The power supplied from camera.	7
3. Sun shade installation and remove	8
4. Operation instruction	9
4.1 Analog Volume operation	9
4.2 Menu operation and F1 ~ F5 Shortcuts buttons setting ..	10
5. Accessories	17
6. Parameters	18
7. Trouble shooting	18

1. Product description

1.1.Front panel view

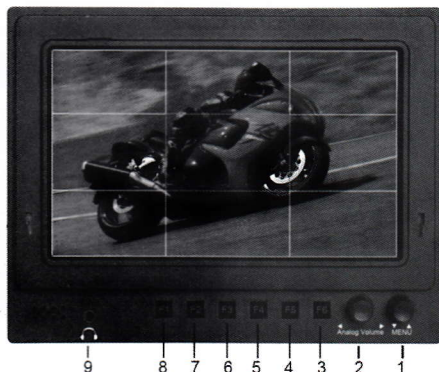

- 1. MENU:** Menu confirm or selection. Press the MENU button enter the main MENU, press again into the secondary MENU. After selected adjustment item, press the "MENU" once again to confirm. In the main menu and the secondary menu, rotating knob to the left or right to choose the secondary menu or menu item adjustment.
- 2. Analog Volume:** Volume / Analog selected / Adjustment. Direct left-right rotating knobs for volume control. And when direct press the button for analog volume selection (brightness, contrast, saturation, sharpness) , after confirm adjusting the analog volume, rotating left or right for adjust the analog volume value. In the operation of knobs for the adjustment or selection menu analog volume.
- 3. F6:** HDMI/SDI signal input selected

- 4 ~ 8、F5 ~ F1:** Shortcuts buttons. User-Definable function buttons, enter the menu of shortcuts defined item to use the Function on F1 ~ F5 menu items to define each function.

9. : Front earphone jack

1.2 Rear panel view interface and function:

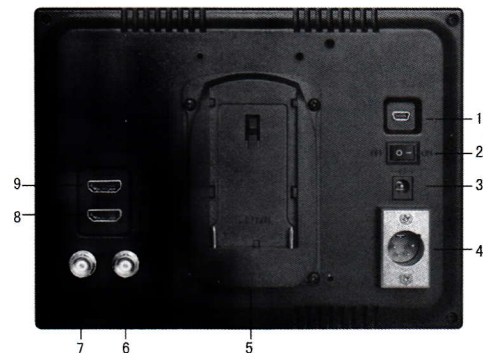

1. Programming upgrade port (when need with an update on the host)
2. **Power switch.** — Power on (ON), O Power off (OFF)
3. **DC12V Power input:** — — +
4. **4-PIN (XLR) DC 12V Power input**
5. **Battery plates.** According to the different requirements of Battery for the customers, attached different battery plates.
6. SDI signal input
7. SDI signal output
8. HDMI signal input
9. HDMI signal output

1.3 Battery plates:



F970



LP-E6



D28



Panasonic Anton Bauer



Sony V-Mount Plate

According to the different requirements of battery for the customers, attached different battery plate slots. No requirements, the factory defaults assembly F970 battery plate..

- ① Sony F970 battery slot for battery of Sony DV:
Sony F970 F960 F950 T930 F770 T750 F730 F570 F550
F530 QM91D OM91 QM90D QM90 QM71D QM71 QM70D
QM70 QM51D QM51 FM71 FM70 series
- ② Canon LP-E6 battery slot for battery of Canon DV:
Canon LP-E6
- ③ Panasonic D28 battery slot for battery of Panasonic DV:
Panasonic D55 D54S D54SE D40 D35 D33 D32 D28 D25
D22 series
- ④ Sony V-mount camera battery Plate
- ⑤ Panasonic Anton Bauer battery Plate

● Three types of batteries corresponding to the upper three slots



F970



LP-E6



D28

Remark: Different specifications of the battery, capability is different. The working time for the monitor will be different. Higher capability (working time) will be longer.

2、 Power input way:

There are some ways to supply the power of the monitor:

- 2.1 The power supply by the adapter. 12V/1.2A is optional DC voltage changer, insert DC power input interface directly. It can be choose qualified adapter which current with output voltage DC 6~15V, output capacity >18W by customers

Please note that the polarity of power input is inner POSITIVE, outer NEGATIVE. Otherwise will damage the product. (see attached image)!



Please use the adapter attached in the accessories. If necessary to use others pacifications adapter, please note to provide the qualified adapter which power supply should be not less than 18W(DC6V-15V)

- 2.2 Power source is using batteries: The product back case including battery slot is available for three types of batteries. Customers can choose different battery slots according to their needs.

- Battery install way as below picture :

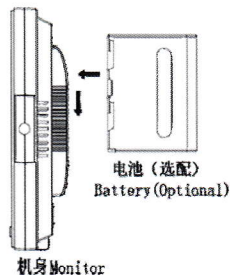

Suggestion: Better remove the battery for long-term NO use this product.

Different specifications of the battery, capability is different. The working time for the monitor will be different. Higher capability (working time) will be longer.

Without design charging circuit for the monitor, please remove the battery to the battery charger for charge.

- 2.3** This product also can be by 4-Pin XLD interface to use the power supplied from camera.

Please note that the polarity of power input is inner POSITIVE, outer NEGATIVE. Otherwise will damage the product.(see attached image)!

Pin Number	Signal
1	GND
2-3	NC
4	+12V



3. Sun shade installation and remove

- 3.1 Installation:** Positive parallel alignment of the sun shade and monitor, the projection of the sun shade hanging claw at the monitor sun shade slot (see the monitor front view marked 17), pay attention to the left and right position should be aligned around inserted balanced slide down. (see picture)

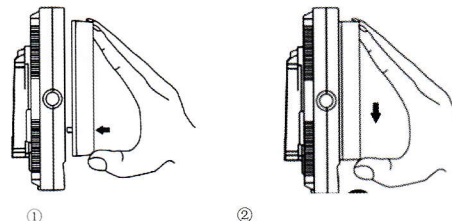

●Sun shade installation picture

- ① The sun shade protruding hanging claws alignment the monitor sun shield slot, the position should be aligned with the left and right send the sun shade hung claw to monitor slot.
- ② Inserted around balanced slide down, match with sun shade and monitor.
- ③ Please follow steps 1、2、3, otherwise will damage the cover, please do not press the L/R panel of the sun shade, if not, unable open the cover.

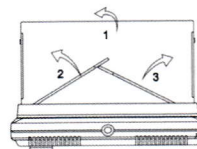

3.2 **Remove:** When you want sun shade is removed from the monitor, hands were clenched monitor and the sun shade, drag up sun shade from monitor, then separates the sun shade from the monitor.

● **Sun shade remove picture:**

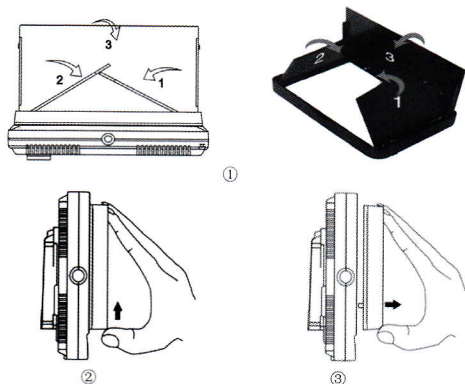

- ① According to the following steps, close the sun shade in order
- ② Left and right balance to move sun shade, the hanging claw and slot separate.
- ③ Remove the sun shade

4. Button operation instruction

According to the instructions in front of the right to access the power supply and signal, press the power switch is turned on, and then according to the following instructions for analog or menu operation:

4.1 Operation of analog

- ①. Press **F6** to select the input signal source

- ②. Turn directly the rotary knob "**Analog Volume**" to adjust the volume
- ③ Press "**Analog Volume**" select "**Brightness**" "**Contrast**" "**Saturation**" "**Sharpness**", after selecting the analog item to be adjusted, turn "**Analog Volume**" to adjust the analog value.

4.2 Menu operation and F1~F5 shortcut key settings

- ①. Press the "**MENU**", enter the **Main Menu** interface:

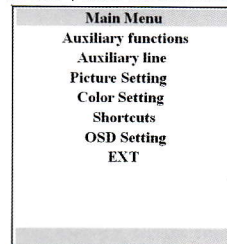

- ②. Revolving around "**MENU**" button, can choose the secondary menu items on the MENU, the selected item on the characters of present a deep color fog color strips.
- ③. After selected one of the secondary menu, press "**MENU**" for confirm, that is enter into the corresponding secondary menu options. Such as, select "**Auxiliary functions**" item. After the confirmation:

Auxiliary functions	
Single color	Gray
Pseudo Color	Off
Zebra Crossing	Off
Assist in Focus	Off
Focus Color	Yellow
Histogram	Off
Audio Column	Off
Pattern Gen	Off
Camera Mode	Off
EXIT	

- ④、At this time, you can rotate the “MENU” button, choose the project need to be adjusted or watch, would be present in the selected project character deep color strip. When staying in deep color strip on a certain adjustment of these projects, rotating “Analog Volume”, can adjust the selected project parameters or options.
- ⑤、To exit the current MENU interface with “MENU” select “EXIT” item, then press “MENU” again to confirm. If directly press “Analog Volume”, are out of all the MENU interface.

⑥、Menu Description :

● Auxiliary functions

Auxiliary functions	
Single color	Gray
Pseudo Color	Off
Zebra Crossing	Off
Assist in Focus	Off
Focus Color	Yellow
Histogram	Off
Audio Column	Off
Pattern Gen	Off
Camera Mode	Off
EXIT	

- ★ **Single Color** : To select the image of black and white, red, green, and blue monochrome display
- ★ **Pseudo Color** : The pseudo-color image display
- ★ **Zebra Crossing** : “Zebra crossing” function, that is it will appear “ zebra crossing ” in that section overexposed pictures when pictures’ highlights overexposed, can choose the level of brightness of “70IRE” or “100IRE”.
- ★ **Assist in Focus** : To select high, low or close the auxiliary focus function in order to meet different customers’ needs
- ★ **Focus Color** : Select auxiliary focus hook edge color (red, blue, yellow)
- ★ **Histogram** : In view of the current image’s distribution for pixel and brightness.
- ★ **Audio Column** : The peak value of left and right sound channel audio instructions
- ★ **Pattern Gen**: The machine itself since the occurrence of striped and gray scale detection image
- ★ **Camera Mode** : Using 5D2 or 550D and other similar camera, activate “Camera Mode”, the screen image disappears after about 2-5 seconds, will return to full screen display image, then watch from framing of the screen image to the recording when there is no time difference, image NO distortion, NO black, NO delay, perfect without distortion.
- ★ **EXIT** : To exit the current menu interface

●Auxiliary Line

Auxiliary Line	
Center	Off
Safe Border	Off
Nine Grid	Off
EXIT	
-	
-	
-	
-	
-	

- ★**Center** : screen center mark (cross mark) display settings
- ★**Safe Border** : Picture framing marker selection frame (off, 96%, 93%, 90%, 85%, 80%, 2.35:1)
- ★**Nine Grid** : Auxiliary reference line of Picture frame
- ★**EXIT** : Exit the current menu interface

●Picture Setting

Picture Setting	
Video Ratio	16:9
Scan Mode	Standard
Pixel to Pixe..	Off
Zoom	Off
H Mirror	Off
V Mirror	Off
Freeze	Off
EXIT	
-	

- ★**Video Ratio** : Image ratio of 16:9, 4:3, automatic model select
- ★**Scan Mode** : Special image adaptive processing (standard, underscan)
- ★**Pixel to Pixe..** : The display mode that make the resolution of

the image consistent with display of the physical resolution .

- ★**Zoom**: digital zoom function, optional for 1.4X, 5X, 10X.
- ★**H Mirror**: The function of image left/right.
- ★**V Mirror**: The function of image up/ down.
- ★**Freeze**: The current picture still(capture function)
- ★**EXIT**: To exit the current menu

●Color Setting

Color Setting	
Brightness	50
Contrast	100
Color Temperat..	Medium
Saturation	100
Red	100
Green	100
Blue	100.
EXIT	
-	

- ★**Brightness**: To adjust the image's brightness
- ★**Contrast**: To adjust the brightest and darkest ratio of the image
- ★**Color Temperat..**: Use the adjustment the color temperature can be pre-set (standard, 6500K, 9300K)
- ★**Saturation**: To adjust the saturation
- ★**Red**: Image fine-tuning for the Red color in the color temperature
- ★**Green**: Image fine-tuning for the Green color in the color temperature
- ★**Blue**: Image fine-tuning for the Blue color in the color

temperature

★EXIT: To exit the current menu

●Shortcuts (The setting of the front panel F1 ~ F5)

The front panel buttons F1 ~ F5 for custom shortcuts, users can according to operating habits, selected one of below choice as a function of the definition of the key, such as **Scan Mode**, **Pixel to Pixel**, **Zoom**, **H Mirror**, **V Mirror**, **Freeze**, **Camera Mode**, **Timer**, **Single Color**, **Pseudo Color**, **Zebra Crossing**, **Assist Focus**, **Histogram**, **Audio Column**, **Pattern Gen**, **Center**, **Safe Border**, **Nine Grid**, **Video Ratio**.

★Setting steps(with "F1 Function" as an example) :

① Press "MENU" to enter the main MENU interface, rotating

"MENU" button, select "Shortcut", then press "MENU"

again to confirm, namely into the custom shortcuts.

Shortcuts	
F1 Function	Scan Mode
F2 Function	Zoom
F3 Function	Freeze
F4 Function	Single color
F5 Function	Focus color
EXIT	

② Selected "F1 Function", turn the "MENU" button, let the deep color strips stay in "F1 Function".

③ Rotation 'Analog Volume' knob, appears in the menu will rotate item name such as **Scan Mode**, **Pixel to Pixel**,

Zoom, **H Mirror**, **V Mirror**, **Freeze**, **Camera Mode**, **Timer**, **Single Color**, **Pseudo Color**, **Zebra Crossing**, **Assist Focus**, **Histogram**, **Audio Column**, **Pattern Gen**, **Center**, **Safe Border**, **Nine Grid**, **Video Ratio**, when stop turning, appears the item name in the menu is the custom of selected items.

④ After selected, turning the "MENU" knob to enter

user-defined "F2 Function".

⑤ Custom setting for **F3 ~ F5 Function** like the same with above steps

⑥ To exits, select "exit" items, press "MENU" to confirm

● OSD Setting

OSD Setting	
OSD Language	English
Blending	Low
Volume	70
Reset	
EXIT	

★OSD Language: Select display language (Chinese, English)

★Blending: To select menu shows perspective effect

★Volume: To adjust speakers or headset volume

★Reset: On system parameters and settings recover factory settings

★EXIT: Exit the current menu interface

5. Parameters

Panel size	TFT LCD 7.0inch
Panel Type	TFT LCD
Pixel	1024×600×RGB = 1843200 Pixels
Backlight	LED
Dot pitch	0.05(W) x 0.15 (H)
Contrast ratio	16:9
Brightness	250 cd/m ²
Contrast ratio	700:1
Response time	10ms
Viewing angle	75°/75°(L/R) 70°/75°(U/D)
Input signal	HDMI, 3G/HD-SDI
Output signal	HDMI, 3G/HD-SDI
HDMI/ SDI	1080/24p/24psf/25p/30p/50i/60i/50p/60p;
Supported formats	720/50p, 720/60p, 480i, 480p; 576i, 576p
Headphone output	Stereo headphone output 3.5 mm interface
Input voltage	DC: 6 ~ 24V
Power consumption	≤10W
Unit size (Max)	196(L)x156(W)x52(H)mm
Unit weight	540g
Installation	There is a 1/4 standard screw bracket fixed hole on the up / down and left/right position, for hot shoe mount & magic arm installation.
Working temperature	-20 ~ 50℃
Storage temperature	-30 ~ 65℃

6. Accessories

Power adapter

Sun shade

F970 battery plate (According to customer requirements, the other model battery plate can be installed, see instruction 1.3)

7. Trouble shooting

If there is any problem using the unit. You can try follow ways to inspect and solve.

Without image display	Trouble shooting
◆Video cable off or connect incorrectly	Check the quality of the cable, make sure the correct input interface
◆Without video signal input	Check the signal source and output interface connect is correct or not
◆Monitor is not be powered on	Check the power whether connected, put the power switch to "on" position
◆Supply voltage instability	The power adapter or battery is poor connected with battery plate
◆The power use is self-made, polarity connect inversely	Reference "Power input way" reconnect

Image/color display abnormal	Trouble shooting
◆Video cable poor contact	Change video cable, try again
◆Video signal interfered from external environment	Move to another environment to try again
◆Menu color saturation adjustment closing	Enter menu check color, or reset to factory settings
◆B/W set in monochrome or black & white	Press the B/W button, back to the color
◆Image deformation	Reset the ratio