

Quick setup

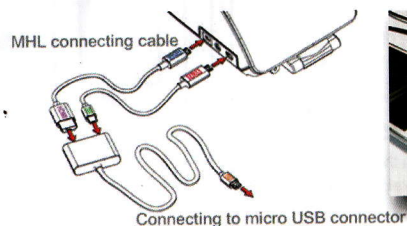

How to connect with Android Phone

The phone that supports MHL output



SAMSUNG S3 / Note 2 need a 5 pin to 11 pin connector to complete the connection between phone and cable

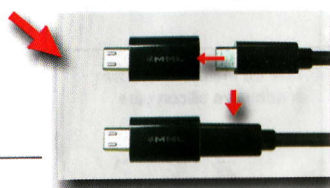

The phone that supports HDMI output

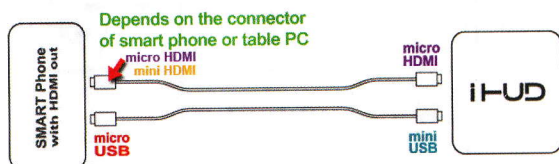

Table PC or smart phone supported HDMI output is able to connect with iHUD, but the cable type must be changed refer to model of your device



How to connect with iPhone

iPhone 4S

Apple 30 pin Digital AV Adapter

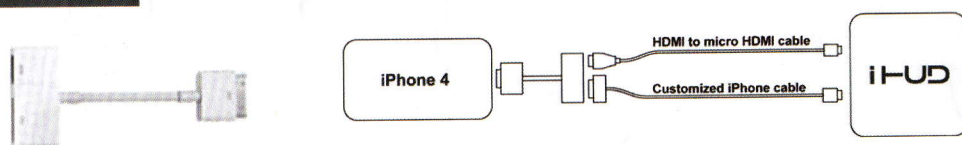

User need to buy their own 30 pin Digital AV adapter from Apple store

iPhone 5/5S

Lightning Digital AV Adapter

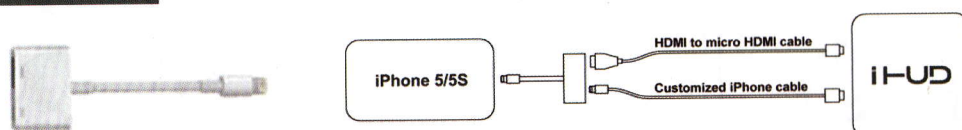

User need to buy their own Lightning Digital AV adapter from Apple store

Wireless link (Only support android 2.2 or later...)

User need to buy their own WiFi display dongle and connection method as shown below

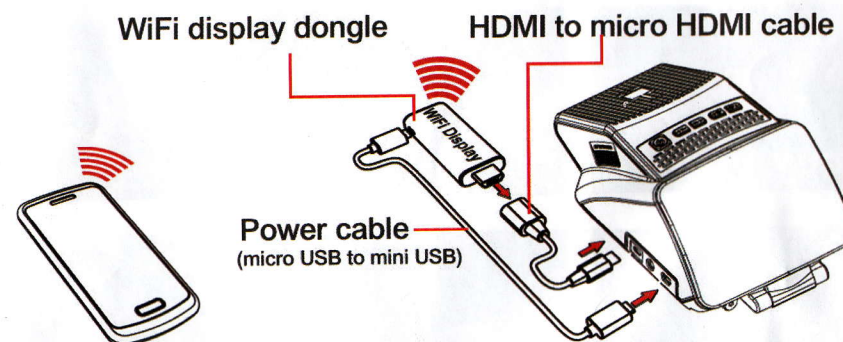

Suitable for the cars of installing iHUD

Windshield angle $> 25^\circ < 40^\circ$

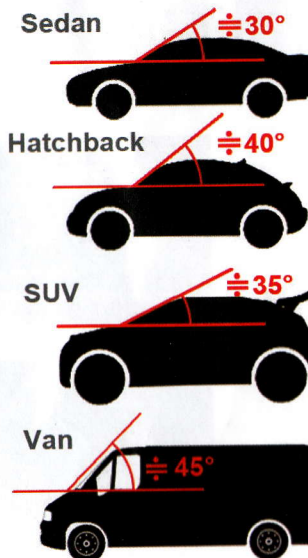

Windshield angle $> 40^\circ$

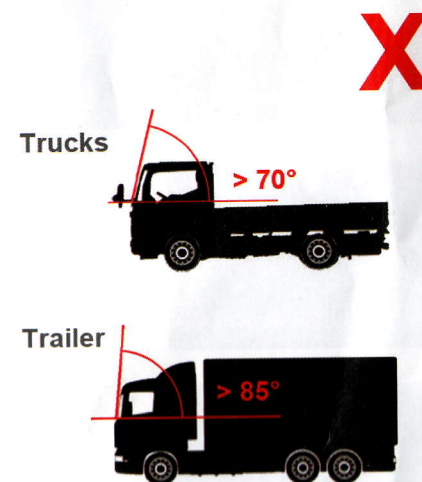

Quick setup

Base setup → iHUD setup → Connect to Smart phone

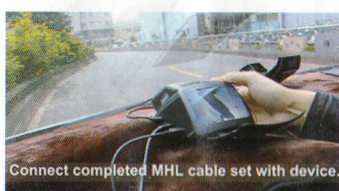
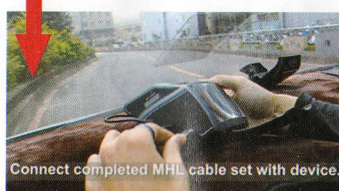
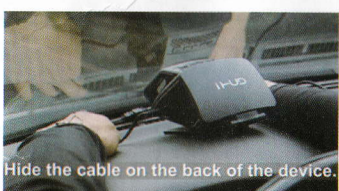
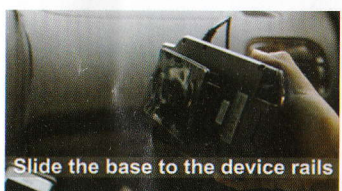

1. Reflective Pad

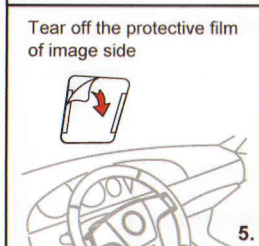
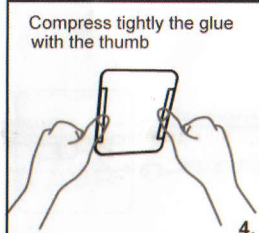

2. Reflective film

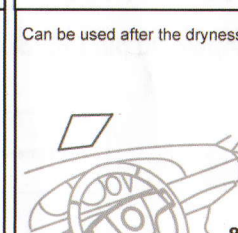
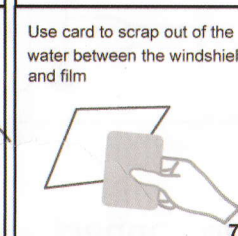
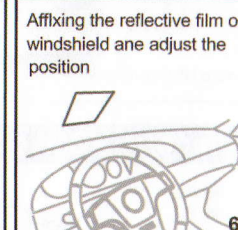
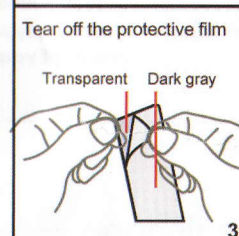
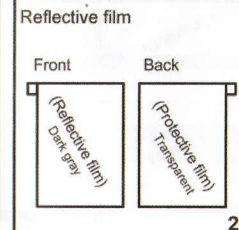
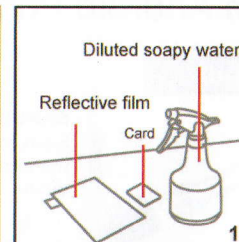

3. AR film

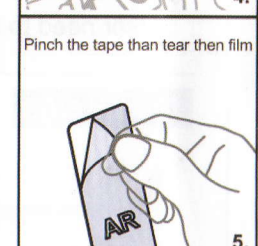
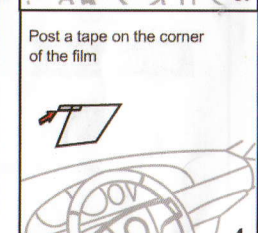
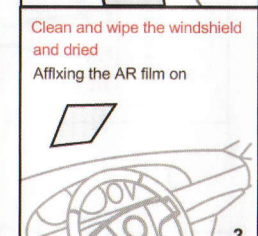
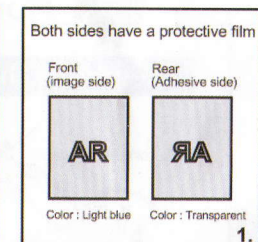

iHUD

World's first Multimedia HUD

***Smart Phone supported
with high resolution***



Enjoy driving with iHUD



Springteq

Enjoy driving with iHUD

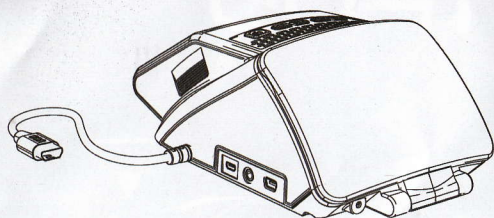

Thank you for purchasing this product. To help familiarize yourself with its operation, please read this manual carefully before attempting to use the product, and save this manual for future reference.

Multimedia Head Up Displayer.

iHUD is the world's first high resolution HUD capable for Smartphones, 2-Din Car System or any composite/HDMI video/audio outputted device. Mainly display any contains from any video/ audio devices into HUD mode to project onto the windshield while driving, therefore, driver can always easily have the key information such as Speed, Road Information, OBDII, Incoming Calls, Webcam Calls, or Navigations without any inattention by leaving eyes on the road which greatly enhances driving safety.

Included Accessories

Please verify that the package contains the following items. If any item is missing or damaged, please contact your local distributor immediately.

1. iHUD System unit (X1)	2. Base stand (X1)	3. Slide rails (X2)	4. Cigarette Lighter adapter (X1)
5. Reflective film (X1)	6. CVBS cable (X1)	7. USB to mini USB (X1)	8. Cable organizer (X2)
9. MHL Adapter (X1)	10. HDMI to mini HDMI cable (X1)	11. micro USB to mini USB (X1)	
Reflective pad (Optional)	AR Film (Optional)	SAMSUNG S3, Note 2 Adapter (Optional)	

iHUD System Details

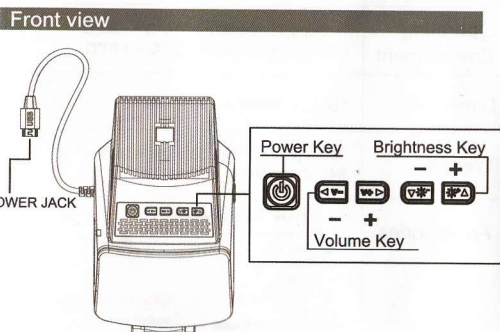
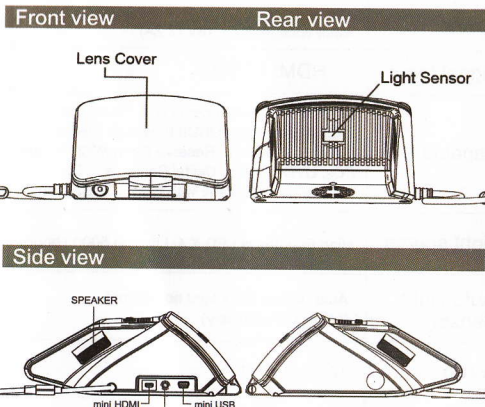

The iHUD's base stand

The base stand for iHUD does not require modifying the interior of the car, and no tools are needed for attaching it to most dashboards. In addition, the base stand allows for adjustments to the viewing angle of the iHUD system unit to suit the height of the driver and the slope of the windshield or dashboard surface. The base stand's design uses screw that can be loosened or tightened with a coin for ease and convenience.

1. Slide the base stand (2) onto the slide rails attached previously until it locks into place. Reverse directions to detach the iHUD system unit.

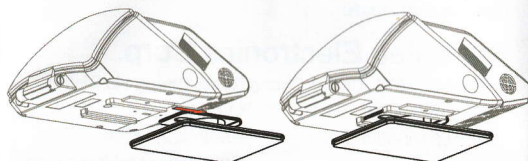

Installing iHUD on a dashboard

1. Because of the materials used for the surface of a car's dashboard are typically smooth and often coated with varnish, making it difficult to achieve a strong adhesive bond, it is recommended that before installation, a piece of cloth moistened with alcohol be used to wipe the surface to the dashboard.
2. Before installation, the protective film on the base stand's PVC pad must be peeled off. (It is recommended that you keep this protective film for future use in case you decide to remove the base stand and wish to prevent dust from sticking to it.)
3. Press the iHUD system unit against the surface of the car's dashboard (with the lens cover pointing toward the driver) to attach it. (If space allows, it is recommended that you position it close to the windshield.)
4. If you need to adjust the tilt of the iHUD system unit, remove the iHUD and tighten the quick-release screw to appropriate tightness on the base stand, and then re-attach the iHUD system unit to adjust the angle by moving main device.
5. When you need to remove the base stand, simply use your hand to lift up one corner of the PVC pad.

How iHUD works on your Dashboard

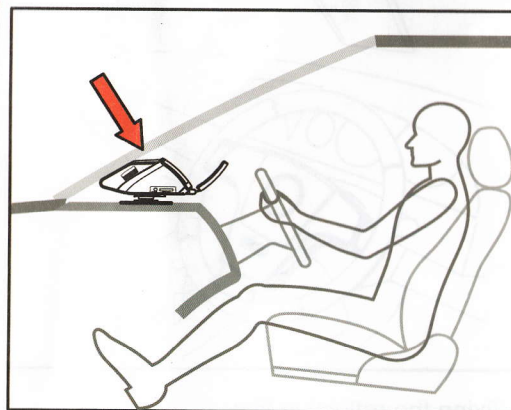

Angle allowance

To accommodate different dashboards, the angle of the iHUD's base stand can be adjusted based on the driver's height, and the angle of the windshield or dashboard (up to a maximum of 15° in either direction).

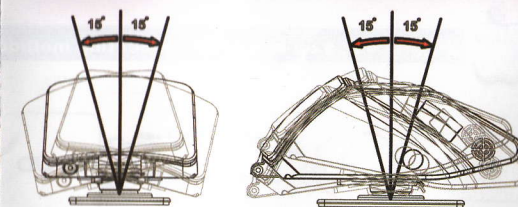

Android and iHUD connecting method

Android Phone which supported MHL output

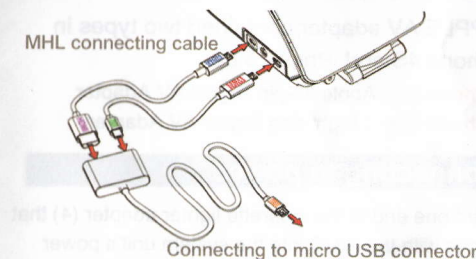

SAMSUNG S3 / Note 2 up need a 5 pin to 11 pin micro USB connector to complete the connection between smart phone and MHL cable, otherwise the image can't be output

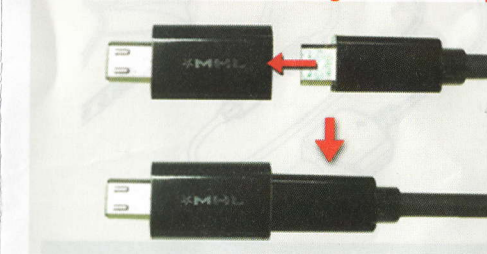

Other smart phone with support to HDMI out

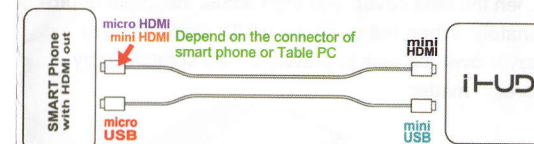
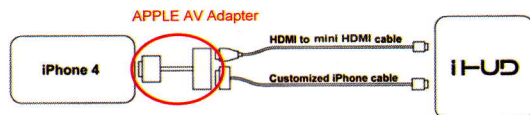

Table PC or Smart phone supported HDMI out function is able to connect with iHUD, but the cable type must be changed refer to model of Table PC or Smart Phone. Generally, interface of HDMI has two different types in micro HDMI or mini HDMI. Power recharging, mostly smart phone contains micro USB connector, just need an extra connecting cable for micro USB to mini USB.



iPhone 4S / 5 up and iHUD connecting method



Connecting method shown on above drawing.
Customer must prepare an APPLE connector and
HDMI A to C cable. Power can be recharged by
connection between USB to mini USB cable and
iPhone cable.

APPLE AV adapter contained two types in
iPhone 4S and iPhone 5 up

iPhone 4s : Apple 30-pin Digital AV Adapter

iPhone 5 up : Lightning Digital AV Adapter

Connecting to power

Insert one end of the cigarette lighter adapter (4) that
comes with the iHUD into the system unit's power
adapter socket, and the other into the car's cigarette
lighter.

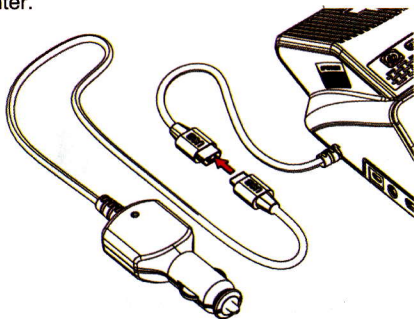

Adjusting the lens cover

The lens cover serves both to protect the lens and to
prevent glare. When using the iHUD, you must first
open the lens cover, and then adjust the angle appro-
priately. When not using the iHUD, close the lens
cover over the lens to protect it from scratching by
foreign matter.

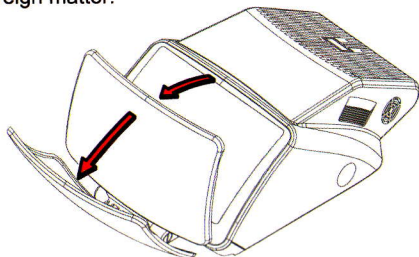

Affixing the reflective pad

Please use the following steps to affix the reflective
pad:

1. Use a clean cloth to wipe the area on the glass
where the reflective pad will be affixed.
2. Tear both side protective film from the reflective pad.
3. Lightly place the reflective pad against the windshield
at the location where the iHUD's projected image
appears.
4. Sit in the driver's seat in the attitude you would
normally take when driving, and then make any
adjustments in the position of the reflective pad to
obtain an optimal view before take off adhesive
silicon glue and fixed the pad on windshield

Tear both side protective film of reflective pad

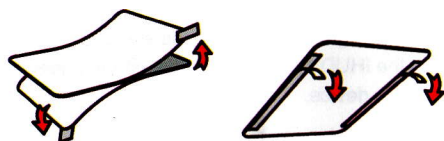

Tear the protective film
of adhesive silicon glue

Affixing the reflective pad

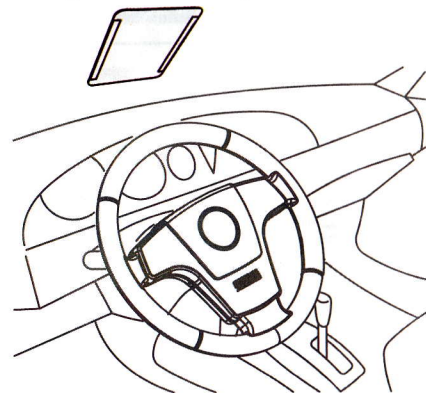

Affixing the reflective film

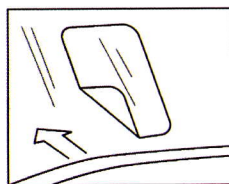

If you choose to use a reflective film,
the applying method is same for an
auto insulation paper. Mix a few drop
of dishwashing liquid with water and
spraying them on windshield and
adhesive side of the reflective film in
same time before adhesion. After the
reflective film pasted on a satisfied
position, applying a plastic card to
scrape water & bubble out from the
bottom and wipe the surface around to
dry out.

Product Specifications

Power	Car charger. Input voltage: 9V ~ 16V (2.2A)
Signal Input	HDMI / CVBS
Capable	Smartphones (Any brands with TV out funtions), 2-Din Car System, OBDII Bluetooth Device, Side View Camera, Reserve Cam, MP3 Players, PCs, DVD Players, Digital Cameras, .. Etc. (Or any devices come with HDMI/ CVBS signal).
Light source	High Brightness LED X 4, Lifetime 50000 hours
Auto Light Sensor	Auto 4 tiers back light adjustment (16 tiers of manually)
Audio	1W Speaker x1
Screen	Full Color 5" (virtual image) Resolution: 400 x 240 Brightness : 5,000~7,000 cd/m2(Max)
Operating Environment	Working Temperature: -10°C ~ +60°C Storage Temperature: -20°C ~ +70°C
Dimension	189(L) x 110(W) x 74(H) mm
Weight	388 g (System unit base excluded), 845 g(Completed packed)
Accessories	2.5mm Phone Jack Connector. mini USB Connector (Cable) Adjustable Base Slide Rails Car Chargers. Cable organizer MHL Adapter HDMI to mini HDMI cable micro USB to mini USB Reflective film Optional Accessories Reflect pad AR film SAMSUNG S3 / Note 2 Adapter

Model: S26B1



ONE YEAR LIMITED WARRANTY

Serial No.

Store Name:

Store Address:

103. 8. 26

Name:

Date of purchase:

Springteq Electronics Corp.

13F-5, No. 872, Chung Cheng Road, Chung Ho District,
New Taipei City, Taiwan 235, R.O.C.

Tel: +886-2-8228-1239 Fax: +886-2-8227-7189

<http://www.springteq.com>