

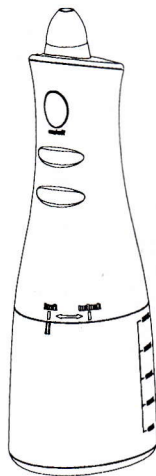

Portable Nasal Irrigator

Operating Instructions

Model: XF8007



Before operating this product, please read the instructions carefully, and save this manual for future use.

Safety Instructions

All information in this section is provided to instruct you can avoid injuries to yourself and others as well as damage to property.

Use 1-2 times per day.

Use the Nasal Irrigator to reduce the risk of cold, allergy and sinus symptoms, including:

- Nasal irritation from dust, fumes, animal dander, grass, pollen and smoke
- Sinus pressure and nasal stuffiness
- Nasal symptoms from flu and cold
- Nasal and allergy dryness

Warnings

- To avoid injury, do not use if your nasal passage is completely blocked.
- To avoid injury, do not use if you have an ear infection or are experiencing pressure in the ear.
- To avoid injury, do not use on children under the age of 6.
- This appliance is not intended for use by persons (including children) with reduced physical, sensory or mental capabilities, or lack of experience and knowledge, unless they have been given supervision or instruction concerning use of the appliance by a person responsible for their safety.
- To avoid injury, do not use this product after sinus or nasal surgery.
- To avoid injury, do not use this product if you have open wounds or bleeding in your nasal or sinus passages.
- Do not fill the tank with water warmer than 40°C.
- Use warm distilled water or previously boiled water (be sure water has been cooled).
- Do not submerge in water.
- Do not drop foreign objects into saline mixture.
- This is not a medical treatment device.
- Keep the appliance sanitized. Make sure to throw out the water inside the tank, and run the appliance for 3 to 5 seconds to drain the water after usage. Failure to do so could result in damage to your health if used without keeping it sanitized due to propagation of mold and bacteria. It may also result in odor and malfunction.

Battery Notice

- Please use 3 x AA size batteries.
- Insert the batteries correctly checking the "+" and "-" terminals.
- Remove exhausted batteries from the main unit and dispose properly.
- Remove the batteries when the appliance is not to be used for a long period.
- Do not dispose of batteries in fire.

Do not modify this product. In addition, please do not disassemble or repair.

Parts Identification

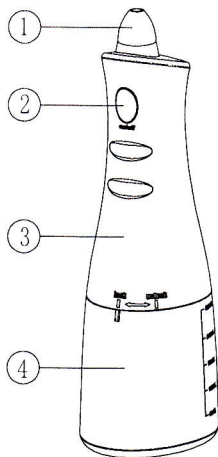

1. Soft nozzle
2. on/off button
3. main unit
4. tank

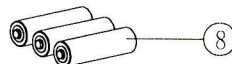
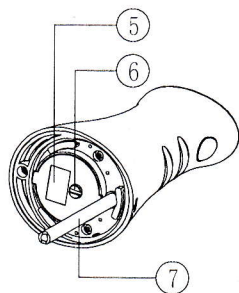

5. battery cover
6. battery cover screw
7. water suction tube
8. AA size battery (without included)

Note

There may be some liquid remaining inside the main appliance before use (tank, water suction tube, etc), this is the remaining distilled water that was used for the performance (water flow) test, so there are no health concerns.

If your nasal passage is completely blocked or if you have an ear infection or are experiencing pressure in the ear, discontinue nasal rinsing and consult your physician

Preparing Your Nasal Irrigator for Use

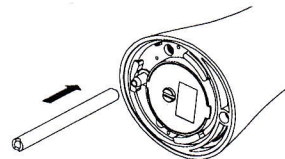

1. Install water suction tube to main unit if it without attached to the main unit.

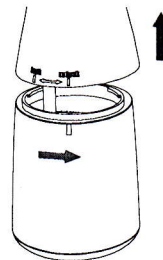

2. Remove the blue tank if attached to the main unit. Remove by turning the blue tank from the locked position to the unlocked position and pull the main unit away from the blue tank.

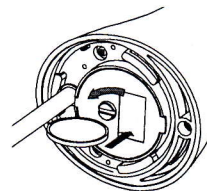

3. Locate the battery cover on the bottom of the main unit. Use coin or standard screwdriver to loosen (but not remove) the center screw on the battery cover. Note: Screw will remain in battery cover.

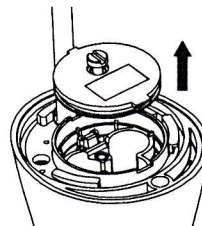

4. Pull the battery cover off the main unit to reveal the battery compartment.

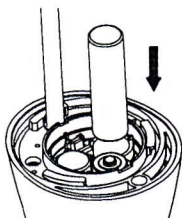

5. Install 3 AA batteries following the diagram inside the battery compartment.

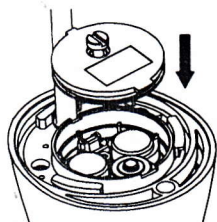

6. Reinstall the battery cover by aligning the tab on the battery cover with the slot on the main unit.

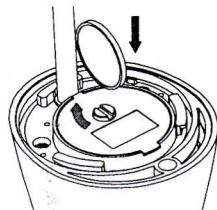

7. Press the battery cover firmly onto the main unit. Use coin or standard screwdriver to secure the battery cover to the main unit by tightening the screw until it stops.

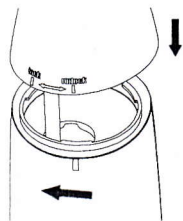

8. Insert the white suction tube on the main unit into the hole in the blue tank. Align the rib on the blue tank with the unlocked position on the main unit and press together. Turning the blue tank to the locked position.



9. Install soft nozzle tip. Two soft nozzle tips are included to accommodate multiple users.

Clean your nasal irrigator thoroughly before each use.

Performing Sinus Wash with Your Nasal Irrigator

1. Please wash your hands before each use.

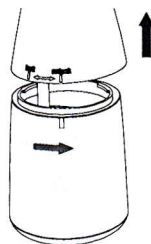

2. Remove the blue tank if attached to the main unit. Remove by turning the blue tank from the locked position to the unlocked position and pull the main unit away from the blue tank.

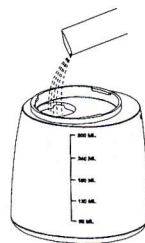

3. Place the blue tank on a flat surface. Tear open a saline pack and pour its contents into the blue tank. (Without included saline pack)

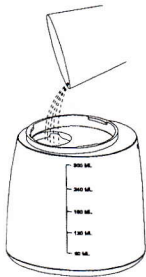

4. Fill the blue tank with 240mL (8 fl oz) of warm distilled water or previously boiled water.

Caution:

Do not use hot or boiling water.

Note: seepage from the vent will occur.

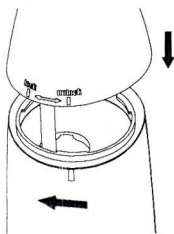

5. Insert the white suction tube on the main unit into the hole in the blue tank. Align the rib on the blue tank with the unlocked position on the main unit and press together. Turning the blue tank to the locked position.

6. Gently shake to dissolve the mixture.

7. Standing in front of a sink, bend forward to your comfort level and tilt your head down. Place the soft nozzle into your nostril, open your mouth slightly. Press the blue on/off button until the solution starts draining from your other nasal passage. Allow at least 120ml of solution (approximately 20 seconds) to clean and moisturize for one nostril, then gently blow your nose to remove mucus, bacteria and any excess water from your nose. Repeat on opposite side of nasal passage. Stop pressing the on/off button if you feel any discomfort, Pain or pressure during the irrigation.

8. Discard all remaining solution and clean the nozzle and blue water tank thoroughly with soap water; rinse thoroughly and towel dry.

Maintenance

There is a risk of bacteria propagating, so wash thoroughly and dry before storing.

Soft nozzle

- Remove soft nozzle from the main unit.
- Wash with water and wipe with a cloth.

Main unit

- Run the main unit for 3 to 5 seconds until no water comes out.
- Remove the dirt by wiping using a cloth with liquid soap, and wipe off using a dry cloth.
- Wash with water if it is very dirty.
- Do not wipe the appliance with thinners, benzene, alcohol etc.
- Do not wash using hot water of over 50°C.
- Make sure the battery cover is securely closed.
- Do not leave the appliance submerged in water.
- Do not wash main unit in the dishwasher.
- Dry after washing with water.
- Remove the batteries when the appliance is not to be used for a long period.

Water suction tube

- Remove water suction tube from the main unit.
- Wash with water and wipe with a cloth.
- Do not bend the water suction tube.

Tank

- Make sure to throw out the water inside the tank.
- Remove the tank and clean thoroughly with a bottle brush and dish detergent.
- Rinse with water and wipe off with a cloth.
- Dry the tank when not using for a long period.

This product is intended for household use only.

Specifications

Power supply: 4.5V DC (3 AA size batteries).

Weight: Approx. 265g (without batteries).

Tank capacity: Approx. 300ml

Waterproof grade: IPX6

Product size: 73(L)x89(W)x244(H)mm

Packing list

Main unit	1pc
Tank	1pc
Soft nozzle	2pcs
Water suction tube	1pc
Manual	1pc

