

# 1:12 Scale R/C Bigfoot Model Using Instruction



Caution: This model is not a toy, it is designed for user over 14 years of age.

Please use this instruction and the R/C system instruction at the same time.

The instruction is suitable for a type of model whose number is L969.

Safety and caution .....	1
Troubleshooting • Product introduction .....	2
Instruction of common tools and installation the electronic part.....	3
Practice and maintenance.....	4-5
Assemble exploded view .....	6-14
Fittings view .....	15-17

## Safety and Cautions

- \*Never run the model on public roads or streets, as it could endanger traffic.
- \*Never run the model in crowded areas, near or toward people or animals, to prevent property damage and/or personal injury.
- \*Never run the model near rivers, ponds or lakes as to prevent R/C car from dropping into the water.
- \*Make sure that no one else is using the same frequency as yours in your running area. Using the same frequency at the same time, whether it is driving, flying or sailing, can cause loss of control with R/C model, resulting in serious accidents.
- \*To avoid a runaway R/C model or loss of control, always follow the procedure below:
  1. Fully extend transmitter antenna.
  2. Switch on transmitter.
  3. Switch on R/C model.
- \*Follow reverse procedure to shut down.
- \*Never touch or hinder rotating tire.
- \*Never run R/C model in the rain or let run over puddles, as water may cause trouble with R/C model.
- \*Motor and battery get very hot after running. Take care when handle them.
- \*Retract transmitter antenna when not in use.
- \*Remove the batteries from model and transmitter when they are not in use.

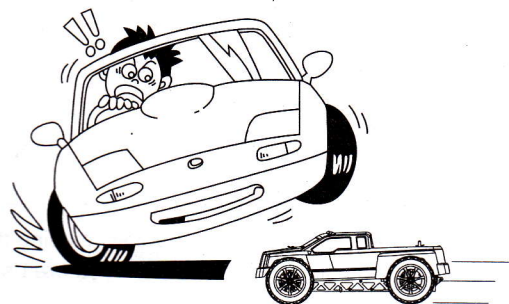

## Cautions when handling batteries

- \*Do not dismantle the battery or charger and do not cut any battery cables. This may cause short-circuit and/or damage to the product.
- \*Change battery with compatible charger following proper procedure that is called out in the instructions. Do not modify charger or charge battery in improper way.
- \*Do not recharge battery that is still warm from use as it may damage the battery. Allow the battery to cool off prior to recharging.
- \*Make sure to disconnect charger cables from R/C model and electric outlet when not in use.
- \*Remove transmitter battery when not using it for a long time as it may leak and damage transmitter when left for a long period.
- \*Never incinerate used batteries, as they can explode causing serious accidents.

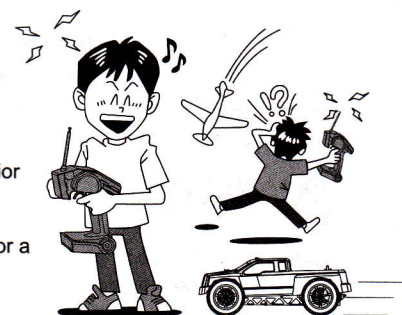

## Safety precautions

Do not operate the model on public roads, in crowded places or near infants, it may cause accidents or injury.

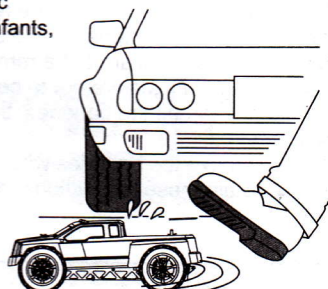

As the product includes small and sharp parts, assemble and store this product only in places out of the reach of children.

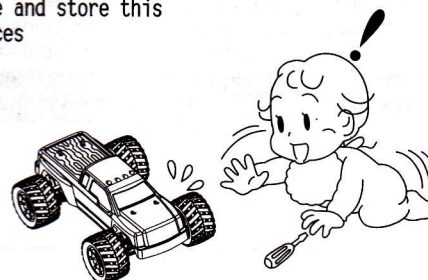

As the front end of the antenna may be dangerous, do not aim it toward faces.



During the car running and after, the motor will be hot. Please do not touch it until it has had time to cool down.

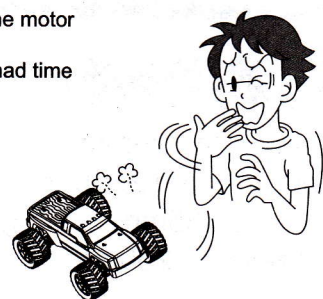

Don't use the same frequency with others at the same time. Or the car will lose control or even lead to serious accidents.

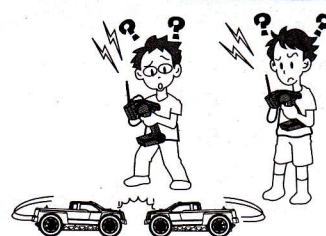

## Troubleshooting

Description	Cause	Solution
The car does not operate at all.	Transmitter or receiver is off.	Turn on both transmitter and receiver.
	Batteries are not placed properly in the transmitter.	Place batteries in the transmitter properly.
	The drive battery is not charged enough.	Charge the drive battery.
The car does not follow your operation and control distance not enough long.	Someone else is using the same radio frequency as you are using.	Charge your radio frequency to the one no one else is using, wait until the driver using the same radio frequency finishes driving, or drive your car at a different place.
	There is not enough power in the transmitter or receiver batteries.	Replace the transmitter batteries with new ones and charge the drive battery.
	Not tighten antenna on the transmitter/not fully extend antenna.	Make sure insert antenna into the transmitter and fully extend antenna.



### CAUTION

- \* Please observe the operation manual or packing explanation to install and use, and some parts should be installed by adults.
- \* The product contains small parts, it may cause swallow or choke.
- \* Never run an R/C model in the seep or rain, moisture areas, or it may cause the parts malfunction.
- \* Please throw the wrapper in time to avoid danger for the children.
- \* Regularly examine for damage to the charge, wire, plug, bodyshell or other parts. In the event of any damage, it must not be used until the damage has been repaired.
- \* The charge, battery box and battery must insert with the appointed power source of product symbol same.
- \* This product must only be used with the original collocation charger.
- \* The product is contains the functional outshoots are may be dangerous to the children.
- \* Apart the charger and toy before clean.
- \* As the front end of the antenna may be dangerous, do not aim it toward anyone's body, face or eyes.
- \* Batteries are to be inserted with the correct polarity.
- \* Use the "AA" non-rechargeable or "AA" rechargeable batteries.
- \* Non-rechargeable batteries are not to be recharged.
- \* Rechargeable batteries should only be charged under adult supervision.
- \* Rechargeable batteries must be removed from model before charger.
- \* Different types of batteries or old and new batteries are not to be mixed.
- \* Exhausted batteries are to be remove in time.
- \* The supply terminals are not to be short-circuited.
- \* Never short circuit the batteries. throw it in a fire or attempt to open their outer casings.
- \* Please remove the batteries when not in use.
- \* Please retain these instructions for future reference.

## Product Introduction

### Vehicle size parameters

- a. Car length 395mm
- b. Vehicle width 260mm
- c. Vehicles 155mm
- d. Wheelbase 250mm
- e. Tread 150mm
- f. Tire diameter 95mm
- g. 55mm wide wheel

### Vehicles configure

- a. remote control and receive the way wireless and 2.4G two configurations
- b. The full-scale remote
- c. motor uses 390
- d. Lithium iron battery 7.4V1500MA
- e. entire vehicle engineering plastics

### Vehicle performance

- a. vehicle speed 40KM / H
- b. vehicle's handling venue to the ground, sand, grass
- c. continuous manipulation of time in more than ten minutes
- d. accessories can be upgraded
- f. four-wheel independent suspension
- g. rubber tires
- h. driven approach to two drive
- i. rear wheel gear differential
- j. metal contacts Cup
- k. car shell coating explosion-proof PVC

## Proportional R/C Using Instruction

- ① Turn left the steering wheel, the car will turn left. Turning left angle can be adjusted by the degree of wheel twisting.

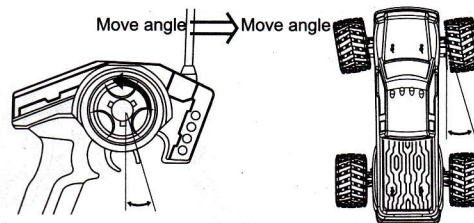

- ② Turn right the steering wheel, the car will turn right. Turning right angle can be adjusted by the degree of wheel twisting.

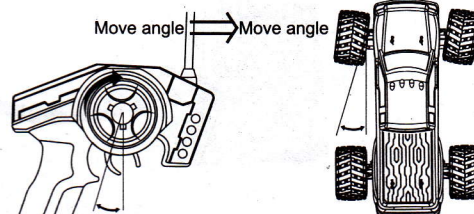

- ③ Pull the throttle trigger backward, the car will forward. Adjusting the angle of throttle trigger can adjust forward speed of the car. During the car forward, quickly push the forward to stop it.

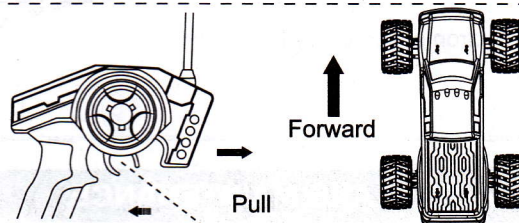

- ④ Loosen the trigger to make it return the neutral position when brake. Push the throttle trigger forward, the car will backward. Adjusting forward angle of throttle trigger adjust backward speed of the car.

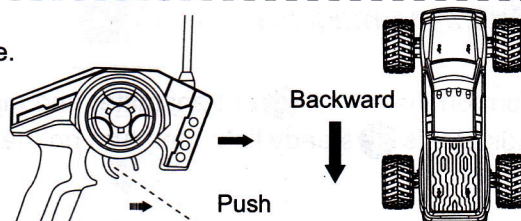

## Introduce the common tools and assemble the electron parts

### Tools needed for assembly

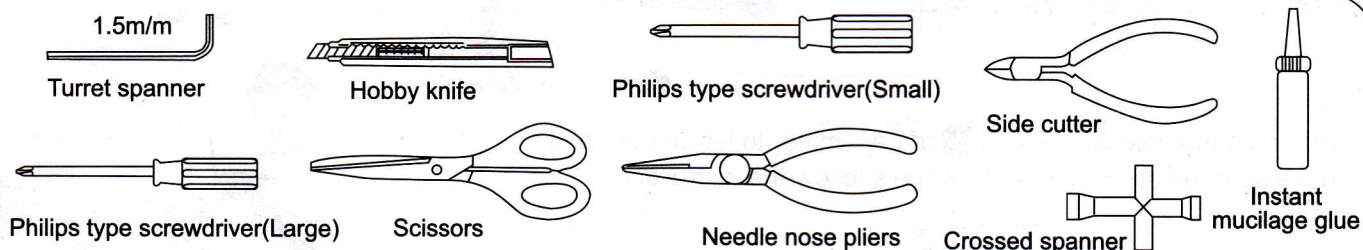

### Charge caution

#### CHARGING BATTERY

- 1) Please firstly check and confirm input voltage of the charge is consistent with local voltage, output voltage of the charge is consistent with battery voltage.
- 2) Battery must be used up before you charge, Charging time is not more than 5 hours.
- 3) Be careful to make sure there is adult to control when charging.

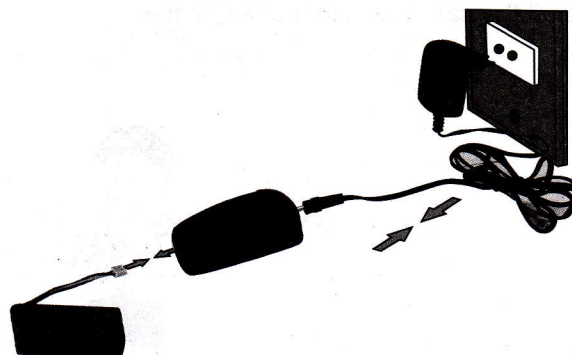

## Assemble the electron parts

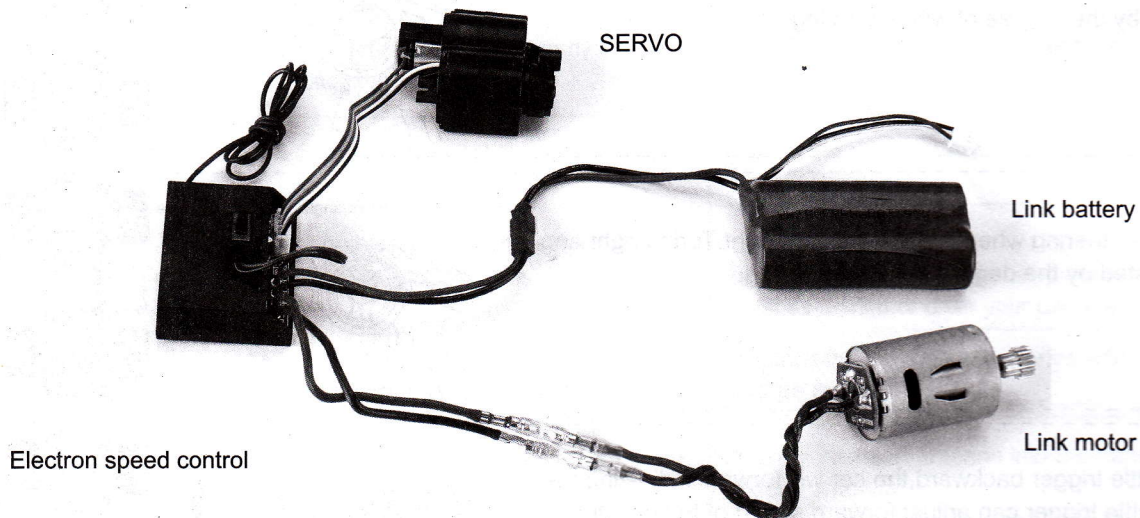

## PRACTICE AND MAINTENANCE

### Operating program

1> Turn on the switch **1** of transmitter and make sure the power indicator is **2** steady light, then turn on the car.

2> Put the car on the frame or stand. If wheel is running self-motion, adjust the trim **5** of transmitter until the wheel is still.

3> Slip the trigger **3** of transmitter slowly, you can observe the car whether it can go ahead or go back.

4> Turn steering adjusting wheel **4** of transmitter to left or right, and make sure the steering of front wheels follow the instruction.

5> Put the car on the ground and stand behind the back of the car. Squeeze the throttle trigger **3** of transmitter gently. If the car does not move in a straight line, you can adjust the trim **6** of transmitter until the car moves in a straight line.

6> OK, ready to run.

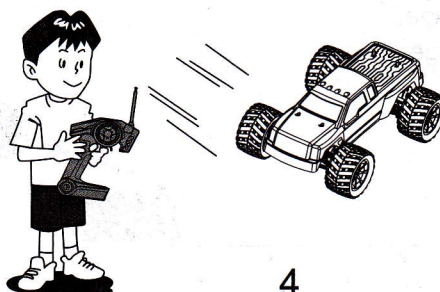
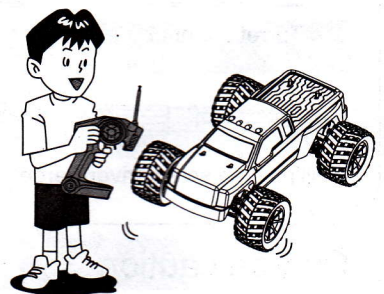
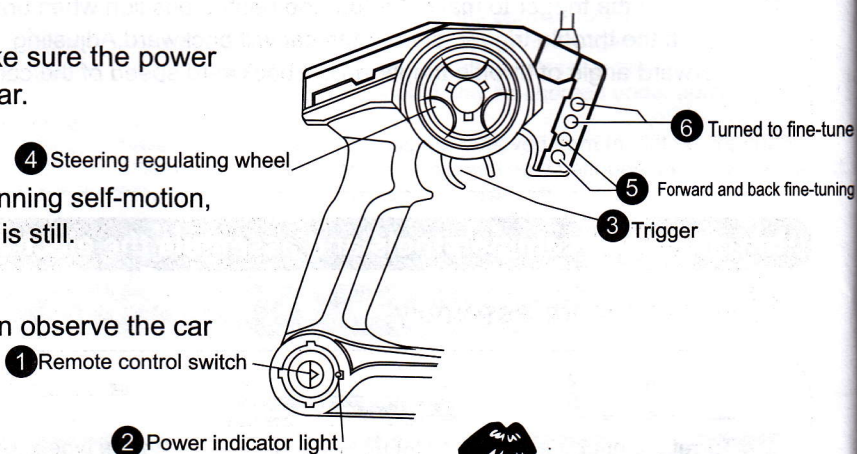

## Practice

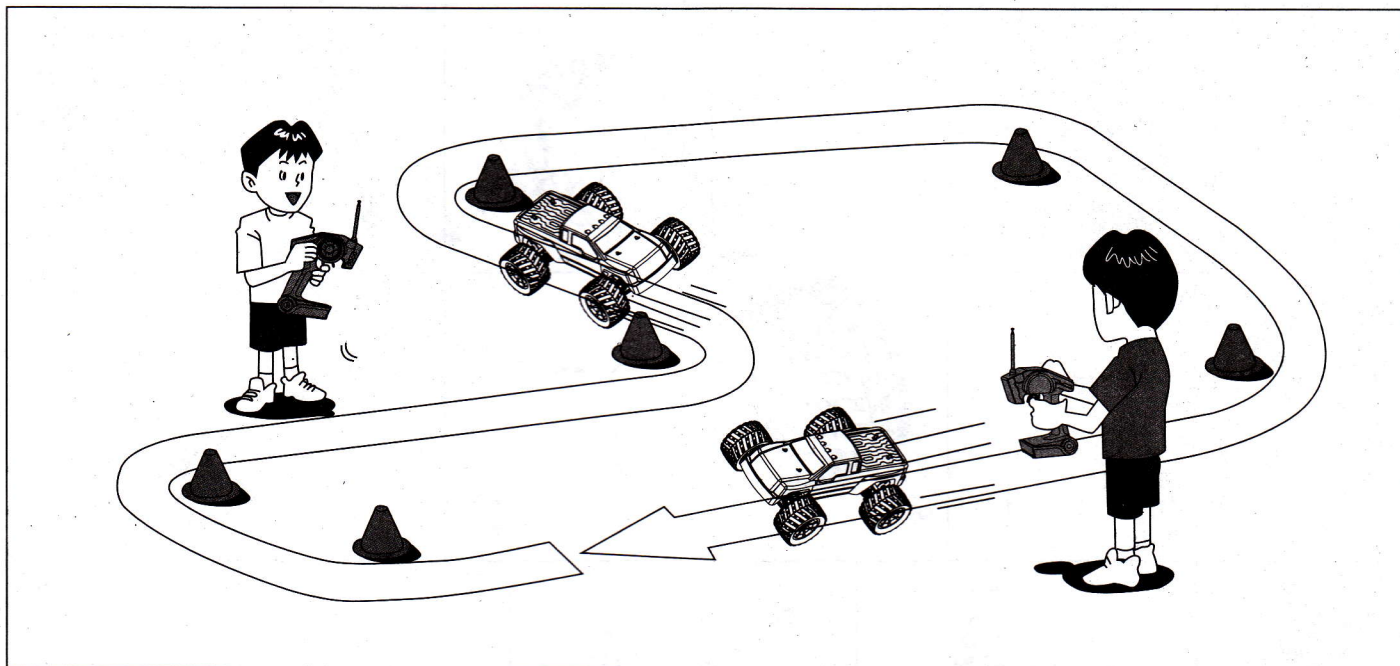

Let's practice! Make R/C car circuit at a wide and safe location using corner pylons (separately available), empty cans or such. Running fast at straight section and slow down at curved section is a basic speed control technique useful when driving R/C car.

## Maintain

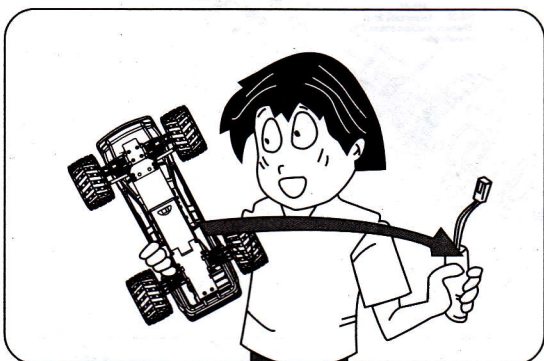

When the car is not in use, you should remove the battery from the car.

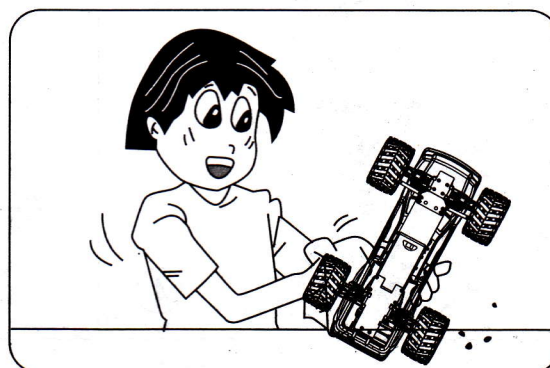

Completely remove sand, mud, dirt etc.

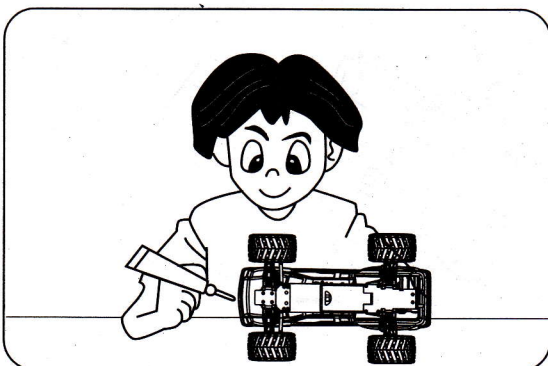

Metal outside should apply the rust prevention oil.

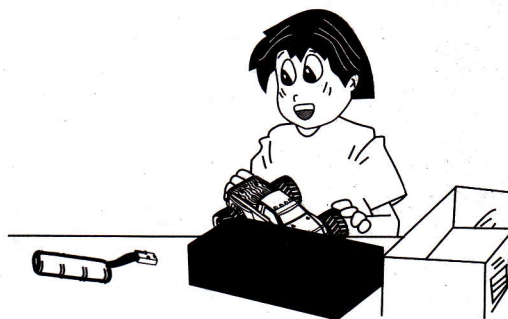

Store the car and batteries separately when not in use.

### Assembly Exploded Diagram

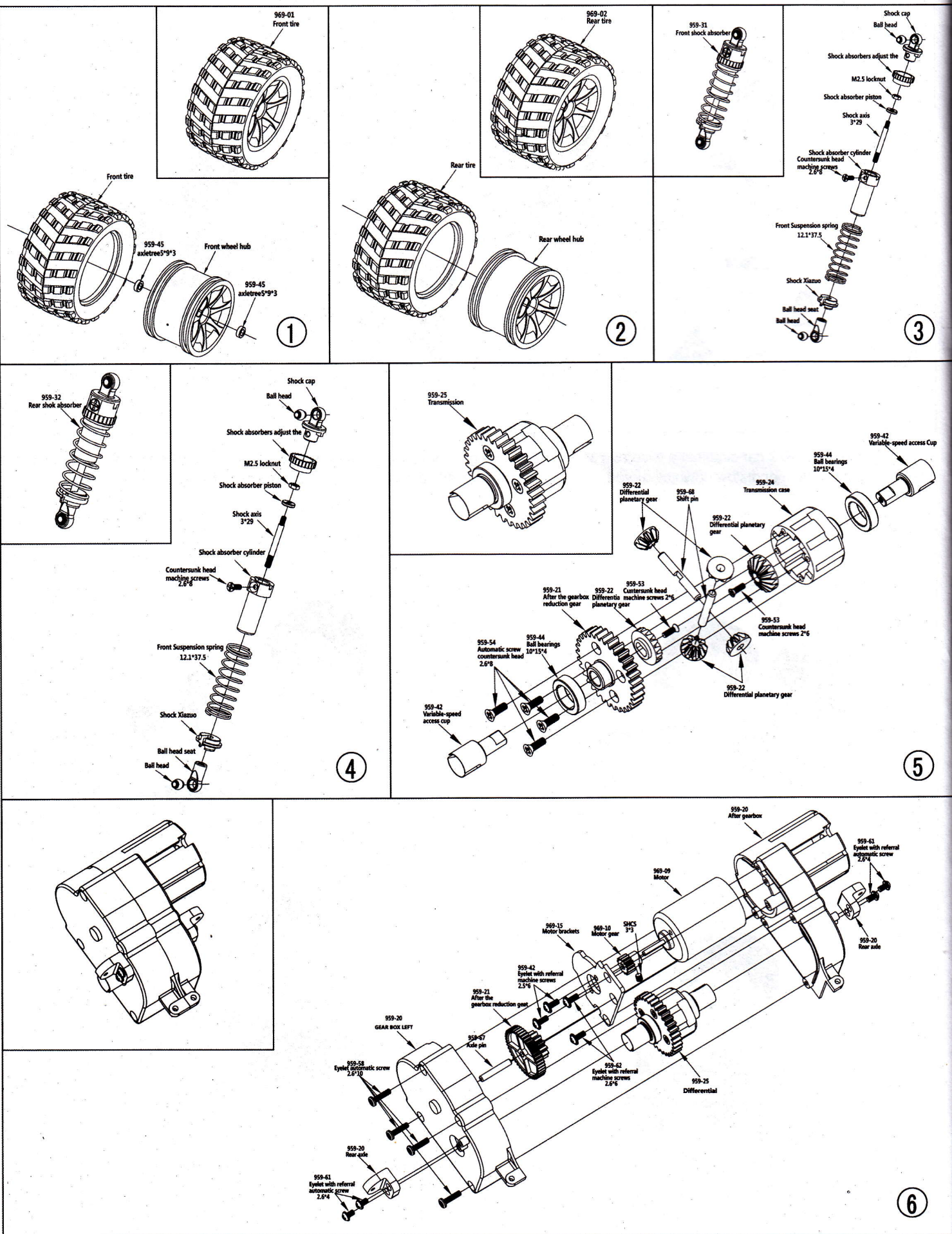

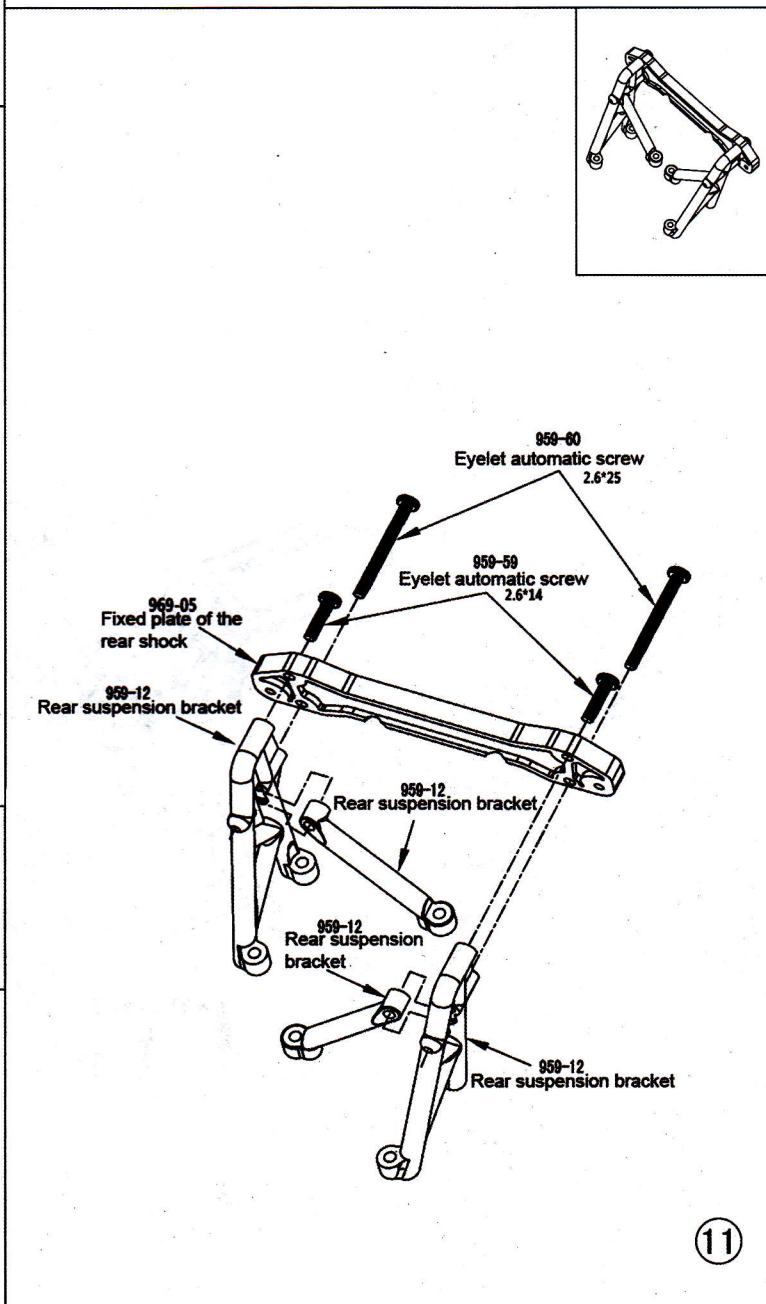
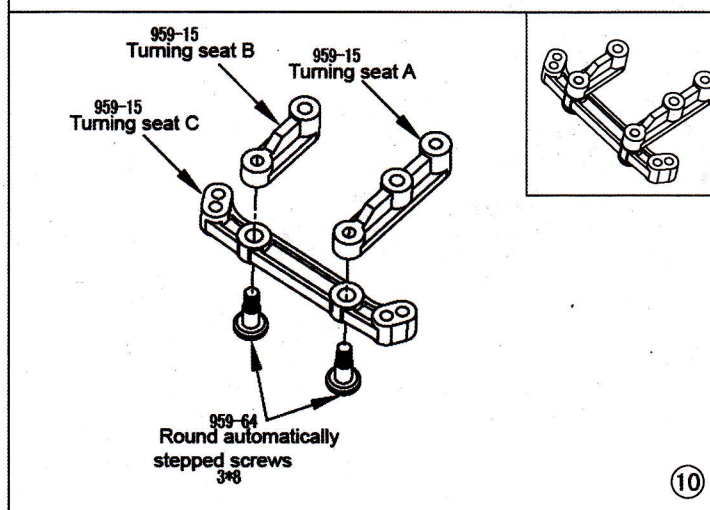
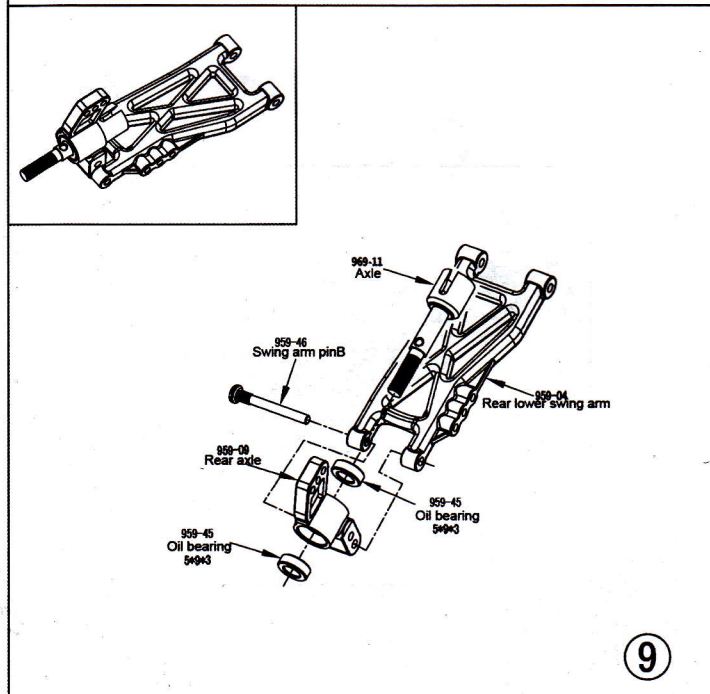
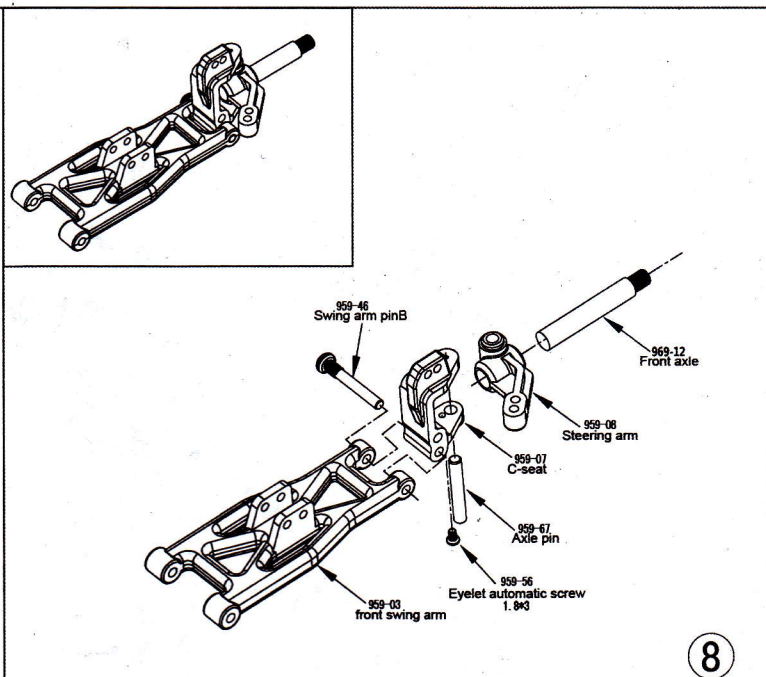
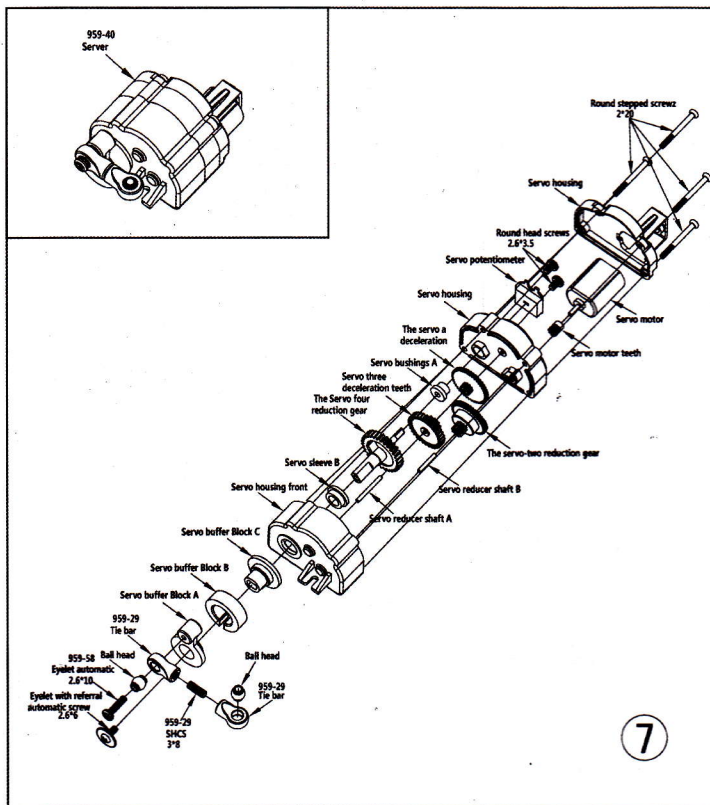

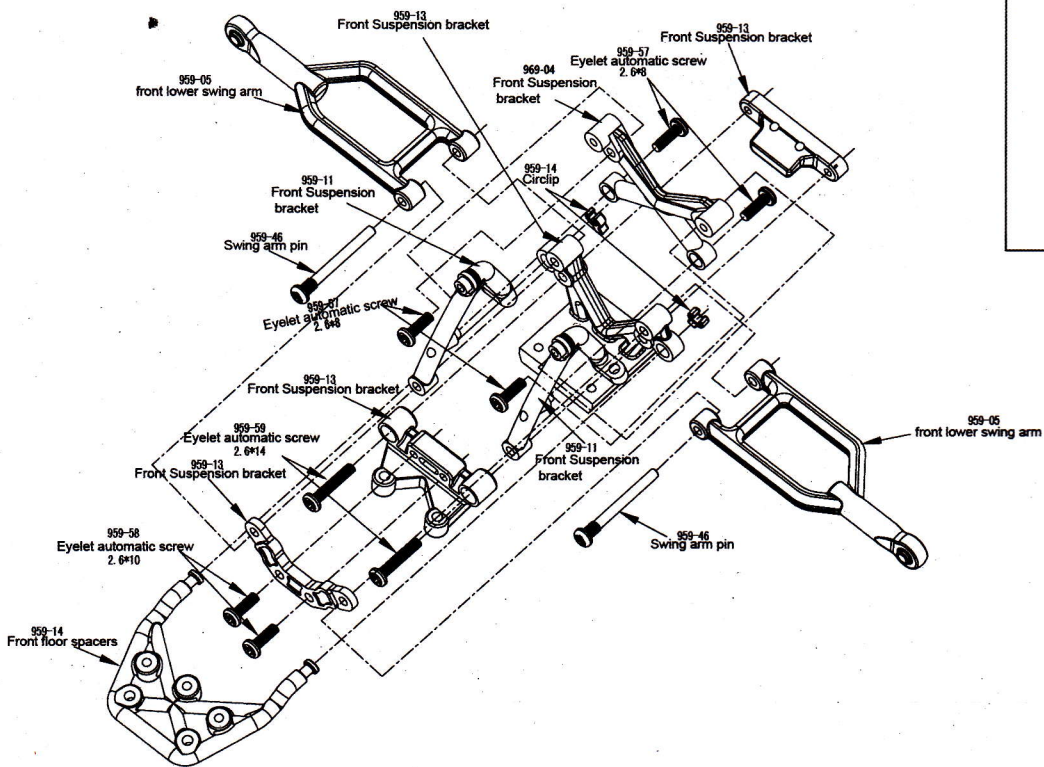

12

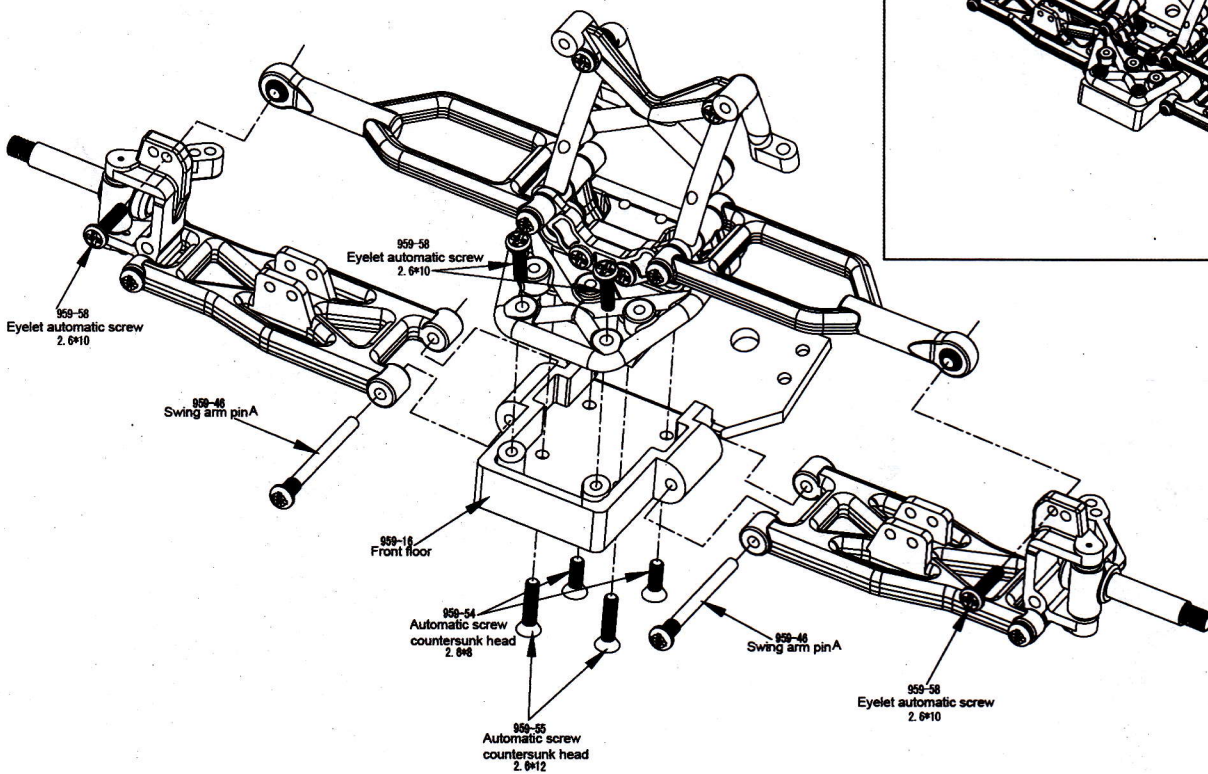

13

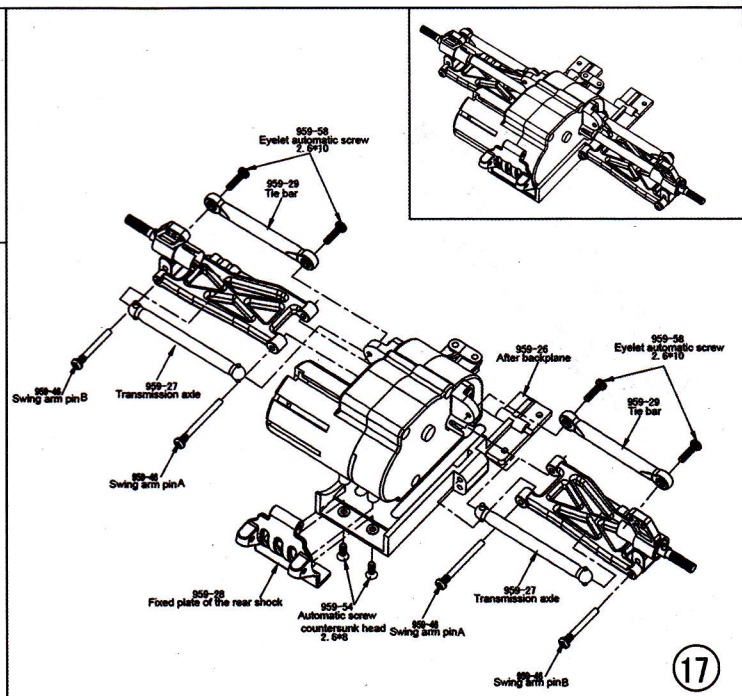
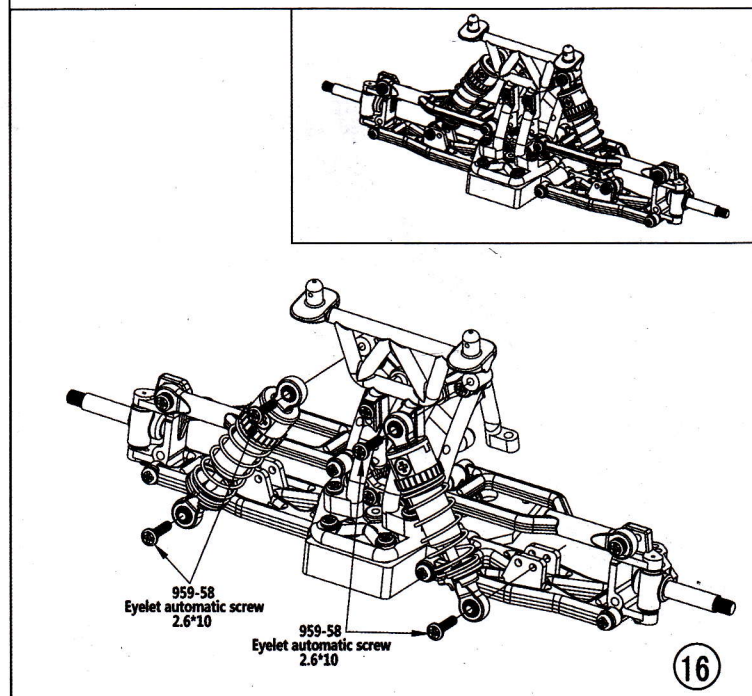
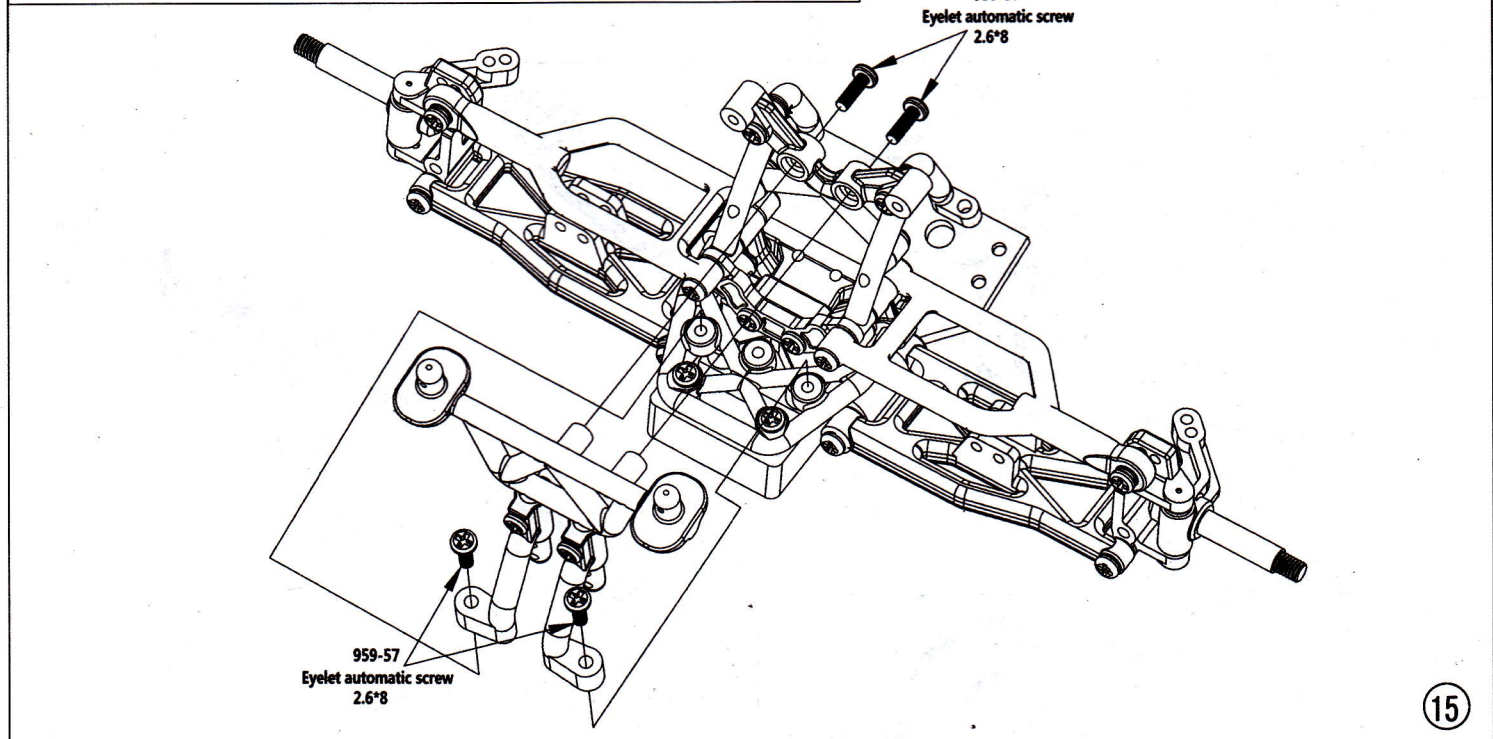
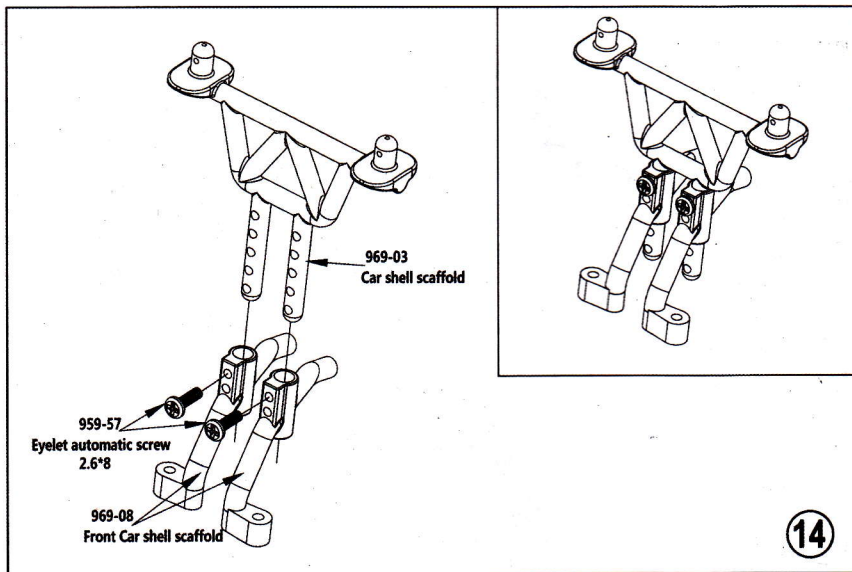

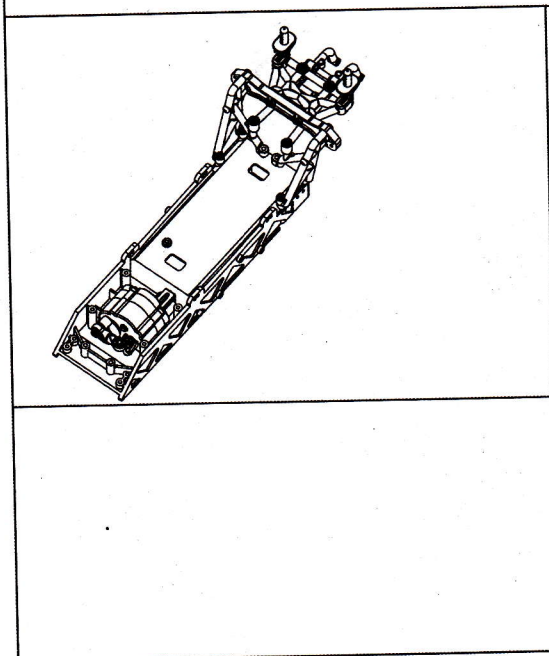
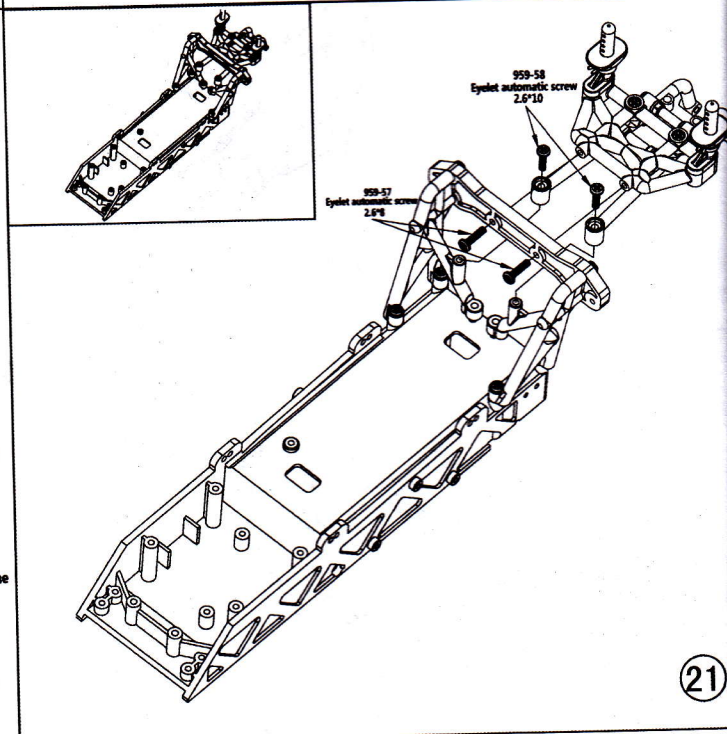
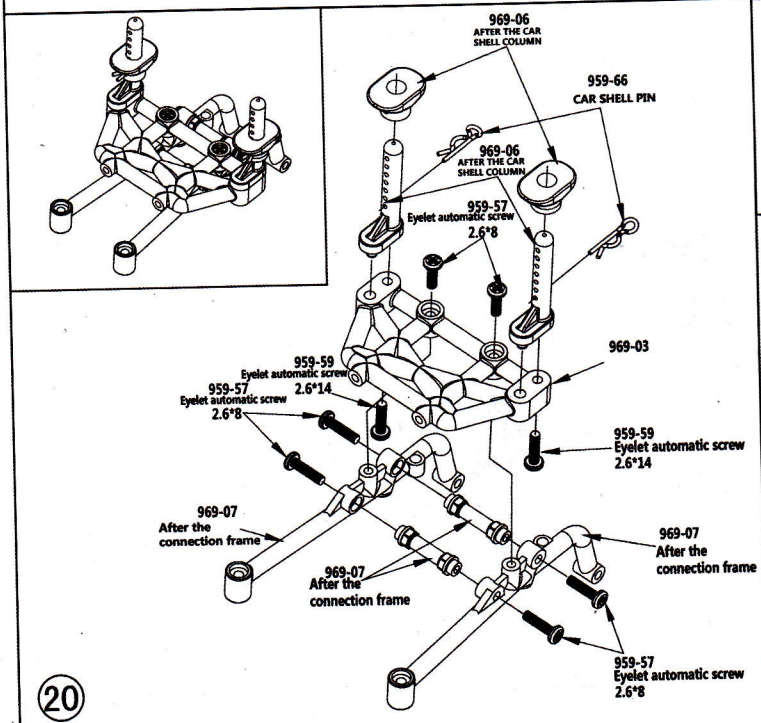
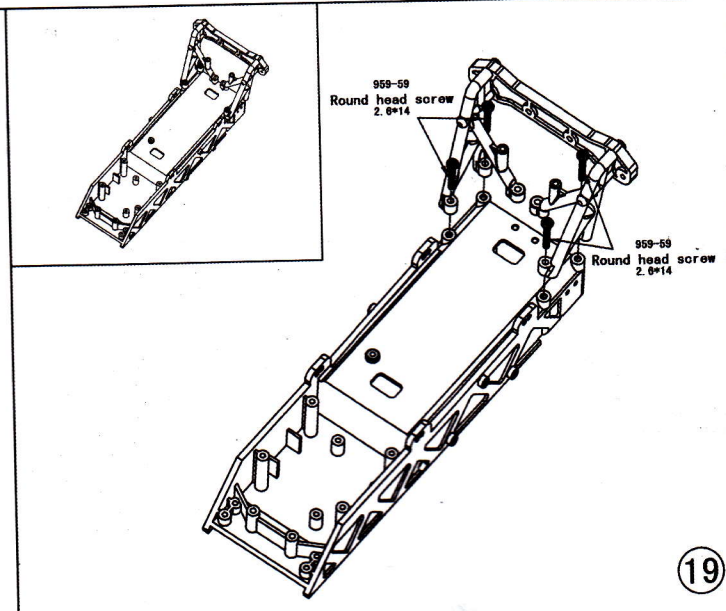
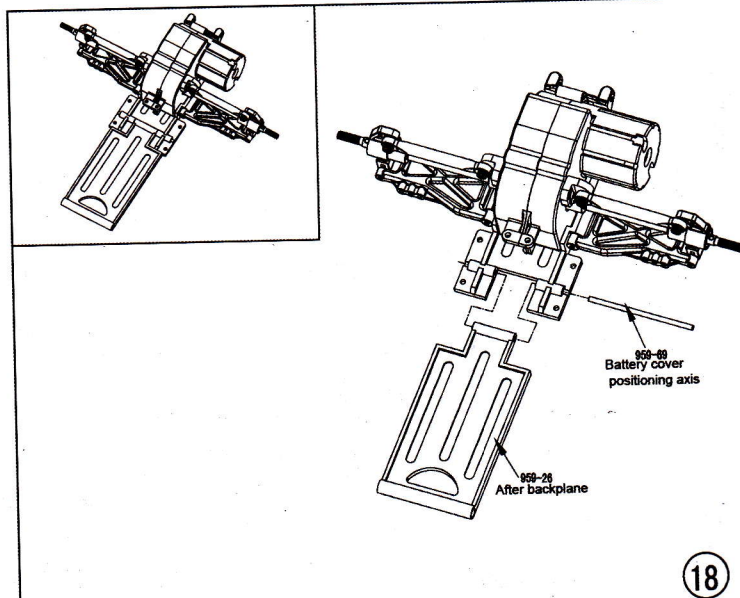

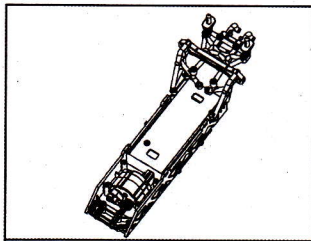

959-56  
Eyelet automatic screw  
2.6\*10

959-67  
Shaft pin

23

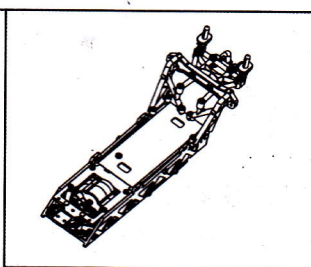

959-58  
Eyelet automatic screw  
2.6\*10

24

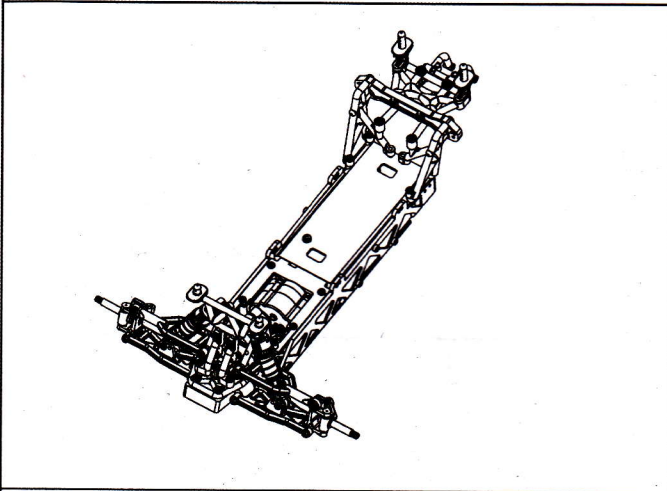

959-58  
Eyelet automatic screw  
2.6\*10

959-57  
Eyelet automatic screw  
2.6\*8

959-54  
Automatic screw  
countersunk head  
2.6\*8

25

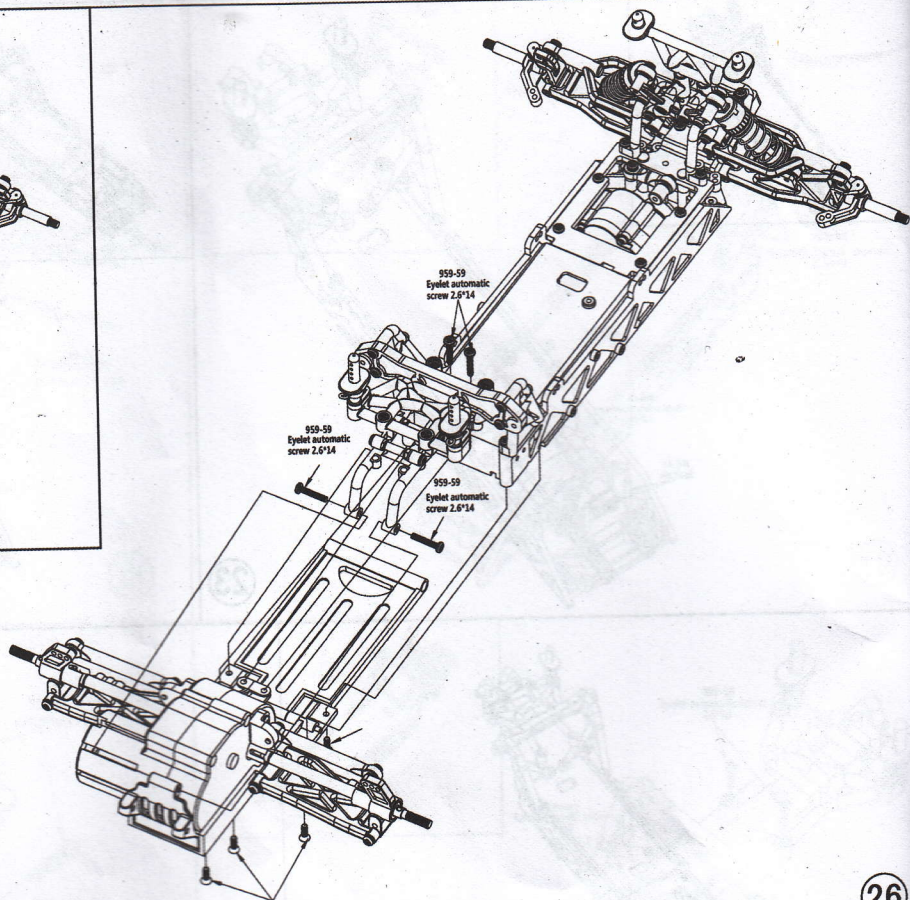
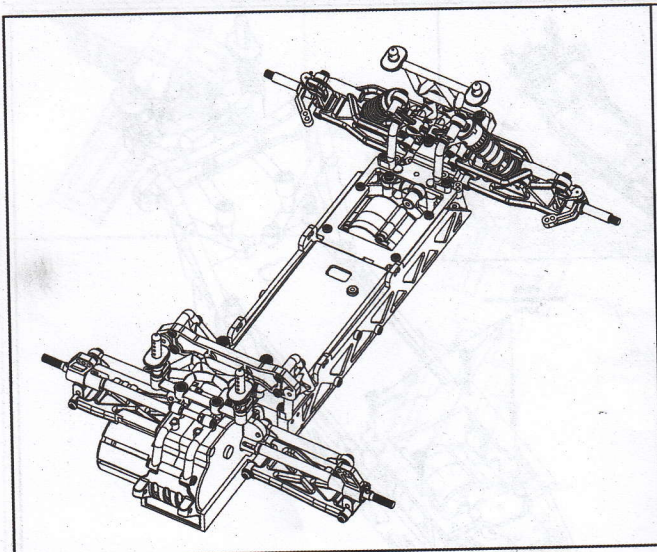

26

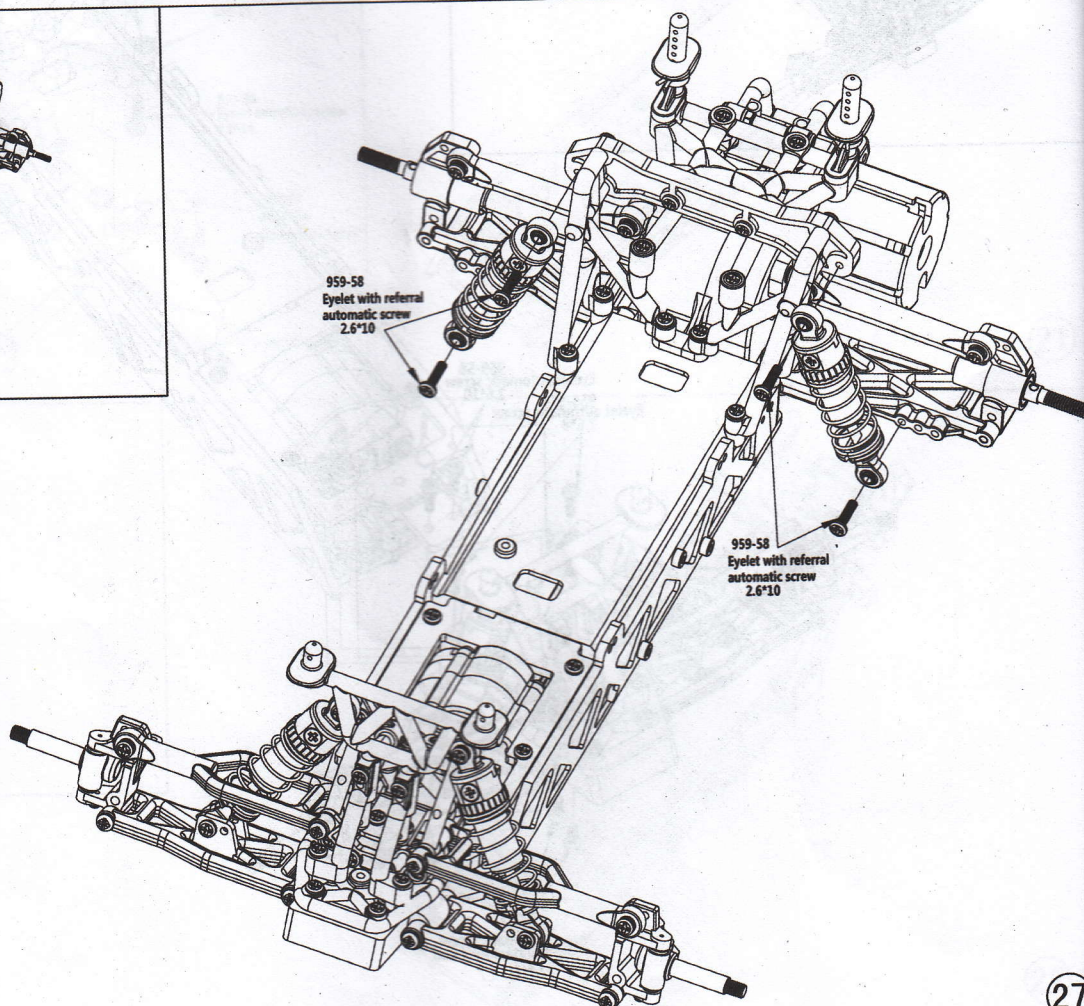
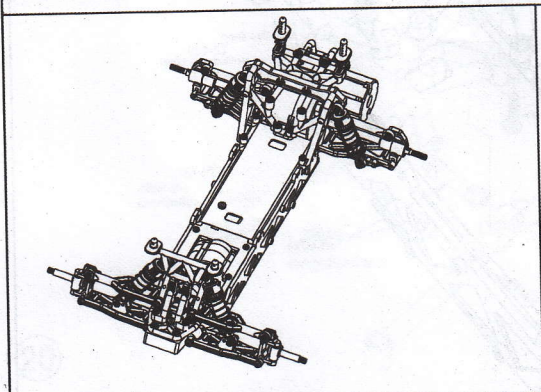

27

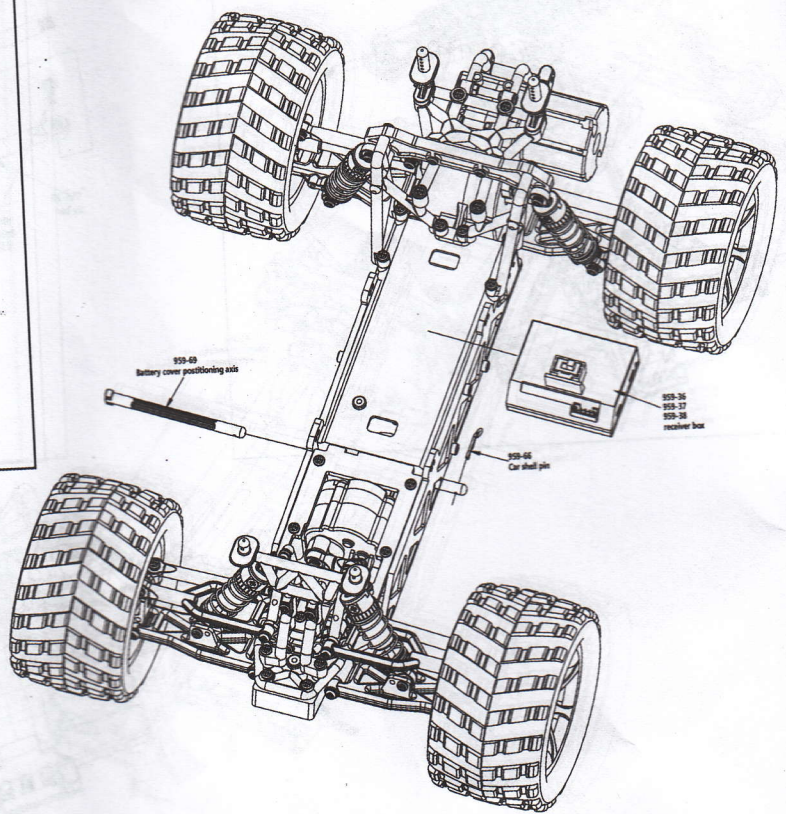
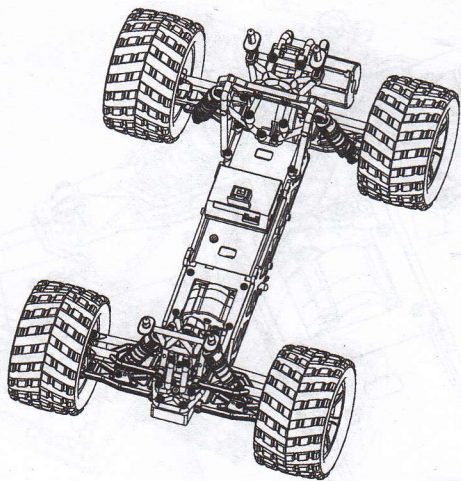

30

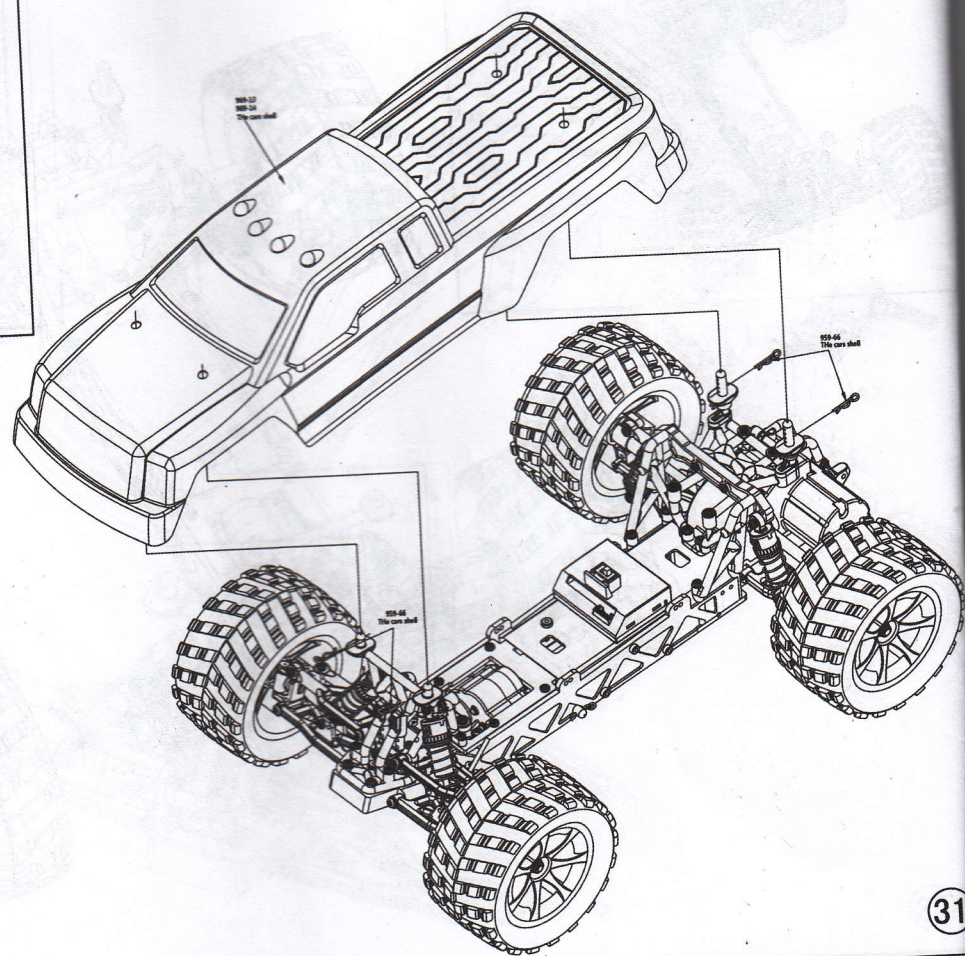
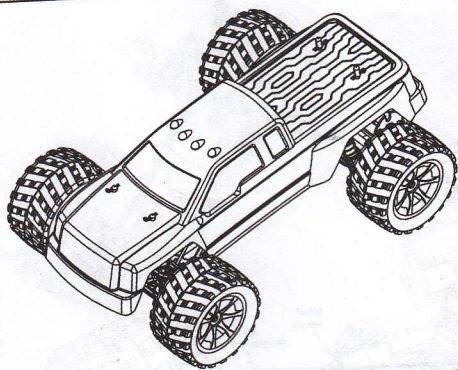

31

# Sale parts view

<b>969-01</b> 	<b>969-02</b> 	<b>969-03</b> 	<b>969-04</b> 	<b>969-05</b> 
Front tire X2	Rear tire X2	Car shell scaffold x1	Front suspension bracket x1	Fixed plate of the rear shock x1
<b>969-06</b> 	<b>969-07</b> 	<b>969-08</b> 	<b>969-09</b> 	<b>969-10</b> 
After the car shell column x2	After the connection frame x2	Vehicle ahead shell scaffold x1	MotorX1	Motor gearX2
<b>969-11</b> 	<b>969-12</b> 	<b>969-13</b> 	<b>969-14</b> 	<b>969-15</b> 
AxleX2	Front axleX2	Car shell (green)	Car shell (Red)	Motor brackets X2
<b>969-16</b> 	<b>969-17</b> 	<b>969-18</b> 	<b>959-03</b> 	<b>959-04</b> 
Lithium iron battery X1	Lithium battery X1	2.4 G receiving box of X1	Front lowerswing arm X2	Rear lower swing armX2
<b>959-05</b> 	<b>959-06</b> 	<b>959-07</b> 	<b>959-08</b> 	<b>959-09</b> 
Front swing arm X2	Bottom of the vehicle X1	C-seat X2	Steering armX2	Rear axle X2
<b>959-10</b> 	<b>959-11</b> 	<b>959-12</b> 	<b>959-13</b> 	<b>959-14</b> 
Turning the platen X1	Front Suspension bracket X1	Rear suspension bracket X2	Front Suspension bracket X1	Front floor spacers X1

# Sale parts view

959-15

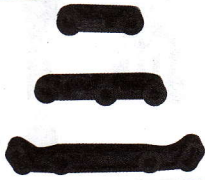

Turning seat X1

959-16



Front floor X1

959-20



After gearbox X1

959-21

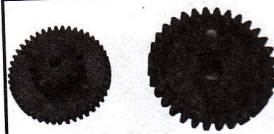

After the gearbox reduction gear X1

959-22



Differential planetary gear X1

959-23

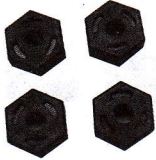

Hexagonal reel seat X4

959-24



Transmission case X2

959-25



Transmission X1

959-26

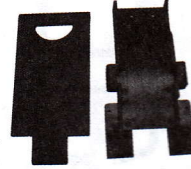

After backplane X1

959-27



Transmission axle X2

959-29



Tie bar X1

959-31

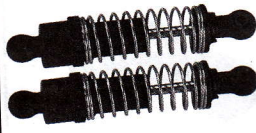

Front shock absorber X2

959-32



Rear Shock Absorber X2

959-39

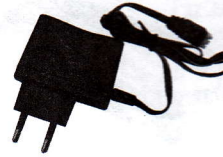

Charger X1

959-39-01

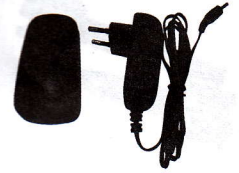

Charger X1

959-39-02

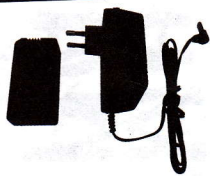

Charger X1

959-40

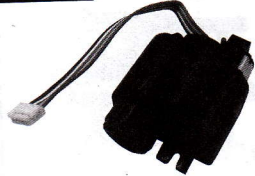

Server X1

959-42



Variable-speed access Cup X2

959-44



Ball bearings 10X15X4 X2

959-45

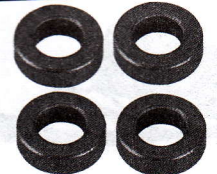

Oil bearing 5X9X3 X4

959-46

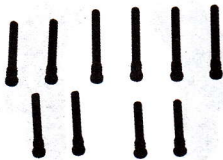

Swing arm pin X2

959-50



27MHZ Transmitter X1

959-51



40MHZ Transmitter X1

959-52



2.4G Transmitter X1

959-53



Countersunk head machine screws 2X6X10

959-54



Automatic screw countersunk head 2.6X8X10

959-55



Automatic screw countersunk head 2.6X12X10

959-56



Eyelet automatic screw 1.8X3X10

959-57











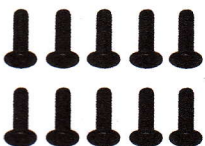

Eyelet automatic screw 2.6X8X10

959-58









Eyelet automatic screw 2.6X10X10

## Sale parts view

<b>959-59</b> 	<b>959-60</b> 	<b>959-61</b> 	<b>959-62</b> 	<b>959-63</b> 
Eyelet automatic screw 2.6X14X10	Eyelet automatic screw 2.6X25X10	Eyelet with referral automatic screw 2.6X4X10	Eyelet with referral automatic screw 2.6X6X10	Eyelet with referral machine screws 2.5X6X10
<b>959-64</b> 	<b>959-65</b> 	<b>959-66</b> 	<b>959-67</b> 	<b>959-68</b> 
Round automatically stepped screws 3X8X10	M4 locknut X4	Car shell pin X8	Axle pin X2	Shift pin X4
<b>959-69</b> 				
Battery cover positioning axis X2				

## PRO Sale parts view

<b>959-P-01</b> 	<b>969-P-01</b> 	<b>959-P-03</b> 	<b>959-P-04</b> 	<b>959-P-05</b> 
Battery x1	Brushless motor x1	Brushless electric adjustable x1	Transmission axle x2	Whole vehicle bearing
<b>959-P-06</b> 				
Brushless receiver plate X1				