

**iPazzPort® 艾拍宝®**

# **User Manual**

**使用说明**

**Mini Wireless Keyboard**

**迷你无线键盘**

**Model(型号): KP-810-09**

**Rev. 1.0**

**[www.iPazzPort.com](http://www.iPazzPort.com)**

#### Introduction:

This Mini Wireless Keyboard consists of keyboard, mouse touchpad, and LED(optional) which is designed small and portable size. It provides people a unique & capable tool to operate their PC, Google/Android/Smart etc. device wirelessly. it is widely used for:

- The people who need to be apart from their devices yet must control it for their presentation, teaching and lecturing with large screen or projector, up to 33 feet wireless operation distance provides you big free space to communicate with your audience.
- The people who want to sit at their easy and comfortable chair to view the internet content, network television, such as IPTV, Google/Android/Smart TV, box or internet movies instead of physically change its channel, it is a really computer remote controller, of course not a TV remote controller.

#### What's in your Package?

In the package with Mini Wireless Keyboard you will find an USB extended cable and this manual.

#### Features and specifications:

- RF 2.4GHz wireless connection,
- Portable size: 158\*56\*14mm
- Working voltage: 3.3V
- QWERTY keyboard
- Google TV keyboard
- Multi-language support
- Multi-touch mouse pad
- Battery: 2 x 3AAA
- Weight: 87g

1

#### System Requirement:

- Windows
- Linux
- Mac OS
- Android/Google/Smart TV

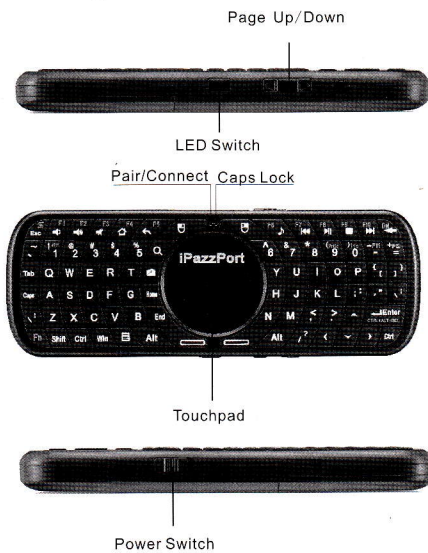

Page Up/Down

LED Switch

Pair/Connect Caps Lock

Touchpad

Power Switch

2

Function	Description	Operation
	Change operation directions	Press Fn+Esc
RF	Pair with USB receiver	Press Fn+1
F1	F1	Press Fn+
F2	F2	Press Fn+
F3	F3	Press Fn+
F4	F4	Press Fn+
F5	F5	Press Fn+
F6	F6	Press Fn+
F7	F7	Press Fn+
F8	F8	Press Fn+
F9	F9	Press Fn+
F10	F10	Press Fn+
Del	Delete	Press Fn+
PrtSc	Print screen	Press Fn+9
Ins	Insert	Press Fn+0
F11	F11	Press Fn+-
F12	F12	Press Fn+=
Ctrl+Alt+Del	Ctrl+Alt+Del	Press Fn+Enter
	Volume down	Press
	Volume up	Press
	Mute	Press
	Return to home page	Press
	Return to upper	Press
	Open the "music"	Press

3

Function	Description	Operation
	Previous	Press
	Stop	Press
	Play	Press
	Next	Press
	Backspace	Press
	Search	Press
	Open the "email"	Press
Home	Home	Press Home
End	End	Press End

## How to use

1. Remove battery cover to install battery, and take USB dongle out

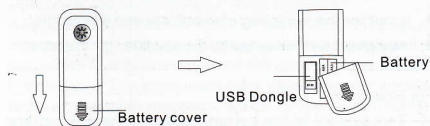

1. push downward
2. Take USB Dongle out

2. Turn unit on by switching power button to on, LED will flash one time then go out.

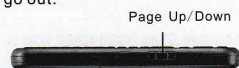

4

### 3. Change operation directions:

As we know, some times, we want to operate the wireless keyboard vertically, and some times horizontally, when operation direction is changed from vertical to horizontal, but touchpad will not, for example, supposed you operate unit vertically, and you slide your finger on the touchpad vertically, the mouse cursor on the screen of computer will move vertically but when operation direction is changed from vertical to horizontal, when you slide your finger vertically and mouse cursor will move horizontally, now please press key Fn together with key Esc to change its operation direction, and mouse cursor will move with your finger direction.

#### WEEE Directive & Product Disposal



At the end of its serviceable life, this product should not be treated as household or general waste. It should be handed over to the applicable collection point for the recycling of electrical and electronic equipment, or returned to the supplier for disposal

#### Notice to customer:



This symbol on the battery indicates that the battery is to be collected separately.  
The following apply only to users in European countries.  
This battery is designed for separate collection at an appropriate collection point.  
Do not dispose of as household waste  
For more information, contact the retailer or local authorities in charge of waste management.

#### Caution :

Changes or modifications not expressly approved by the party responsible for compliance could void the user's authority to operate the equipment.

#### Compliance statement:

1: This device is verified to comply with Part 15 of the FCC Rules.

Operation subject to the following two conditions:

- (1) this device may not cause harmful interference, and
  - (2) this device must accept any interference received, including interference that may cause undesired operation.
- 2: This equipment has been tested and found to comply with the limits for a Class B digital device, pursuant to Part 15 of the FCC Rules. These limits are designed to provide reasonable protection against harmful interference in a residential installation. This equipment generates, uses and can radiate radio frequency energy and, if not installed and used in accordance with the instructions, may cause harmful interference to radio communications. However, there is no guarantee that interference will not occur in a particular installation. If this equipment does cause harmful interference to radio or television reception, which can be determined by turning the equipment off and on, the user is encouraged to try to correct the interference by one or more of the following measures:
- Reorient or relocate the receiving antenna.
  - Increase the separation between the equipment and receiver.
  - Connect the equipment into an outlet on a circuit different from that to which the receiver is connected.
  - Consult the dealer or an experienced radio/TV technician for help

Notes: When your device disturbs the mini bluetooth keyboard, you can use the USB extended cable to connect the USB receiver to avoid the interference