

# iPazzPort Cast

Model: NC-812-16C

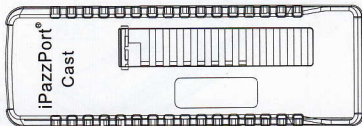

## User Manual

## Introduction

Unisen iPazzPort Cast is a mini engine to turn your Home HD Screen become a All Media Sharing Center by Smart phone or tablet you already own.

The iPazzPort Cast is so tiny, so portable, don't leave it at home. You need it for sharing your favourite Video or lovely photos with family and friends. Just plug in iPazzPort Cast to HD socket of the HD Screen set with at everywhere , family home, hotel room or business meeting room? Yes. You still need a local WiFi connection. iPazzPort Cast is a fully Compatible to Android and iOS operating system, Wi-Fi display technology, it supports DLNA, Airplay and Miracast Protocol which is enable to mirror or cast streaming video, pictures from your Smart phone or tablet onto HD Screen.

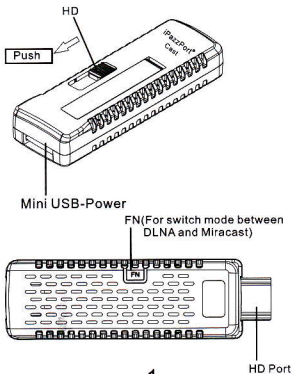

## iPazzPort cast

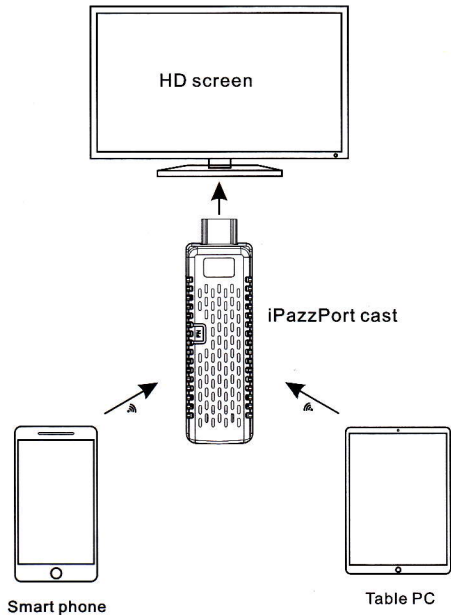

## Connect the power and start up the iPazzPort cast

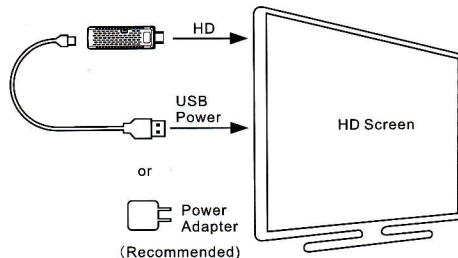

1. Turn on the HD Screen and change the video input to HD port.
2. Plug the iPazzPort cast into the HD port of the HD Screen, if needed, please use a HD extension cable.
3. Connect one end of USB cable to the iPazzPort cast, and the other end to the USB port of HD Screen
4. Some HD Screens can not provide enough power through USB port so we need to use a 5V/1A adapter.

## Foreword

This product is mini portable wireless design, before using, please follow steps to confirm the Wi-Fi signal strength. Place the "iPazzPort Cast" at the correct position, and get the best using for it.

### 1. Test the signal strength of Wi-Fi Router.

- 1.1 Download "WiFi Analyzer" in App Store to your phone or tablet.
- 1.2 Place your phone or tablet at the position, where the "iPazzPort Cast" will be placed.
- 1.3 Run "WiFi Analyzer" to confirm the Wi-Fi Router signal strength is -60dB or above as show below. If the signal strength is low, please move the Wi-Fi router or iPazzPort Cast to match the best using.

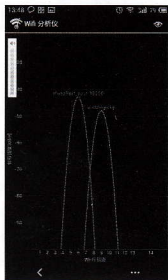

### 2. Test the receiving signal strength of iPazzPort Cast.

- 2.1 Download "WiFi Analyzer" in App Store to your phone or tablet.

### 2.2 Place the "iPazzPort Cast" at the correct position.

Power it on, switch to DLNA method.

### 2.3 Take the phone or tablet away 4m from iPazzPort Cast.

### 2.4 Run "WiFi Analyzer" to confirm the receiving signal strength is -60dB or above, as show below.

- 2.5 If the signal is low, please move "iPazzPort Cast" or connect to HD extended cable. Please make sure to no block the Wi-Fi signal.

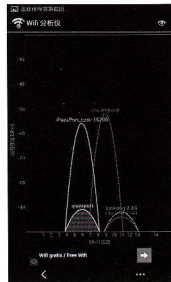

eg. HD screen is made by metal components. If the Wi-Fi router or mobile is at the front of the HD screen, while "iPazzPort Cast" plug at the back of the HD screen. At the moment, HD screen sits between "iPazzPort Cast" and "Wireless Router (or cell phone)", which will affect the "iPazzPort Cast" receiving signal from wireless router or cell phone.

Before connecting the iPazzPort Cast to phone, please exit the Apps run at the background and reconnect Wi-Fi

## iOS



1. Close All Apps run on background



6. Getting IP address

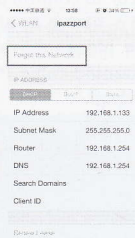

2. Forget the Network

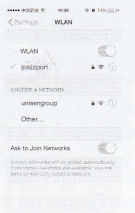

5. Connected successfully



3. Choose the WiFi router



4. Enter Password

## Android



1. Close All Apps run on background



6. Getting IP address



2. Forget the Network

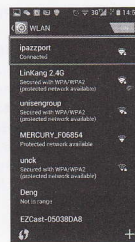

5. Connected successfully

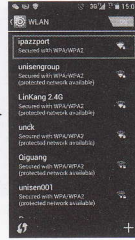

3. Choose the WiFi router

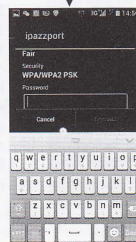

4. Enter Password

# DLNA Method

The device's App must support DLNA or Airplay

- Suggestion
1. Playing the video in DLNA method;
  2. Browsing the web and viewing pictures in Miracast method;
  3. Playing games, the transfer data is large, it is for testing.
  4. Because smart phone/tablet devices's compatibility is inconsistent, not all devices have the best experience in Miracast Method, so please test DLNA, Miracast and installing iMediaShare separately to get the best using method. In Miracast Method, if failed to get the best experience, please fix to operate iPazzPort Cast in DLNA Method.

## 1. Connect WiFi

The iPazzPort cast screen

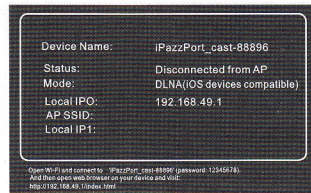

Phone screen



1. Go to settings, displays iPazzPort\_cast\_88896

2. Enter password "12345678" Press "connect"

3. Connected Successfully

The iPazzPort  
cast screen

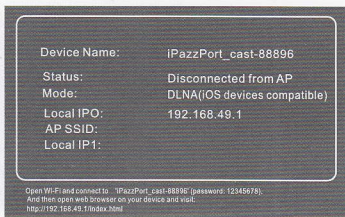

The iPazzPort  
cast screen

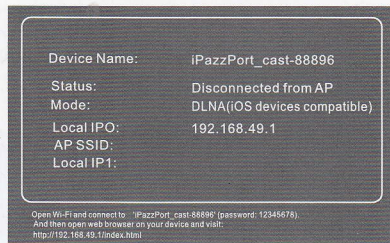

Phone  
screen

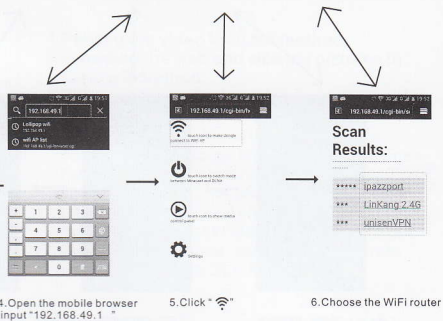

Phone  
screen



7. Input password---Click connect

8. (1) Connected successful, cast your photo or video immediately.
- (2) Returns the phone to the setting interface window, change the Wi-Fi connection from "iPazzPort Cast" to "Wi-Fi router".  
(It is optional for the two ways)

The iPazzPort  
cast screen

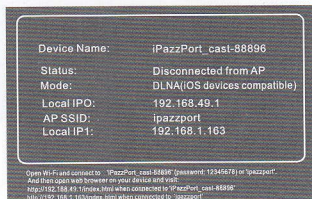

Phone  
screen



## 9. Video playing

The iPazzPort  
cast screen

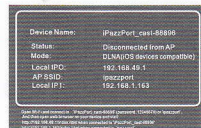

Touch the DLNA logo

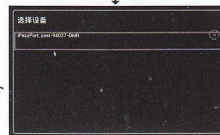

Touch iPazzPort\_cast-94027-(DMR) must be

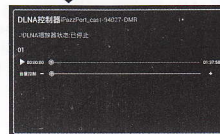



# DLNA method with iMediaShare

Download and install iMediaShare from google play on smart phone  
(Supports under 4.2 Android system)

Suggestion

1. Playing the video in DLNA method;
2. Browsing the web and viewing pictures in Miracast method;
3. Playing games, the transfer data is large, it is for testing.
4. Because smart phone/tablet devices's compatibility is inconsistent, not all devices have the best experience in Miracast Method, so please test DLNA, Miracast and installing iMediaShare separately to get the best using method. In Miracast Method, if failed to get the best experience, please fix to operate iPazzPort Cast in DLNA Method.



Click "iMediaShare"



Photos



Videos



Music

Note: Playing the photos/videos/music must choose DMR method.

# Miracast Method

The device must be Android 4.2 above system or integrated with the feature, Same as Wi-Fi display. e.g allshare cast on Samsung mobile phone

Suggestion

- 1.Playing the video in DLNA method;
- 2.Browsing the web and viewing pictures in Miracast method;
- 3.Playing games,the transfer data is large,it is for testing.
- 4.Because smart phone/tablet devices's compatibility is inconsistent, not all devices have the best experience in Miracast Method, so please test DLNA,Miracast and installing iMediaShare separately to get the best using method. In Miracast Method, if failed to get the best experience, please fix to operate iPazzPort Cast in DLNA Method.

- 1.Press "Fn" switch to "Miracast" mode.  
(Android 4.2 system)

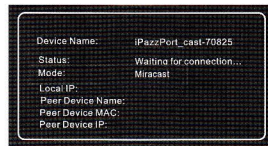

The iPazzPort  
cast screen

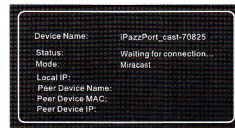

Phone  
screen



- 2.Select "settings"on mobile, Touch"display"

### 3. Open "Wireless display", connect "iPazzPort\_cast\_70825"

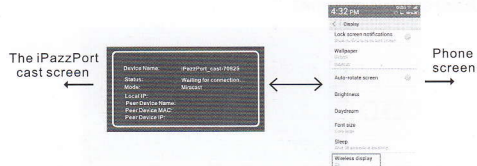

### 4. Connected successfully, sync to phone screen to HD screen

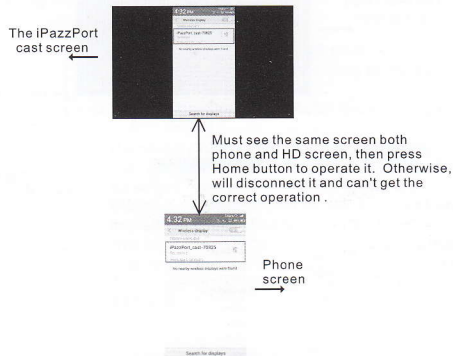

### Android 4.1 system, for example Samsung mobile phones

#### 1. Press "Fn" switch to "Miracast" mode.

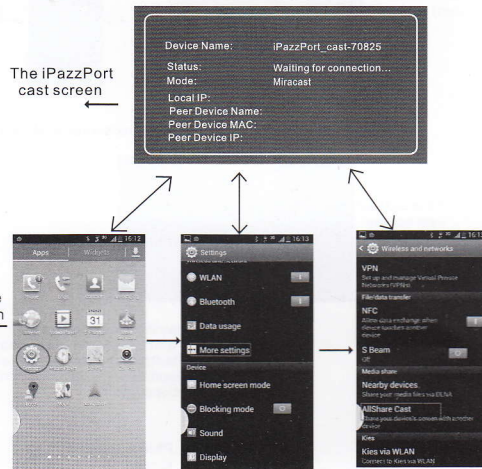

#### 2. Enter "Settings", Touch "More settings", next "AllShare Cast"

### 3. Open "AllShare Cast", connect "iPazzPort\_cast\_70825"

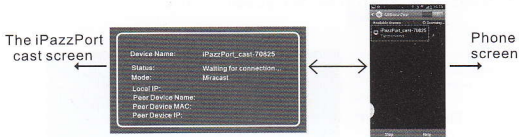

### 4. Connected successfully, sync to phone screen to HD screen

