



CAUTION
RISK OF ELECTRIC SHOCK
DO NOT OPEN



CAUTION: TO REDUCE THE RISK OF ELECTRIC SHOCK, DO NOT REMOVE COVER (OR BACK), NO USER SERVICEABLE PARTS INSIDE. REFER SERVICING TO QUALIFIED SERVICE PERSONNEL.



The lightning flash with arrowhead symbol, within an equilateral triangle, is intended to alert the presence of uninsulated dangerous voltage within the product enclosure that may be of sufficient risk of electric shock for persons.



The exclamation point within an equilateral triangle is intended to alert the presence of important operating and maintenance (servicing) instructions in the literature accompanying the appliance.

WARNING: TO PREVENT FIRE OR SHOCK HAZARD, DO NOT EXPOSE THIS APPLIANCE TO RAIN OR MOISTURE.

User Manual

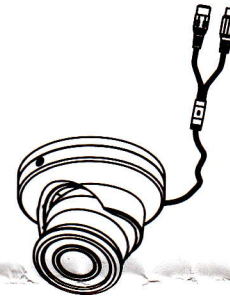

CONNECTORS AND CONTROLS

1. one monitor system with one camera.

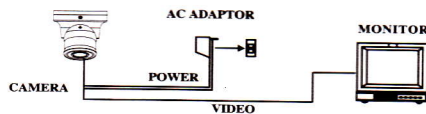

2. One monitor system with two or more cameras.

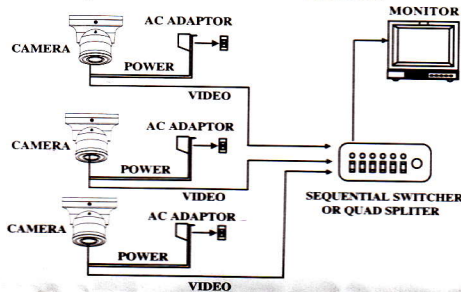

Notes on Installation and usage

1. Do not attempt to disassemble the camera

To prevent from electric shock, do not remove screws or cover. There are no serviceable parts inside. Ask a qualified service person for servicing.

2. handle the camera with care

Do not abuse the camera. Avoid striking, shaking, etc., the camera could be damaged by improper handling or storage.

3. Do not expose the camera to rain or moisture or try to operate it in wet areas

Turn the power off immediately and ask a qualified service person for servicing. Moisture can damage the camera and also create the danger of electric shock.

4. Do not use strong or abrasive detergents when cleaning the camera body

Use a dry cloth to clean the camera when dirty. In case the dirt is hard to remove, use a mild detergent and wipe gently.

5. Clean the CCD faceplate with care

Do not clean the CCD with strong or abrasive detergents. Use lens tissue or a cotton tipped applicator and ethanol.

6. Never face the camera towards the sun

whether the camera is in use or not. Never face it towards the sun or other extremely bright objects. Otherwise, blooming or smear may be caused.

7. Do not operate the camera beyond the specified temperature, humidity

Use the camera under conditions where temperature is -10°C ~ $+50^{\circ}\text{C}$ and humidity is below 90%.

8. The camera should be operated only from the type of power source indicated on the marking label

COLOR CCD CAMERA

(Image Sensor)	1/4" Color CCD
(Horizontal Resolution)	540TV lines
(TV System)	PAL/NTSC
(Effective Pixels)	PAL: 720(H) x 576(V) NTSC: 720(H) x 480(V)
(Minimum Illumination)	color 0.05Lux: (IR 0 Lux)
(Infrared distance)	-
(S/N Ratio)	$\geq 48\text{dB}$
(lens)	1.3mm
(Angle)	ceiling mount, wall mount
(Operating Temperature)	-10°C ~ 85°C
(Video Out)	1.0V p-p 75ohm,
(Scanning System)	2:01
(Auto Gain Control)	auto
(Back Light Comp)	auto
(White Balance)	auto
(work power)	70mA
(Power)	12V DC/500mA



Image showed on monitor will be on right direction only if you adjusted the camera direction as per the arrow shows

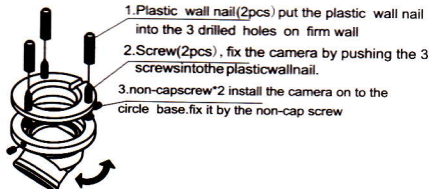

Adjust the picture direction by spinning the camera (max 180 degree)

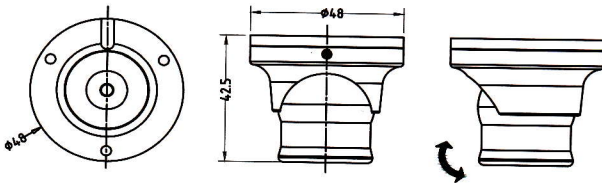

Focal length of camera lens (mm)	1/3chipset	1/4chipset
2.5	96.4	81.9
2.8	90	75.6
3.6	75.7	62.2
4	70	57
6	50	39.8
8	38.5	30.4
12	26.2	20.5
16	19.8	15.4
25	10.6	8.3
60	5.3	4.1
3.5~16mm	74~20	55~15
4~9mm	72~34	
2.8~12mm	92.6~24.8	
6~60mm	52~6	

IR Distance

- | | | |
|---------------------------------|---------------------------------|---------------------------------|
| <input type="radio"/> 10 Meter | <input type="radio"/> 12 Meter | <input type="radio"/> 15 Meter |
| <input type="radio"/> 20 Meter | <input type="radio"/> 25 Meter | <input type="radio"/> 30 Meter |
| <input type="radio"/> 35 Meter | <input type="radio"/> 40 Meter | <input type="radio"/> 45 Meter |
| <input type="radio"/> 50 Meter | <input type="radio"/> 55 Meter | <input type="radio"/> 60 Meter |
| <input type="radio"/> 65 Meter | <input type="radio"/> 70 Meter | <input type="radio"/> 75 Meter |
| <input type="radio"/> 80 Meter | <input type="radio"/> 85 Meter | <input type="radio"/> 90 Meter |
| <input type="radio"/> 100 Meter | <input type="radio"/> 120 Meter | <input type="radio"/> 150 Meter |