

WELCOME

Congratulations! By Selecting YASI™ portable oral irrigator you are now on your way to better gum health, and a healthier smile!

With a clinically proven combination of water pressure and pulsations, the product removes harmful bacteria deep between teeth and below the gumline—where brushing alone won't reach.

Thank you for choosing YaSi™ portable oral irrigator.

Traditional Oral Care

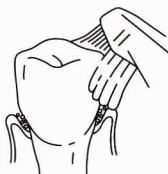

Traditional brushing can't easily reach hidden food debris and harmful bacteria.

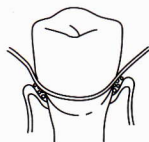

Flossing has limited access below the gumline.

Oral Care With The YASI™ Oral Irrigator

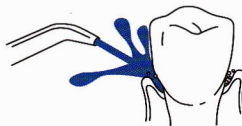

Oral Irrigator removes trapped food debris and harmful bacteria.

Important Safeguards.....	4
Product Description.....	6
Instructions for Use.....	7
Care and Cleaning.....	10
Troubleshooting Guide.....	11
Environmental Protection.....	12
Guarantee and Service.....	13

IMPORTANT SAFEGUARDS

Read this manual carefully before you use the appliance and save it for future reference.

DANGER:

To reduce the risk of electrocution:

- Do not let the power outlet and charger away from water.
- Do not handle charger with wet hands.
- Do not immerse in water or other liquids.
- Check the charger cord for damage before the first use and during the life of the product.
- Do not use while bathing.
- Do not place or store product over or near water contained in a bathtub, washbasin, etc.
- Make sure that the charger is completely dry before connected to the main power supply.

WARNING:

If you have had oral or dental surgery in the previous 2 months, consult your dentist before using this appliance.

- Do not plug this device into a voltage system that is different from the voltage system specified on the device or charger.
- Do not use this product if it has a damaged cord or plug, if it is not working properly, if it has been dropped or damaged, or fall into any liquid. Please contact your local distributor which can be found at www.china-yasi.com.
- Keep wires away from hot surfaces.
- Do not use this product, if the nozzle have lost.
- Closely instruct persons(including children) with reduced physical, sensory or mental capabilities, or lack of experience and knowledge, concerning the use of the appliance.
- Do not direct water under the tongue, into the ear, nose or other delicate areas. This product is capable of producing pressures that may cause serious damage in these areas.
- Do not fill the tank with water warmer than 40°C.
- Children should be supervised to ensure that they do not play with the appliance.

- Fill reservoir with water or other dental professional recommended solution only (i.e. mouthwash or prescribed solutions). Some antibacterial solutions could shorten the life of the product.
- People who experience tooth or gum pain may not be able to use this device and should consult their dentist.

SAVE THESE INSTRUCTIONS

- Do not press the nozzle too firmly against your teeth or gums. Doing so may injure you gums.

PRODUCT DESCRIPTION

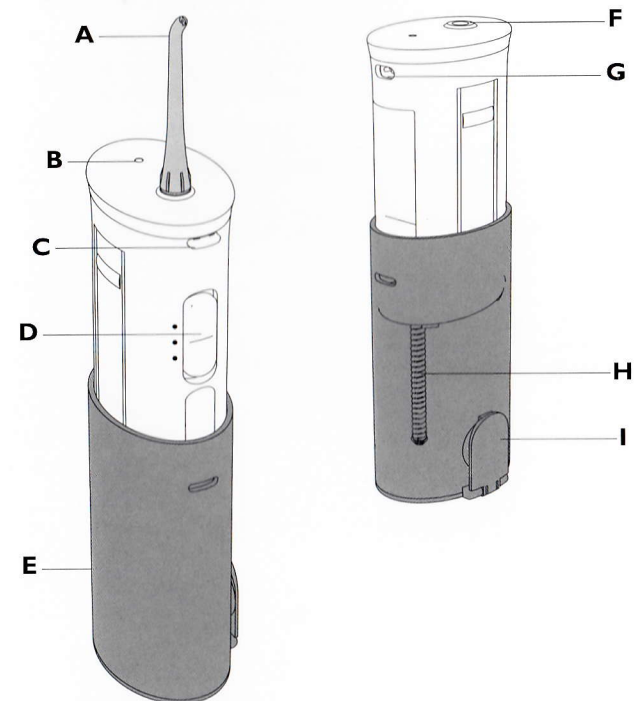

- A Nozzle
- B Charging indicator lamp
- C Nozzle release button
- D Switch
 - Normal
 - Soft
 - 0· CHARGE ... Off / Charge
- E Tank
- F Nozzle socket
- G Appliance socket
- H Water suction tube
- I Water supply cap

Specifications

Charging time: approx. 8 hours
 Rated voltage: 100-240V AC 50-60Hz
 Power adapt Output: DC 5V 500mA

Accessories

Replacement nozzle (2 included)
 USB Charging wire
 USB Charging adaptor (sold separately)

INSTRUCTIONS FOR USE

Charging the appliance

- Charge the appliance for 24 hours before first use.
- Charge the appliance at 15 to 35 °C room temperature.
- Usage time may be shorter when charging in lower temperatures (under 15 °C). Also, it may not charge in very low temperatures (under 0 °C).

1. Turn the switch to OFF.

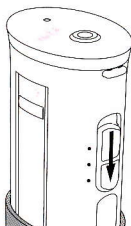

2. Store the main unit.

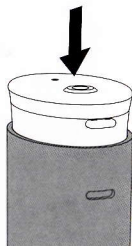

3. Insert the appliance plug securely into the appliance socket.
- Insert the appliance plug after wiping any water that may be on the socket.
 - Use three times before, please complete charge and discharge, to activate the battery.
 - If you do not use the appliance 3 months or more, be sure to charge it for 16 hours or more.
 - Charge the appliance only with the dedicated charging adaptor.
 - If the usage time gets short even if charged properly, it could be that the battery is worn out. (Expected life of the battery is 3 years, but it can change greatly depending on how it is used and stored)

INSTRUCTIONS FOR USE

Using the appliance

1. Open the water supply cap.

2. Pull out the main part up to the usage line (▼ mark)

- It may be hard to pull out the main part with the water supply cap closed.
- Water pressure will not rise unless the main part is pulled out to the usage line.

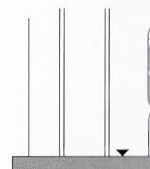

3. Insert the nozzle into the nozzle socket.

- Insert it securely until clicks.

4. Pour in water

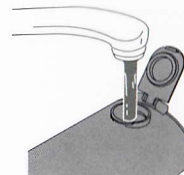

5. Close the water supply cap.

6. Place the nozzle in your mouth.

- The water suction tube inside the tank may come out from the water and the flow of water may stop when the appliance is tilted too much.

7 Turn the switch to ON.

- It can be used for approximately 50 seconds with a full tank.

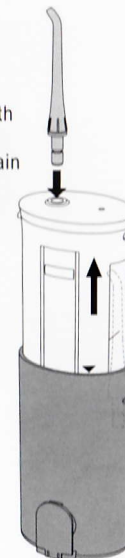

- Mode (strength) can be selected.
(Normal) For normal cleaning.
(Soft) When you are worried about your gums.
When you feel 2 (Normal) is too strong.

Tips

- Hold the appliance vertically with the nozzle upward.
- Move your face above the sink.
- Close your mouth slightly so the water will not splatter.
- Place the nozzle in your mouth.
- Direct the jet stream at a 90-degree angle to your gumline. Follow the gumline and pause briefly between teeth.
- Do not apply the stream directly into the periodontal pockets.

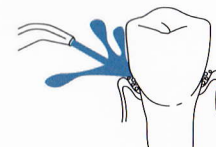

After use

There is a risk of bacteria propagating, so wash thoroughly and dry before storing.

1. Open the water supply cap and dispose of the water in the tank.

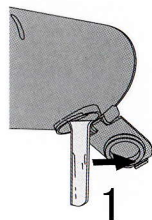

2. Turn the switch to ON, and drain the water inside the appliance.
 - Run the appliance for 2 to 3 seconds until no water comes out.

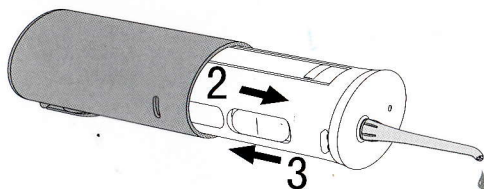

3. Turn the switch to OFF.

4. Press the nozzle release button, remove the nozzle and place it in the storage.

5. Store the main part.

6. Close the water supply cap.

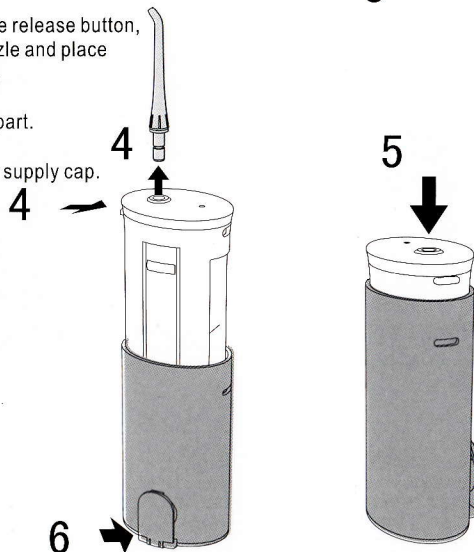

CARE AND CLEANING

Never immerse the unit in water. Wipe the exterior when necessary with a soft cloth and mild non-abrasive cleanser. Reservoir may be washed with soapy water or in top rack of dishwasher.

- Before cleaning, unplug from the electrical outlet.
- Before exposing the appliance to freezing temperatures, remove the tank and run the unit until completely empty.

1. **Nozzle** (Remove it while pressing the nozzle release button.)
Wash with water and wipe with a cloth.
 - Please replace the nozzle about once every 6 months. If the tip of nozzle gets deformed, please replace with a new nozzle. Failure to do so could result in malfunction.

2. The main part

Remove the dirt by wiping using a cloth with liquid soap, and wipe off using a dry cloth. Wash with water if it is very dirty.

- Do not wipe the appliance with thinners, benzene, alcohol etc.
- Do not wash using hot water of over 50 °C.
- Dry after washing with water.

3. Water suction tube

Wash with water and wipe with a cloth.

- Do not bend the water suction tube. Failure to do so could result in malfunction such disruption in the operation of the water suction tube.

4. Tank

It will come off when the body is pulled hard while the water supply cap is removed, so perform maintenance of interior as well. Wash with water and wipe with a cloth.

- Wash the dirt off from inside using a brush or similar, and wipe off with a cloth.
- Dry the tank when not using for a long period.

5. Water supply cap

Wipe off any grime and dirt.

- Failure to do so could result in water leakage.

6. Charging adaptor

Wipe the metal part of the power plug with a dry cloth once every 6 months.

Service Maintenance

The product have no consumer-serviceable electrical items and do not require routine service maintenance. For all your service needs, contact your local dealer. To locate your local distributor go to www.china-yasi.com.

Refer to the serial and model numbers in all correspondence.

These numbers are located on the bottom of the product.

TROUBLESHOOTING GUIDE

PROBLEM	CAUSE	CORRECTIVE ACTION
Leakage between the nozzle and the nozzle socket port Occurs between the leakage	Nozzle not fully engaged.	Remove the nozzle and reinstall.
Tank leaks.	1) Liquid was left in the tank. 2) Water supply cap is open.	1) Always empty the tank after use. 2) Close the water supply cap.
Inadequate pressure / No fluid flow.	1) Unit is upside down. 2) Insufficient liquid in the tank. 3) Reservoir connection clogged 4) The mode is "Soft". 5) There are some impurities at the in-out valve	1) Nozzle must be higher than the tank for correct water flow. 2) Fill with liquid. 3) Fill tank with warm water and one cap of vinegar. Run until empty. Rinse with full tank of water. 4) Adjust the mode to "Normal". 5) Inhale the nozzle to make it work well
The appliance does not charge.	1) Main power socket is not live. 2) Switch is in the "Normal/Soft" (ON) position during charge.	1) Turn ON the main power socket. 2) Turn switch to "0" (OFF) position for charging.
The appliance does not start.	Battery not charged.	Be sure the power socket is functioning; test with another appliance. Be sure charger pins are clean and unobstructed.

ENVIRONMENTAL PROTECTION

Remove the built-in rechargeable batteries before disposing of the appliance. Please make sure that the batteries are disposed of at an officially designated location if there is one. Do not dismantle or replace the batteries so that you can use the appliance again. This could cause a fire or an electric shock.

Perform steps ① to ⑥ and lift the batteries, and then remove them.

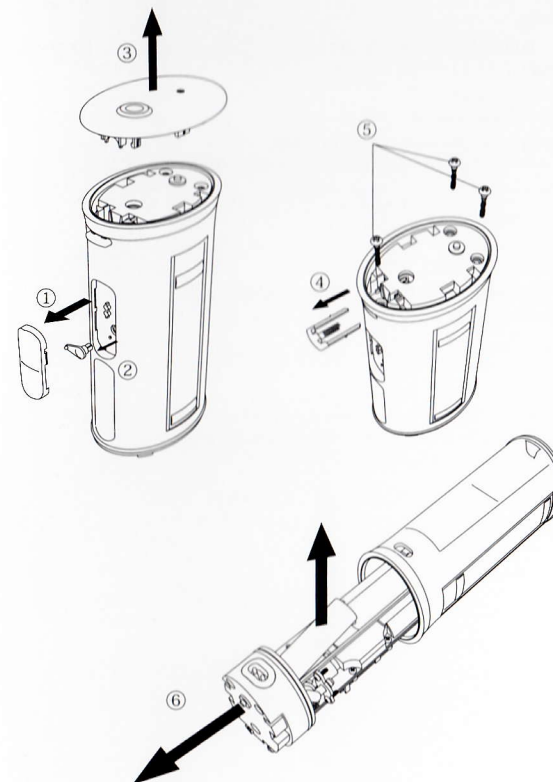

GUARANTEE AND SERVICE

Guarantee covers:

- Any defect in material or workmanship.

However, the responsibility for payment will not exceed the purchase price of the product.

Guarantee time:

- 1 year from the purchase date.

We provide after-sales service:

- One year warranty free warranty.

How do you get the service:

- Save your receipt as proof of date of sale.
- Contact the nearest distributor for assistance.
- Check our on-line service site at www.china-yasi.com for help.

Guarantee restrictions:

- Damage from misuse, abuse or neglect.
- Damage from commercial use.
- Product that have been modified in any way.
- Shipping and handling costs associated with the replacement of the unit
- Consequential or incidental damages.